

SITE CODE: <b>MZ</b>	DATE OPENED: 29 June	SU No: 19005	MARZUOLO ARCHAEOLOGICAL PROJECT 
	DATE CLOSED: 18 July	AREA No: 19000	
INITIAL: AK			

FORMATION PROCESS:	DEFINITION: wall running EW to the north of 19003 15 of 19007
ANTHROPIC <input checked="" type="checkbox"/> NATURAL <input type="checkbox"/>	SU TYPE: <input type="checkbox"/> DEPOSIT <input type="checkbox"/> CUT <input checked="" type="checkbox"/> STRUCTURAL
DISTINGUISHED BY: <input type="checkbox"/> COLOUR <input type="checkbox"/> COMPACTION <input type="checkbox"/> COMPOSITION	

<b>DEPOSIT:</b> 1. Composition (sand/silt/clay) 2. Compaction 3. Colour 4. Clarity of Limits (clear/not clear/exc. lim. for N/S/W/E/depth) 5. Dimensions 6. Method & Conditions	<b>STRUCTURAL:</b> 1. Type (wall, cistern, etc.) 2. Orientation 3. Technique (pisé, ashlar, etc.) 4. Bonding Material 5. # of Coursings 6. Facing/Finish (plaster, etc.) 7. Dimensions 8. Related architectural features	<b>DESCRIPTION:</b> ① wall ② EW ③ OPUS RETICULATUM ④ Grey mortar ⑤ 1 course, not in the complete extension ⑥ NO  ⑦ 5.2 m x 0.56 m ⑧ 19006 - 19009 - 19008
<b>CUT:</b> 1. Shape in Plan 2. Top - BOS 3. Base - BOS 4. Sides 5. Orientation 6. Dimensions		

**OTHER OBSERVATIONS/COMMENTS:**

The depth in trench 2 is cm 90  
 It is impossible to recognize the cut of the foundation trench of walls 19005 and 19006. In order to follow the right relationship between the walls and the layers in which these two walls are built we say that 19005 and 19006 cover 19018 - 19019 - 19022 - 19026 - 19027 - 19032

**MATRIX:**

		19004	19009	19037
		19005	This context	

<b>STRATIGRAPHIC RELATIONSHIPS:</b>	<b>FILLS:</b>
CUT:	BUTTED BY: 19009 - 19037-1
CUT BY:	COVERS: 19018 - 19019 - 19022 - 19026 - 19027 - 19032
ABUTS:	COVERED BY: 19004
	BINDS TO: 19006 - 19008

**ENVIRONMENTAL SAMPLES TAKEN:**  POLLEN  SOIL  CHARCOAL  OTHER  
 (specify): \_\_\_\_\_

SPECIAL FINDS N<sup>o</sup>s:

INCLUSIONS: (check all that apply): MORTAR:  F  M  R BONE:  F  M  R BRICK/TILE:  F  M  R  
 METAL:  F  M  R SLAG:  F  M  R CHARC.:  F  M  R WRKD STONE:  F  M  R  
 DAUB:  F  M  R GLASS:  F  M  R POTTERY:  F  M  R UNWRKD STONE:  F  M  R  
 OTHER:

PHOTO N<sup>o</sup>s 100-8644, 100-8645, 100-1015, 100-1016 PHOTO MODEL N<sup>o</sup>s

SKETCH OF PLAN INCLUDE: 1. North arrow; 2. Dimensions; 3. Sample locations (if relevant); 4. Levels; 5. Grid pts (if relevant); 6. Rise/Drop in surface level; 7. Abutting architecture/Adjacent or relevant nearby features for reference; 8. All SU N<sup>o</sup>s

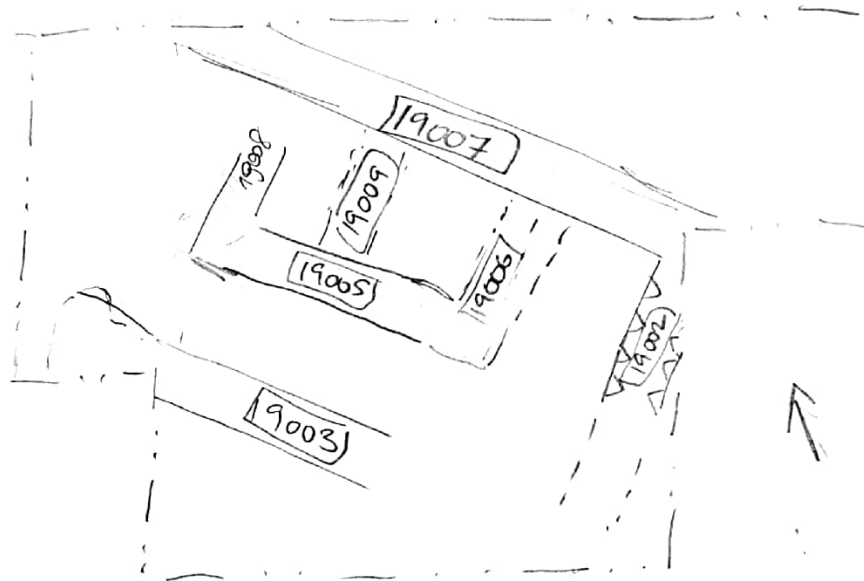

FIELD NOTEBOOK DRAWINGS - PAGE N <sup>o</sup> s	SECTION DRAWING N <sup>o</sup> s					APPROX. DATE OF LAYER	DATABLE MATERIALS
	HIGH				LOW		
STRATIGRAPHIC RELIABILITY	5	4	3	2	1		
CONFIDENCE IN INTERPRETATION	5	4	3	2	1		
CONTAMINATION RISK	5	4	3	2	1		

INTERPRETATION:  
 Foundation wall with only few cubilia of the first course

ENTERED INTO DATABASE INITIALS: NA DATE: 21 July 2018