

|                                    |                             |                       |  |
|------------------------------------|-----------------------------|-----------------------|--|
| <b>SITE CODE:</b><br><br><b>MZ</b> | <b>DATE OPENED:</b> 29 Jun  | <b>SU No:</b> 19006   | <b>MARZUOLO<br/>ARCHAEOLOGICAL<br/>PROJECT</b>  |
|                                    | <b>DATE CLOSED:</b> 18 July |                       |  |
|                                    | <b>INITIAL:</b> AK          | <b>AREA No:</b> 19000 |  |

|   |   |
|---|---|
| <b>FORMATION PROCESS:</b><br><br>ANTHROPIC <input checked="" type="checkbox"/> NATURAL <input type="checkbox"/> | <b>DEFINITION:</b> wall running NE-SW, perpendicular to and part of the same structure as 19005                                   |
|   | <b>SU TYPE:</b> <input type="checkbox"/> DEPOSIT <input type="checkbox"/> CUT <input checked="" type="checkbox"/> STRUCTURAL      |
|   | <b>DISTINGUISHED BY:</b> <input type="checkbox"/> COLOUR <input type="checkbox"/> COMPACTION <input type="checkbox"/> COMPOSITION |

|   |  |  |
|---|--|--|
| <b>DEPOSIT:</b><br>1. Composition (sand/silt/clay)<br>2. Compaction<br>3. Colour<br>4. Clarity of Limits (clear/not clear/exc. lim. for N/S/W/E/depth)<br>5. Dimensions<br>6. Method & Conditions | <b>STRUCTURAL:</b><br>1. Type (wall, cistern, etc.)<br>2. Orientation<br>3. Technique (pisé, ashlar, etc.)<br>4. Bonding Material<br>5. # of Coursings<br>6. Facing/Finish (plaster, etc.)<br>7. Dimensions<br>8. Related architectural features | <b>DESCRIPTION:</b><br>① Wall<br>② NS<br>③ Rounded stones - foundation<br>④ Grey mortar<br>⑤ NA<br>⑥ 1.9m x 0.53m<br>⑦ 19005 - 19035 |
|---|--|--|

**OTHER OBSERVATIONS/COMMENTS:**  
 The depth in Trench 2 is cm. 90  
 It is ruined but after a gap it continues with number 19035  
 SEE OBSERVATIONS IN 19005

**MATRIX:**

|                          |                          |       |                          |                          |
|--------------------------|--------------------------|-------|--------------------------|--------------------------|
| <input type="checkbox"/> | <input type="checkbox"/> | 19004 | 19037                    | <input type="checkbox"/> |
|                          |                          | 19006 | This context             |                          |
| <input type="checkbox"/> | <input type="checkbox"/> | 19018 | <input type="checkbox"/> | <input type="checkbox"/> |

|                                     |   |                           |
|-------------------------------------|---|---------------------------|
| <b>STRATIGRAPHIC RELATIONSHIPS:</b> |   | <b>FILLS:</b>             |
| <b>CUT:</b>                         | <b>BUTTED BY:</b><br>19037-19018                | <b>FILLED BY:</b>         |
| <b>CUT BY:</b>                      | <b>COVERS:</b><br>19018-19019-19022-19026-19027 | <b>EQUAL TO:</b>          |
| <b>ABUTS:</b>                       | <b>COVERED BY:</b><br>19004                     | <b>BINDS TO:</b><br>19005 |

**ENVIRONMENTAL SAMPLES TAKEN:**  POLLEN  SOIL  CHARCOAL  OTHER  
 (specify): \_\_\_\_\_

\* 19032

**SPECIAL FINDS N°s:**

**INCLUSIONS:** (check all that apply):  
 MORTAR:  F  M  R    BONE:  F  M  R    BRICK/TILE:  F  M  R  
 METAL:  F  M  R    SLAG:  F  M  R    CHARC.:  F  M  R    WRKD STONE:  F  M  R  
 DAUB:  F  M  R    GLASS:  F  M  R    POTTERY:  F  M  R    UNWRKD STONE:  F  M  R  
 OTHER:

**PHOTO N°s** 100-8644, 100-8645, 100-1016, 100-1017    **PHOTO MODEL N°s**

**SKETCH OF PLAN** **INCLUDE:** 1. North arrow; 2. Dimensions; 3. Sample locations (if relevant); 4. Levels; 5. Grid pts (if relevant); 6. Rise/Drop in surface level; 7. Abutting architecture/Adjacent or relevant nearby features for reference; 8. All SU N°s

SEE SKETCH  
IN SU 19003

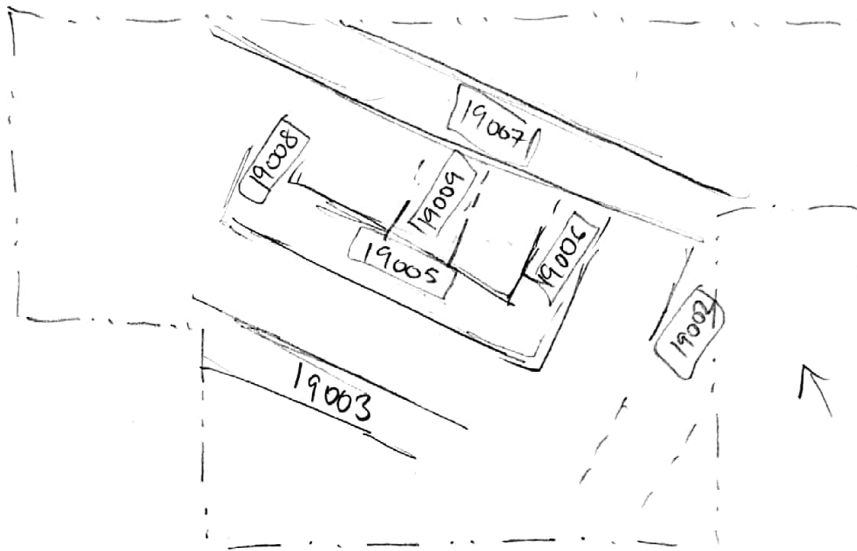

| FIELD NOTEBOOK DRAWINGS - PAGE N°s |      |   |     |   |   | SECTION DRAWING N°s   |                   |
|------------------------------------|------|---|-----|---|---|-----------------------|-------------------|
|                                    | HIGH |   | LOW |   |   | APPROX. DATE OF LAYER | DATABLE MATERIALS |
| STRATIGRAPHIC RELIABILITY          | 5    | 4 | 3   | 2 | 1 |                       |                   |
| CONFIDENCE IN INTERPRETATION       | 5    | 4 | 3   | 2 | 1 |                       |                   |
| CONTAMINATION RISK                 | 5    | 4 | 3   | 2 | 1 |                       |                   |

**INTERPRETATION:**  
Foundation wall that binds with OPUS RETICULATUM

**ENTERED INTO DATABASE**    **INITIALS:** NA    **DATE:** 21 July 2018