

SITE CODE: MZ	DATE OPENED: 29 June	SU No: 19007	MARZUOLO ARCHAEOLOGICAL PROJECT 
	DATE CLOSED: 18 July	AREA No: 19000	
	INITIAL: AK		

FORMATION PROCESS:	DEFINITION: wall running SE-NW, continuation of 17018
ANTHROPIC <input checked="" type="checkbox"/> NATURAL <input type="checkbox"/>	SU TYPE: <input type="checkbox"/> DEPOSIT <input type="checkbox"/> CUT <input checked="" type="checkbox"/> STRUCTURAL
	DISTINGUISHED BY: <input type="checkbox"/> COLOUR <input type="checkbox"/> COMPACTION <input type="checkbox"/> COMPOSITION

DEPOSIT: 1. Composition (sand/silt/clay) 2. Compaction 3. Colour 4. Clarity of Limits (clear/not clear/exc. lim. for N/S/W/E/depth) 5. Dimensions 6. Method & Conditions	STRUCTURAL: 1. Type (wall, cistern, etc.) 2. Orientation 3. Technique (pisé, ashlar, etc.) 4. Bonding Material 5. # of Coursings 6. Facing/Finish (plaster, etc.) 7. Dimensions 8. Related architectural features	DESCRIPTION: ① Wall ② EW ③ Rounded stones ④ Grey mortar ⑤ NA ⑦ 7.8m x 0.54m ⑧ 19002 - 19008 - 17018
---	--	---

OTHER OBSERVATIONS/COMMENTS:
 We didn't arrive at the bottom of this foundation wall because already investigated in face s during excavation campaign 2017

MATRIX:

		19004	19037	19010	19017 - 19021
		19007	This context		

STRATIGRAPHIC RELATIONSHIPS:	FILLS:
CUT:	BUTTED BY: 19037 - 19010 - 19017 19021 - 19021
CUT BY:	COVERS:
ABUTS:	COVERED BY: 19004
	EQUAL TO: 17018
	BINDS TO:

ENVIRONMENTAL SAMPLES TAKEN: POLLEN SOIL CHARCOAL OTHER
 (specify): _____

SPECIAL FINDS N°s:

INCLUSIONS: (check all that apply):
 MORTAR: F M R BONE: F M R BRICK/TILE: F M R
 METAL: F M R SLAG: F M R CHARC.: F M R WRKD STONE: F M R
 DAUB: F M R GLASS: F M R POTTERY: F M R UNWRKD STONE: F M R
 OTHER:

PHOTO N°s 100-9644, 100-8645, 100-1020 **PHOTO MODEL N°s**

SKETCH OF PLAN **INCLUDE:** 1. North arrow; 2. Dimensions; 3. Sample locations (if relevant); 4. Levels; 5. Grid pts (if relevant); 6. Rise/Drop in surface level; 7. Abutting architecture/Adjacent or relevant nearby features for reference; 8. All SU N°s

SEE SKETCH
SU 19003

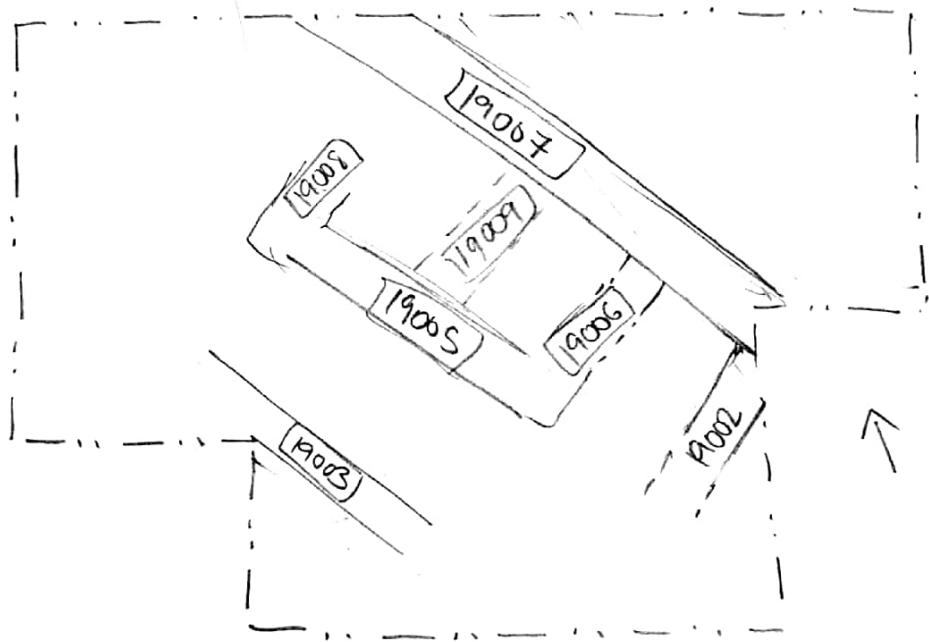

FIELD NOTEBOOK DRAWINGS - PAGE N°s						SECTION DRAWING N°s	
	HIGH		LOW			APPROX. DATE OF LAYER	DATABLE MATERIALS
STRATIGRAPHIC RELIABILITY	5	4	3	2	1		
CONFIDENCE IN INTERPRETATION	5	4	3	2	1		
CONTAMINATION RISK	5	4	3	2	1		

INTERPRETATION:

ENTERED INTO DATABASE INITIALS: na DATE: 21 July 2011