

SITE CODE: MZ	DATE OPENED: 2 July	SU N ^o : 19010	MARZUOLO ARCHAEOLOGICAL PROJECT 
	DATE CLOSED: 4 JULY	AREA N ^o : 19000 TR1	
	INITIAL: AIC (TK closed)		

FORMATION PROCESS:	DEFINITION: tile collapse? below 19004
ANTHROPIC <input checked="" type="checkbox"/> NATURAL <input type="checkbox"/>	SU TYPE: <input checked="" type="checkbox"/> DEPOSIT <input type="checkbox"/> CUT <input type="checkbox"/> STRUCTURAL
	DISTINGUISHED BY: <input checked="" type="checkbox"/> COLOUR <input type="checkbox"/> COMPACTION <input checked="" type="checkbox"/> COMPOSITION

DEPOSIT: 1. Composition (sand/silt/clay) 2. Compaction 3. Colour 4. Clarity of Limits (clear/not clear/exc. lim. for N/S/W/E/depth) 5. Dimensions 6. Method & Conditions	STRUCTURAL: 1. Type (wall, cistern, etc.) 2. Orientation 3. Technique (pisé, ashlar, etc.) 4. Bonding Material 5. # of Coursings 6. Facing/Finish (plaster, etc.) 7. Dimensions 8. Related architectural features	DESCRIPTION: 1. Dry silty clay, east side looser and less dry, possibly due to tree roots in this sector 2. Compact, looser in sections with many tiles 3. Brown with orange patches, not uniform 4. Extends to edge of trench, terminates at 17018 on the south face. Gradual reduction of tiles before clear termination at 19017 5. Roughly 2 x 2.25m 6. Dry and sunny day one, overcast and humid day two and three
---	--	--

OTHER OBSERVATIONS/COMMENTS:
 ARTIFICIAL DEPOSIT of broken tiles and some bricks. Some sigillata found, including several large pieces. Infrequent mortar patches of varying size.

MATRIX:

		19004		
		19010	This context	
		19017	19007	

STRATIGRAPHIC RELATIONSHIPS:		FILLS:
CUT:	BUTTED BY:	FILLED BY:
CUT BY:	COVERS: 19017	EQUAL TO:
ABUTS: 19007	COVERED BY: 19004	BINDS TO:

ENVIRONMENTAL SAMPLES TAKEN: POLLEN SOIL CHARCOAL OTHER
 (specify): _____

SPECIAL FINDS N°s: 19-92

INCLUSIONS: (check all that apply):
 MORTAR: F M R
 METAL: F M R
 DAUB: F M R
 OTHER:
 BONE: F M R
 SLAG: F M R
 GLASS: F M R
 POTTERY: F M R
 BRICK/TILE: F M R
 WRKD STONE: F M R
 UNWRKD STONE: F M R

PHOTO N°s 186-47, 186-48 **PHOTO MODEL N°s**

SKETCH OF PLAN **INCLUDE:** 1. North arrow; 2. Dimensions; 3. Sample locations (if relevant); 4. Levels; 5. Grid pts (if relevant); 6. Rise/Drop in surface level; 7. Abutting architecture/Adjacent or relevant nearby features for reference; 8. All SU N°s

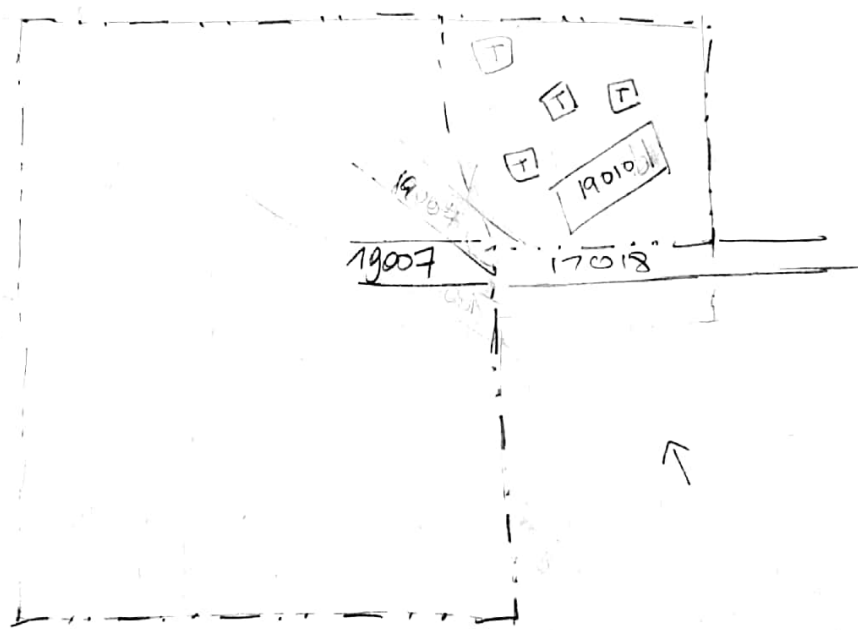

FIELD NOTEBOOK DRAWINGS - PAGE N°s	SECTION DRAWING N°s							
	STRATIGRAPHIC RELIABILITY	HIGH	5	4	3	2	1	LOW
CONFIDENCE IN INTERPRETATION	5	4	3	2	1			DATABLE MATERIALS
CONTAMINATION RISK	5	4	3	2	1			

INTERPRETATION:
 Roof tiles from building, probably not in situ but a later (secondary) deposition.
 (19010, 19011) ...

ENTERED INTO DATABASE INITIALS: TCH DATE: July 18, 2018