

<b>SITE CODE:</b>  <b>MZ</b>	<b>DATE OPENED:</b> 3 July	<b>SU No:</b> 19014	<b>MARZUOLO ARCHAEOLOGICAL PROJECT</b> 
	<b>DATE CLOSED:</b> 18 July		
	<b>INITIAL:</b> AK	<b>AREA No:</b> 19000	

<b>FORMATION PROCESS:</b>  ANTHROPIC <input checked="" type="checkbox"/> NATURAL <input type="checkbox"/>	<b>DEFINITION:</b> Western pillar on northern edge of trench 1
	<b>SU TYPE:</b> <input type="checkbox"/> DEPOSIT <input type="checkbox"/> CUT <input checked="" type="checkbox"/> STRUCTURAL
	<b>DISTINGUISHED BY:</b> <input type="checkbox"/> COLOUR <input type="checkbox"/> COMPACTION <input type="checkbox"/> COMPOSITION

<b>DEPOSIT:</b> 1. Composition (sand/silt/clay) 2. Compaction 3. Colour 4. Clarity of Limits (clear/not clear/exc. lim. for N/S/W/E/depth) 5. Dimensions 6. Method & Conditions	<b>STRUCTURAL:</b> 1. Type (wall, cistern, etc.) 2. Orientation 3. Technique (pisé, ashlar, etc.) 4. Bonding Material 5. # of Coursings 6. Facing/Finish (plaster, etc.) 7. Dimensions 8. Related architectural features	<b>DESCRIPTION:</b> ① Pillar ② NS ③ Rounded stones and tiles ④ Gray mortar ⑤ NA ⑥ NA ⑦ cm 50 x cm 50 ⑧ 19015
---	--	--

**OTHER OBSERVATIONS/COMMENTS:**

UNEXCAVATED

**MATRIX:**

		19004		
		19014	This context	

<b>STRATIGRAPHIC RELATIONSHIPS:</b>		<b>FILLS:</b>
<b>CUT:</b>	<b>BUTTED BY:</b>	<b>FILLED BY:</b>
<b>CUT BY:</b>	<b>COVERS:</b>	<b>EQUAL TO:</b>
<b>ABUTS:</b>	<b>COVERED BY:</b> 19004	<b>BINDS TO:</b>

**ENVIRONMENTAL SAMPLES TAKEN:**  POLLEN  SOIL  CHARCOAL  OTHER  
(specify): \_\_\_\_\_

**SPECIAL FINDS N°s:**

**INCLUSIONS:** (check all that apply):  
 METAL:  F  M  R  
 DAUB:  F  M  R  
 OTHER:  
 MORTAR:  F  M  R  
 SLAG:  F  M  R  
 GLASS:  F  M  R  
 BONE:  F  M  R  
 CHARC.:  F  M  R  
 POTTERY:  F  M  R  
 BRICK/TILE:  F  M  R  
 WRKD STONE:  F  M  R  
 UNWRKD STONE:  F  M  R

**PHOTO N°s** 100-8668, 8669, 100-1007 **PHOTO MODEL N°s**

**SKETCH OF PLAN** **INCLUDE:** 1. North arrow; 2. Dimensions; 3. Sample locations (if relevant); 4. Levels; 5. Grid pts (if relevant); 6. Rise/Drop in surface level; 7. Abutting architecture/Adjacent or relevant nearby features for reference; 8. All SU N°s

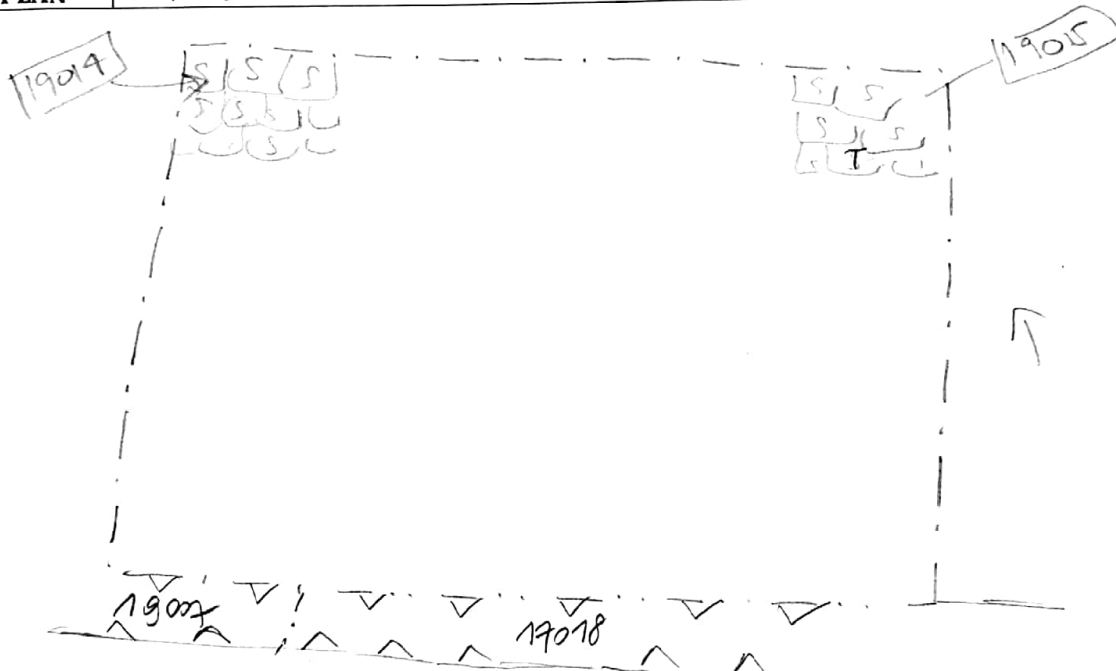

FIELD NOTEBOOK DRAWINGS - PAGE N°s	SECTION DRAWING N°s					APPROX. DATE OF LAYER	DATABLE MATERIALS
	HIGH	LOW					
STRATIGRAPHIC RELIABILITY	(5)	4	3	2	1		
CONFIDENCE IN INTERPRETATION	(5)	4	3	2	1		
CONTAMINATION RISK	5	4	(3)	2	1		

**INTERPRETATION:**  
SEE 19015

**ENTERED INTO DATABASE** **INITIALS:** HA **DATE:** 21 July 2018