

SITE CODE: <b>MZ</b>	DATE OPENED: 3 July	SU No: 19016	MARZUOLO ARCHAEOLOGICAL PROJECT 
	DATE CLOSED: 3 July	AREA No: 19000	
	INITIAL:		

FORMATION PROCESS:	DEFINITION: <i>Brown deposit of soil with stones</i>
ANTHROPIC <input type="checkbox"/> NATURAL <input checked="" type="checkbox"/>	SU TYPE: <input checked="" type="checkbox"/> DEPOSIT <input type="checkbox"/> CUT <input type="checkbox"/> STRUCTURAL
	DISTINGUISHED BY: <input type="checkbox"/> COLOUR <input type="checkbox"/> COMPACTION <input type="checkbox"/> COMPOSITION

<b>DEPOSIT:</b> 1. Composition (sand/silt/clay) 2. Compaction 3. Colour 4. Clarity of Limits (clear/not clear/exc. lim. for N/S/W/E/depth) 5. Dimensions 6. Method & Conditions	<b>STRUCTURAL:</b> 1. Type (wall, cistern, etc.) 2. Orientation 3. Technique (pisé, ashlar, etc.) 4. Bonding Material 5. # of Coursings 6. Facing/Finish (plaster, etc.) 7. Dimensions 8. Related architectural features	<b>DESCRIPTION:</b>  <i>UNEXCAVATED</i>
---	--	---

OTHER OBSERVATIONS/COMMENTS:  
*Site unexcavated*

MATRIX:

		19004		
		19016	This context	
		19003		

STRATIGRAPHIC RELATIONSHIPS:		FILLS:
CUT:	BUTTED BY:	FILLED BY:
CUT BY:	COVERS:	EQUAL TO:
ABUTS: 19003	COVERED BY: 19004	BINDS TO:

ENVIRONMENTAL SAMPLES TAKEN:  POLLEN  SOIL  CHARCOAL  OTHER  
(specify): \_\_\_\_\_

**SPECIAL FINDS N°s:**

**INCLUSIONS:** (check all that apply):  
 MORTAR:  F  M  R    BONE:  F  M  R    BRICK/TILE:  F  M  R  
 METAL:  F  M  R    SLAG:  F  M  R    CHARC.:  F  M  R    WRKD STONE:  F  M  R  
 DAUB:  F  M  R    GLASS:  F  M  R    POTTERY:  F  M  R    UNWRKD STONE:  F  M  R  
 OTHER:

**PHOTO N°s** 186-52      **PHOTO MODEL N°s**

**SKETCH OF PLAN** INCLUDE: 1. North arrow; 2. Dimensions; 3. Sample locations (if relevant); 4. Levels; 5. Grid pts (if relevant); 6. Rise/Drop in surface level; 7. Abutting architecture/Adjacent or relevant nearby features for reference; 8. All SU N°s

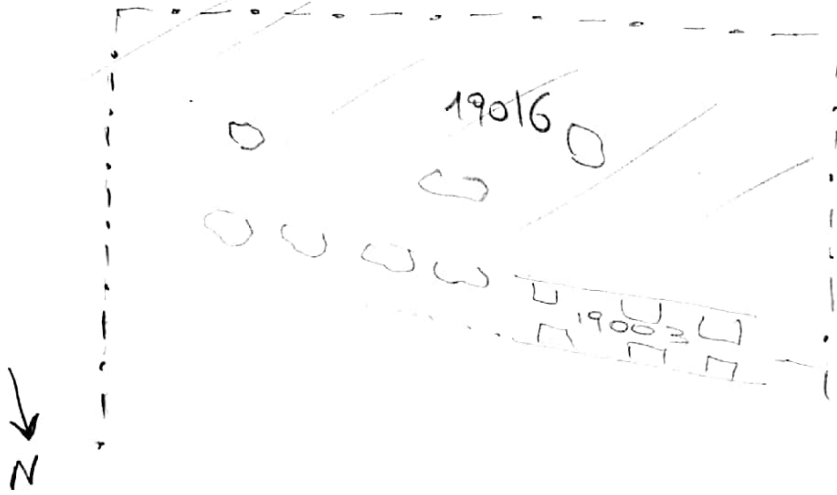

FIELD NOTEBOOK DRAWINGS - PAGE N°s						SECTION DRAWING N°s	
	HIGH		LOW			APPROX. DATE OF LAYER	DATABLE MATERIALS
STRATIGRAPHIC RELIABILITY	5	4	(3)	2	1		
CONFIDENCE IN INTERPRETATION	5	4	(3)	2	1		
CONTAMINATION RISK	5	4	(3)	2	1		

INTERPRETATION:

UNEXCAVATED

ENTERED INTO DATABASE    INITIALS: TCH    DATE: July 18, 2018