

SITE CODE: MZ	DATE OPENED: July 9 2018	SU No: Trench 2 19022	MARZUOLO ARCHAEOLOGICAL PROJECT 
	DATE CLOSED: July 9 2018	AREA No: 19000, r2	
	INITIAL: MH		

FORMATION PROCESS: ANTHROPIC <input type="checkbox"/> NATURAL <input checked="" type="checkbox"/>	DEFINITION: deposit @ bottom of 1920; grayish clay
	SU TYPE: <input checked="" type="checkbox"/> DEPOSIT <input type="checkbox"/> CUT <input type="checkbox"/> STRUCTURAL
	DISTINGUISHED BY: <input type="checkbox"/> COLOUR <input type="checkbox"/> COMPACTION <input type="checkbox"/> COMPOSITION

DEPOSIT: 1. Composition (sand/silt/clay) 2. Compaction 3. Colour 4. Clarity of Limits (clear/not clear/exc. lim. for N/S/W/E/depth) 5. Dimensions 6. Method & Conditions	STRUCTURAL: 1. Type (wall, cistern, etc.) 2. Orientation 3. Technique (pisé, ashlar, etc.) 4. Bonding Material 5. # of Coursings 6. Facing/Finish (plaster, etc.) 7. Dimensions 8. Related architectural features	DESCRIPTION: 1. clay 2. high - very hard 3. gray; brownish tint 4. clear - abuts 3/10/14 5. c. 60x20cm 6. pick ax, shovel; sunny
CUT: 1. Shape in Plan 2. Top - BOS 3. Base - BOS 4. Sides 5. Orientation 6. Dimensions		

OTHER OBSERVATIONS/COMMENTS:
 - interface layer between 19019 and 19026 (chocolate brown layer)
 - very few inclusions + finds - mostly empty

MATRIX:

	19019	19020		
		19022	This context	
		19026		

STRATIGRAPHIC RELATIONSHIPS:		FILLS:
CUT:	BUTTED BY:	FILLED BY:
CUT BY:	COVERS:	EQUAL TO:
ABUTS: 19006, 19005, 19009	COVERED BY: 19019, 19020	BINDS TO:

ENVIRONMENTAL SAMPLES TAKEN: POLLEN SOIL CHARCOAL OTHER
 (specify): _____

SPECIAL FINDS N^os: *N/A*

INCLUSIONS: (check all that apply):
 MORTAR: F M R
 BONE: F M R
 BRICK/TILE: F M R
 METAL: F M R
 SLAG: F M R
 CHARC.: F M R
 WRKD STONE: F M R
 DAUB: F M R
 GLASS: F M R
 POTTERY: F M R
 UNWRKD STONE: F M R
 OTHER:

PHOTO N^os: *100-8693; 100-8692* PHOTO MODEL N^os

SKETCH OF PLAN INCLUDE: 1. North arrow; 2. Dimensions; 3. Sample locations (if relevant); 4. Levels; 5. Grid pts (if relevant); 6. Rise/Drop in surface level; 7. Abutting architecture/Adjacent or relevant nearby features for reference; 8. All SU N^os

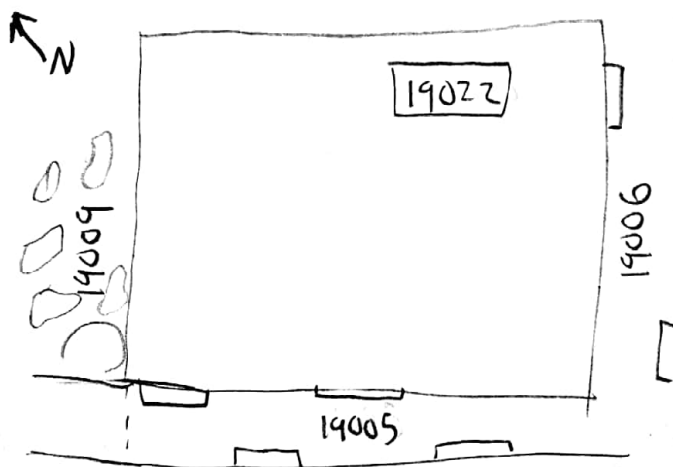

FIELD NOTEBOOK DRAWINGS - PAGE N ^o s	SECTION DRAWING N ^o s					APPROX. DATE OF LAYER
	HIGH				LOW	
STRATIGRAPHIC RELIABILITY	(5)	4	3	2	1	DATABLE MATERIALS
CONFIDENCE IN INTERPRETATION	5	(4)	3	2	1	
CONTAMINATION RISK	5	4	(3)	2	1	

INTERPRETATION:
Fill at the level of the foundation of the wall

ENTERED INTO DATABASE INITIALS: *na* DATE: *21 July 2012*