

SITE CODE: MZ	DATE OPENED: 9 July 2018	SU No: 19025	MARZUOLO ARCHAEOLOGICAL PROJECT 
	DATE CLOSED: 18 July		
	INITIAL: ARS	AREA No: 19000 (TR 1)	

FORMATION PROCESS: ANTHROPIC <input checked="" type="checkbox"/> NATURAL <input type="checkbox"/>	DEFINITION: North wall of drain
	SU TYPE: <input type="checkbox"/> DEPOSIT <input type="checkbox"/> CUT <input checked="" type="checkbox"/> STRUCTURAL
	DISTINGUISHED BY: <input type="checkbox"/> COLOUR <input type="checkbox"/> COMPACTION <input checked="" type="checkbox"/> COMPOSITION

DEPOSIT: 1. Composition (sand/silt/clay) 2. Compaction 3. Colour 4. Clarity of Limits (clear/not clear/exc. lim. for N/S/W/E/depth) 5. Dimensions 6. Method & Conditions	STRUCTURAL: 1. Type (wall, cistern, etc.) 2. Orientation 3. Technique (pisé, ashlar, etc.) 4. Bonding Material 5. # of Coursings 6. Facing/Finish (plaster, etc.) 7. Dimensions 8. Related architectural features	DESCRIPTION: 1. Wall 2. NW-SE 3. Rounded and worked stones 4. Gray mortar 5. 5 6. masonry (reconstruction in "cavo arcuato") 7. 1.62m x 0.32cm 8. Tiles believed to cover over 19030, forming a drain spanning Uws 19025 and 19028
---	--	---

OTHER OBSERVATIONS/COMMENTS:
 Discovered during excavation of fill 19023 and cut 19024

MATRIX:

		19023	19029	19030
		19025	This context	
		19024		

STRATIGRAPHIC RELATIONSHIPS:		FILLS:
CUT:	BUTTED BY: 19029, 19030	FILLED BY:
CUT BY:	COVERS: 19024	EQUAL TO:
ABUTS:	COVERED BY: 19023	BINDS TO:

ENVIRONMENTAL SAMPLES TAKEN: POLLEN SOIL CHARCOAL OTHER
 (specify): _____

SPECIAL FINDS N^os:

INCLUSIONS: (check all that apply): MORTAR: F M R BONE: F M R BRICK/TILE: F M R
 METAL: F M R SLAG: F M R CHARC.: F M R WRKD STONE: F M R
 DAUB: F M R GLASS: F M R POTTERY: F M R UNWRKD STONE: F M R
 OTHER:

PHOTO N^os: 100-8705, 8707, 8708 PHOTO MODEL N^os: 100-1024

SKETCH OF PLAN INCLUDE: 1. North arrow; 2. Dimensions; 3. Sample locations (if relevant); 4. Levels; 5. Grid pts (if relevant); 6. Rise/Drop in surface level; 7. Abutting architecture/Adjacent or relevant nearby features for reference; 8. All SU N^os

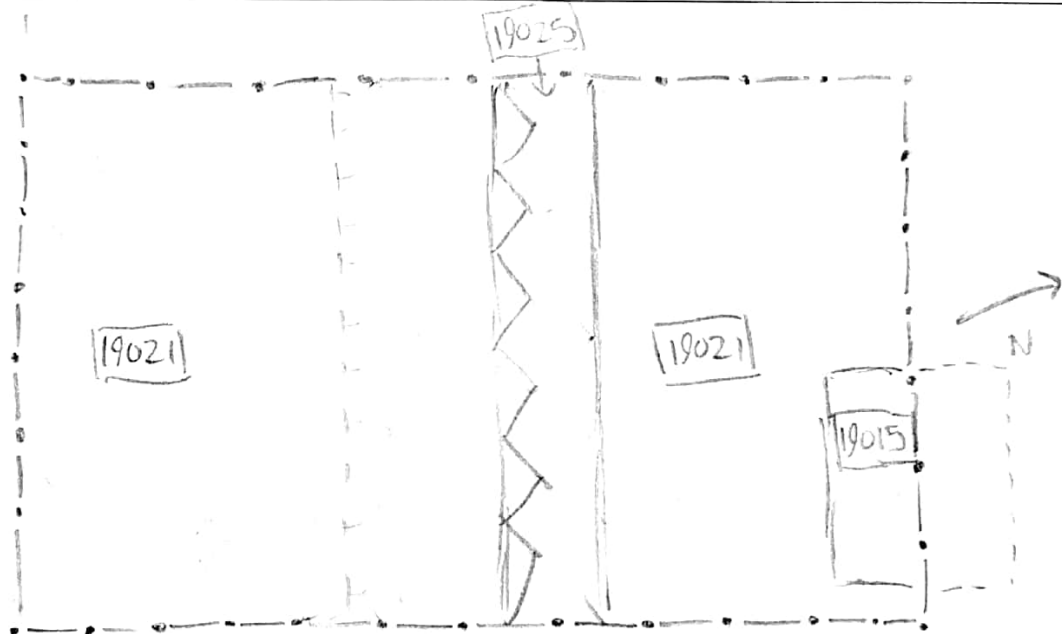

FIELD NOTEBOOK DRAWINGS - PAGE N ^o s	SECTION DRAWING N ^o s				
	HIGH			LOW	
STRATIGRAPHIC RELIABILITY	5	4	3	2	1
CONFIDENCE IN INTERPRETATION	5	4	3	2	1
CONTAMINATION RISK	5	4	3	2	1

INTERPRETATION:

Interpreted as the well for a drain consisting of the two walls 19025 and 19028 and covered over w/ the tiles and flat sided stones found in 19029 and 19030

ENTERED INTO DATABASE INITIALS: *na* DATE: 21 July 2008