

SITE CODE: MZ	DATE OPENED: July 9 2018	SU No: 19026	MARZUOLO ARCHAEOLOGICAL PROJECT
	DATE CLOSED: July 10 2018	AREA No: 19000	
	INITIAL: MSH	(Trench) 19000	

FORMATION PROCESS:	DEFINITION: Soft, chocolate brown deposit
ANTHROPIC <input type="checkbox"/> NATURAL <input checked="" type="checkbox"/>	SU TYPE: <input checked="" type="checkbox"/> DEPOSIT <input type="checkbox"/> CUT <input type="checkbox"/> STRUCTURAL
	DISTINGUISHED BY: <input checked="" type="checkbox"/> COLOUR <input checked="" type="checkbox"/> COMPACTION <input checked="" type="checkbox"/> COMPOSITION

DEPOSIT:	STRUCTURAL:	DESCRIPTION:
<ol style="list-style-type: none"> Composition (sand/silt/clay) Compaction Colour Clarity of Limits (clear/not clear/exc. lim. for N/S/W/E/depth) Dimensions Method & Conditions 	<ol style="list-style-type: none"> Type (wall, cistern, etc.) Orientation Technique (pisé, ashlar, etc.) Bonding Material # of Coursings Facing/Finish (plaster, etc.) Dimensions Related architectural features 	<ol style="list-style-type: none"> Silt loose chocolate brown clear ~120cm x 220cm pickaxeing, shovelling; sunny
CUT:		
<ol style="list-style-type: none"> Shape in Plan Top - BOS Base - BOS Sides Orientation Dimensions 		

OTHER OBSERVATIONS/COMMENTS: *

. A line was drawn to divide trench 2 into two parts, 19026 being nearest 19005/ to the SW side of the trench. 19026 was further excavated while the NE side of 19022 was halted

. Main objective was to examine wall faces and depths of 19005, 19006, 19009; 19026 closed when foundation of 19005 was identified and a change in foundation from large stones to small stones + mortar was observed

MATRIX:

		19022		
		19026	This context	
		19027		

STRATIGRAPHIC RELATIONSHIPS:		FILLS:
CUT:	BUTTED BY:	FILLED BY:
CUT BY:	COVERS: 19027	EQUAL TO:
ABUTS:	COVERED BY: 19022, 19005, 19006	BINDS TO:

ENVIRONMENTAL SAMPLES TAKEN: POLLEN SOIL CHARCOAL OTHER
(specify): _____

* SEE OBSERVATIONS IN 19005

SPECIAL FINDS N°s:

INCLUSIONS: (check all that apply):
 MORTAR: F M R BONE: F M R BRICK/TILE: F M R
 METAL: F M R SLAG: F M R CHARC.: F M R WRKD STONE: F M R
 DAUB: F M R GLASS: F M R POTTERY: F M R UNWRKD STONE: F M R
 OTHER:

PHOTO N°s 100 - 8695 **PHOTO MODEL N°s**

SKETCH OF PLAN **INCLUDE:** 1. North arrow; 2. Dimensions; 3. Sample locations (if relevant); 4. Levels; 5. Grid pts (if relevant); 6. Rise/Drop in surface level; 7. Abutting architecture/Adjacent or relevant nearby features for reference; 8. All SU N°s

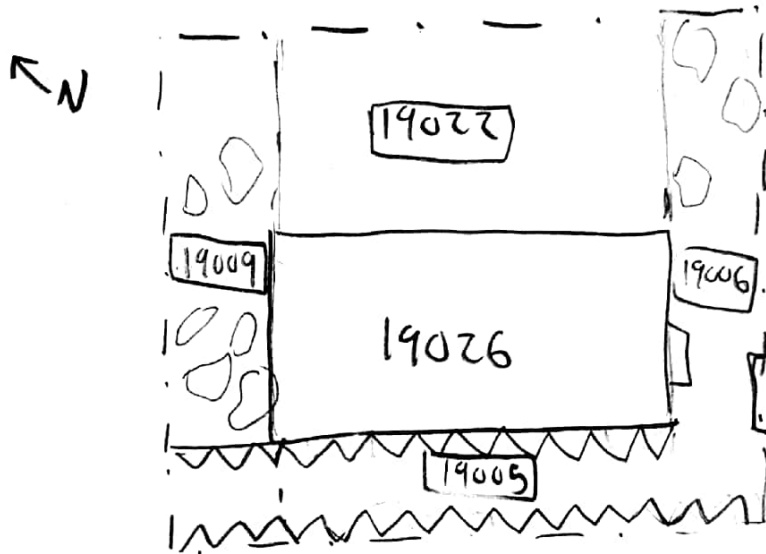

FIELD NOTEBOOK DRAWINGS - PAGE N°s					SECTION DRAWING N°s	
	HIGH			LOW	APPROX. DATE OF LAYER	DATABLE MATERIALS
STRATIGRAPHIC RELIABILITY	(5)	4	3	2	1	
CONFIDENCE IN INTERPRETATION	(5)	4	3	2	1	
CONTAMINATION RISK	5	4	3	(2)	1	

INTERPRETATION:
 . chocolate brown deposit abutting likely foundation of 19005, 19009
 does not appear to be a wall.

ENTERED INTO DATABASE **INITIALS:** NA **DATE:** 21 July 2018