

SITE CODE: MZ	DATE OPENED: 10 July	SU No: 19028	MARZUOLO ARCHAEOLOGICAL PROJECT 
	DATE CLOSED: 18 July	AREA No: 19000 (TRENCH 1)	
	INITIAL: TR		

FORMATION PROCESS:	DEFINITION: South wall of drain
ANTHROPIC <input checked="" type="checkbox"/> NATURAL <input type="checkbox"/>	SU TYPE: <input type="checkbox"/> DEPOSIT <input type="checkbox"/> CUT <input checked="" type="checkbox"/> STRUCTURAL
	DISTINGUISHED BY: <input type="checkbox"/> COLOUR <input type="checkbox"/> COMPACTION <input checked="" type="checkbox"/> COMPOSITION

DEPOSIT:	STRUCTURAL:	DESCRIPTION:
<ol style="list-style-type: none"> Composition (sand/silt/clay) Compaction Colour Clarity of Limits (clear/not clear/exc. lim. for N/S/W/E/depth) Dimensions Method & Conditions 	<ol style="list-style-type: none"> Type (wall, cistern, etc.) Orientation Technique (pisé, ashlar, etc.) Bonding Material # of Coursings Facing/Finish (plaster, etc.) Dimensions Related architectural features 	<ol style="list-style-type: none"> Wall (south) of structure interpreted as a drain NW-SE (appr.) Rounded and worked stones Mortar (slightly yellow?) 6 Mortar (construction in "cavo armato") 1.62m x 28cm Tiles in gap b/w 19025 and 19028, possibly the roof/cap to a drain

OTHER OBSERVATIONS/COMMENTS:
See 19025

MATRIX:

		19023	19029	19030
		19028	This context	
		19024		

STRATIGRAPHIC RELATIONSHIPS:	FILLS:
CUT:	BUTTED BY: 19029, 19030
CUT BY:	COVERS: 19024
ABUTS:	COVERED BY: 19023
	FILLED BY:
	EQUAL TO:
	BINDS TO:

ENVIRONMENTAL SAMPLES TAKEN: POLLEN SOIL CHARCOAL OTHER
(specify): _____

SPECIAL FINDS N°s:

INCLUSIONS: (check all that apply):
 MORTAR: F M R BONE: F M R BRICK/TILE: F M R
 METAL: F M R SLAG: F M R CHARC.: F M R WRKD STONE: F M R
 DAUB: F M R GLASS: F M R POTTERY: F M R UNWRKD STONE: F M R
 OTHER:

PHOTO N°s 100-8705, 8707, 8708
100-1025
PHOTO MODEL N°s

SKETCH OF PLAN **INCLUDE:** 1. North arrow; 2. Dimensions; 3. Sample locations (if relevant); 4. Levels; 5. Grid pts (if relevant); 6. Rise/Drop in surface level; 7. Abutting architecture/Adjacent or relevant nearby features for reference; 8. All SU N°s

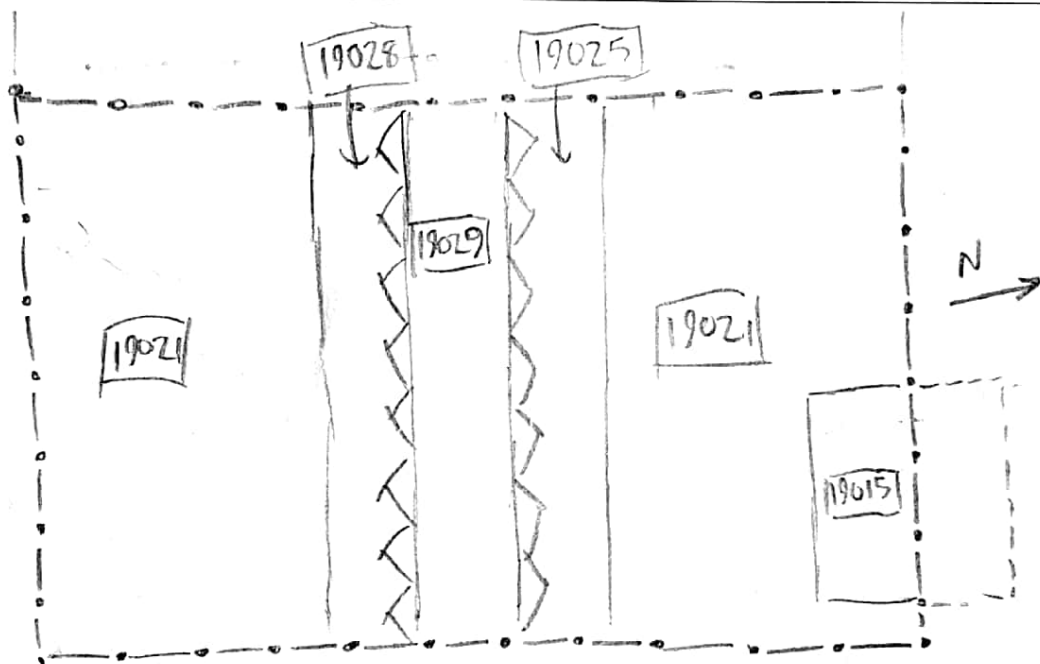

FIELD NOTEBOOK DRAWINGS - PAGE N°s						SECTION DRAWING N°s	
	HIGH				LOW	APPROX. DATE OF LAYER	
STRATIGRAPHIC RELIABILITY	5	4	3	2	1		
CONFIDENCE IN INTERPRETATION	5	4	3	2	1	DATEABLE MATERIALS	
CONTAMINATION RISK	5	4	3	2	1		

INTERPRETATION:

Interpretal as well for drain. See 19025

ENTERED INTO DATABASE **INITIALS:** n/a **DATE:** 21 July 2018