

SITE CODE: <b>MZ</b>	DATE OPENED: 12 July	SU No: 19031	MARZUOLO ARCHAEOLOGICAL PROJECT 
	DATE CLOSED: 18 July	AREA No: 19000	
INITIAL: AK			

FORMATION PROCESS:	DEFINITION: All of drain below 19030
ANTHROPIC <input type="checkbox"/> NATURAL <input type="checkbox"/>	SU TYPE: <input checked="" type="checkbox"/> DEPOSIT <input type="checkbox"/> CUT <input type="checkbox"/> STRUCTURAL
	DISTINGUISHED BY: <input type="checkbox"/> COLOUR <input type="checkbox"/> COMPACTION <input checked="" type="checkbox"/> COMPOSITION

<b>DEPOSIT:</b> 1. Composition (sand/silt/clay) 2. Compaction 3. Colour 4. Clarity of Limits (clear/not clear/exc. lim. for N/S/W/E/depth) 5. Dimensions 6. Method & Conditions	<b>STRUCTURAL:</b> 1. Type (wall, cistern, etc.) 2. Orientation 3. Technique (pisé, ashlar, etc.) 4. Bonding Material 5. # of Coursings 6. Facing/Finish (plaster, etc.) 7. Dimensions 8. Related architectural features	<b>DESCRIPTION:</b> 1. silt 2. friable (loose) 3. dark brown 4. clear everywhere 5. approx 1.5m x 30cm 6. Much of this context was excavated after heavy rain so it was very muddy pickaxe, trowel
<b>CUT:</b> 1. Shape in Plan 2. Top - BOS 3. Base - BOS 4. Sides 5. Orientation 6. Dimensions		

**OTHER OBSERVATIONS/COMMENTS:**  
 Context opened because it is at the bottom of tile layer + + sig vessel found in 19030. Soil sample taken.  
 Found 2 pieces of bone + 1 piece of ceramic only.  
 Beneath context was found a layer of stones (19039) which we decided was the bottom of the drain.

**MATRIX:**

		19030		
		19031	This context	
		19039	19025	19028

<b>STRATIGRAPHIC RELATIONSHIPS:</b>		<b>FILLS:</b>
CUT:	BUTTED BY:	FILLED BY:
CUT BY:	COVERS: 19039	EQUAL TO:
ABUTS: 19025, 19028	COVERED BY: 19031	BINDS TO:

**ENVIRONMENTAL SAMPLES TAKEN:**  POLLEN  SOIL  CHARCOAL  OTHER  
 (specify): \_\_\_\_\_

**SPECIAL FINDS N°s:**

**INCLUSIONS:** (check all that apply):  
 MORTAR:  F  M  R    BONE:  F  M  R    BRICK/TILE:  F  M  R  
 METAL:  F  M  R    SLAG:  F  M  R    CHARC.:  F  M  R    WRKD STONE:  F  M  R  
 DAUB:  F  M  R    GLASS:  F  M  R    POTTERY:  F  M  R    UNWRKD STONE:  F  M  R  
 OTHER:

**PHOTO N°s**

100-8723, 8724

**PHOTO MODEL N°s**

**SKETCH OF PLAN**

**INCLUDE:** 1. North arrow; 2. Dimensions; 3. Sample locations (if relevant); 4. Levels; 5. Grid pts (if relevant); 6. Rise/Drop in surface level; 7. Abutting architecture/Adjacent or relevant nearby features for reference; 8. All SU N°s

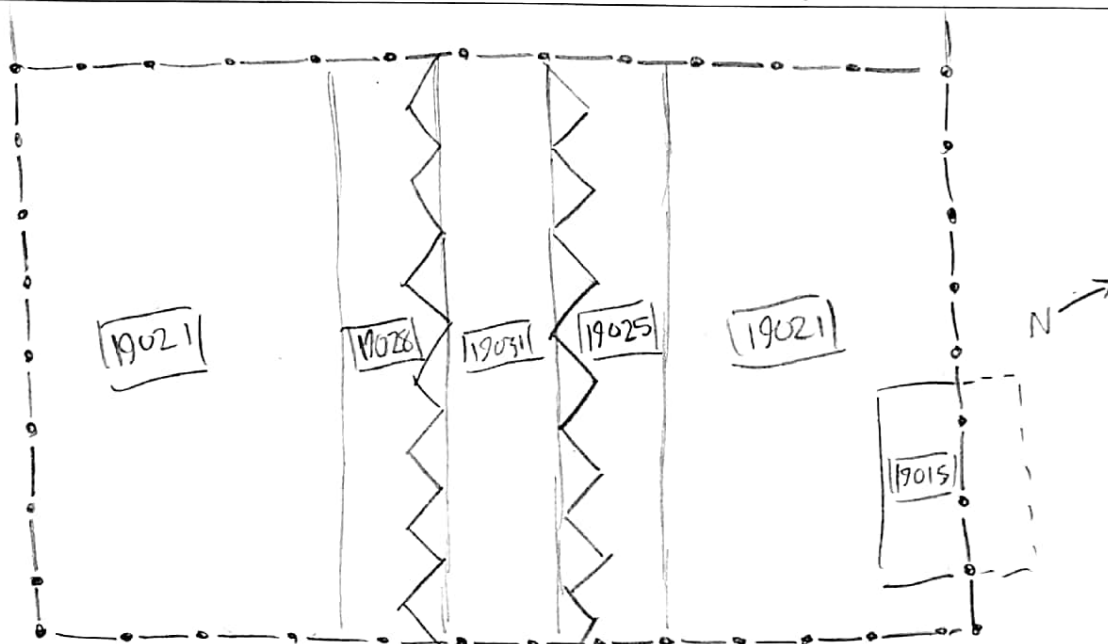

**FIELD NOTEBOOK DRAWINGS - PAGE N°s**

**SECTION DRAWING N°s**

	HIGH		LOW		
<b>STRATIGRAPHIC RELIABILITY</b>	(5)	4	3	2	1
<b>CONFIDENCE IN INTERPRETATION</b>	(5)	4	3	2	1
<b>CONTAMINATION RISK</b>	5	(4)	3	2	(1)

**APPROX. DATE OF LAYER**  
**DATABLE MATERIALS**

**INTERPRETATION:**

Deposit in drain beneath fill of stone/tile (19030) and above the drain floor.

**ENTERED INTO DATABASE**

**INITIALS:** HA

**DATE:** 21 July 2018