

SITE CODE: MZ	DATE OPENED: <i>17 July</i>	SU No: <i>19037</i>	MARZUOLO ARCHAEOLOGICAL PROJECT <small>(NAME)</small>
	DATE CLOSED: INITIAL: <i>AK/ALF</i>	AREA No: <i>19000</i>	

FORMATION PROCESS: ANTHROPIC <input type="checkbox"/> NATURAL <input checked="" type="checkbox"/>	DEFINITION: <i>layer below 19004 in all parts of 19000 that were left unexcavated</i>
	SU TYPE: <input checked="" type="checkbox"/> DEPOSIT <input type="checkbox"/> CUT <input type="checkbox"/> STRUCTURAL
	DISTINGUISHED BY: <input checked="" type="checkbox"/> COLOUR <input checked="" type="checkbox"/> COMPACTION <input checked="" type="checkbox"/> COMPOSITION

DEPOSIT: 1. Composition (sand/silt/clay) 2. Compaction 3. Colour 4. Clarity of Limits (clear/not clear/exc. lim. for N/S/W/E/depth) 5. Dimensions 6. Method & Conditions	STRUCTURAL: 1. Type (wall, cistern, etc.) 2. Orientation 3. Technique (pisé, ashlar, etc.) 4. Bonding Material 5. # of Coursings 6. Facing/Finish (plaster, etc.) 7. Dimensions 8. Related architectural features	DESCRIPTION: <div style="text-align: center; font-size: 2em;"><i>Unexcavated</i></div>
---	--	--

OTHER OBSERVATIONS/COMMENTS:

MATRIX:

<i>19012</i>		<i>19013</i>		
		<i>19037</i> This context		
<i>19005</i>	<i>19009</i>	<i>19008</i>	<i>19006</i>	<i>19035 19002, 19003, 19033, 19034</i>

STRATIGRAPHIC RELATIONSHIPS:		FILLS:
CUT:	BUTTED BY:	FILLED BY:
CUT BY:	COVERS:	EQUAL TO:
ABUTS: <i>19005, 19009, 19008, 19006, 19035, 19002, 19003, 19033, 19034</i>	COVERED BY: <i>19012, 19013</i>	BINDS TO:

ENVIRONMENTAL SAMPLES TAKEN: POLLEN SOIL CHARCOAL OTHER
(specify): _____

SPECIAL FINDS N°s:

INCLUSIONS: (check all that apply):
 MORTAR: F M R BONE: F M R BRICK/TILE: F M R
 METAL: F M R SLAG: F M R CHARC.: F M R WRKD STONE: F M R
 DAUB: F M R GLASS: F M R POTTERY: F M R UNWRKD STONE: F M R
 OTHER:

PHOTO N°s 100-1027 **PHOTO MODEL N°s**

SKETCH OF PLAN **INCLUDE:** 1. North arrow; 2. Dimensions; 3. Sample locations (if relevant); 4. Levels; 5. Grid pts (if relevant); 6. Rise/Drop in surface level; 7. Abutting architecture/Adjacent or relevant nearby features for reference; 8. All SU N°s

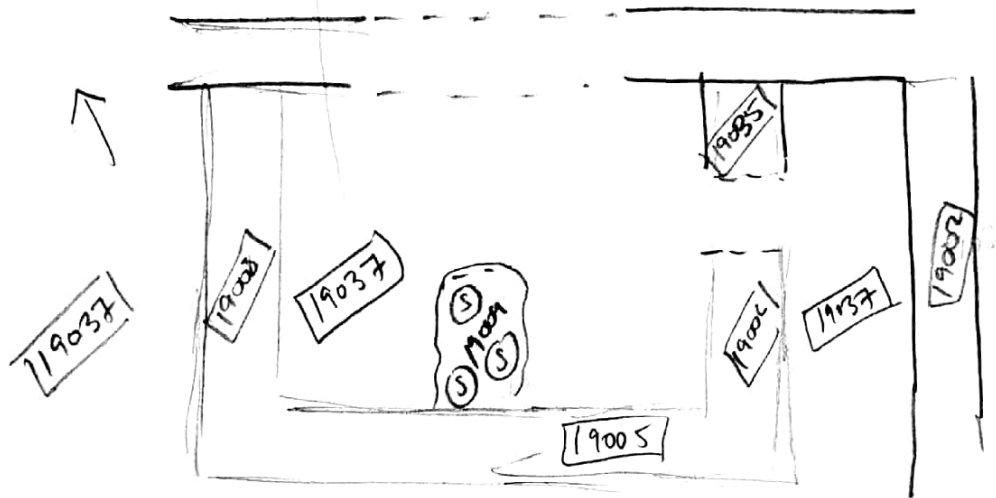

FIELD NOTEBOOK DRAWINGS - PAGE N°s	SECTION DRAWING N°s				
	HIGH		LOW		APPROX. DATE OF LAYER
STRATIGRAPHIC RELIABILITY	5	4	3	2	1
CONFIDENCE IN INTERPRETATION	5	4	3	2	1
CONTAMINATION RISK	5	4	3	2	1

INTERPRETATION:

Unexcavated

ENTERED INTO DATABASE **INITIALS:** N/A **DATE:** 21 July 2018