

SITE CODE: <b>MZ</b>	DATE OPENED: 18 July	SU No: 19039	MARZUOLO ARCHAEOLOGICAL PROJECT 
	DATE CLOSED: INITIAL: ALF	AREA No: 19000 (TR1)	

FORMATION PROCESS:  ANTHROPIC <input checked="" type="checkbox"/> NATURAL <input type="checkbox"/>	DEFINITION: Bottom of the drain
	SU TYPE: <input type="checkbox"/> DEPOSIT <input type="checkbox"/> CUT <input checked="" type="checkbox"/> STRUCTURAL
	DISTINGUISHED BY: <input type="checkbox"/> COLOUR <input type="checkbox"/> COMPACTION <input type="checkbox"/> COMPOSITION

<b>DEPOSIT:</b> 1. Composition (sand/silt/clay) 2. Compaction 3. Colour 4. Clarity of Limits (clear/not clear/exc. lim. for N/S/W/E/depth) 5. Dimensions 6. Method & Conditions	<b>STRUCTURAL:</b> ① Type (wall, cistern, etc.) ② Orientation ③ Technique (pisé, ashlar, etc.) 4. Bonding Material 5. # of Coursings 6. Facing/Finish (plaster, etc.) 7. Dimensions 8. Related architectural features	<b>DESCRIPTION:</b> ① Floor of the drain ② EW ③ Little size worked flat rocks ④ NA ⑤ NA ⑥ No. ⑦ m 1,60 x cm 60 ⑧ 19025, 19028
<b>CUT:</b> 1. Shape in Plan 2. Top - BOS 3. Base - BOS 4. Sides 5. Orientation 6. Dimensions		

**OTHER OBSERVATIONS/COMMENTS:**

**MATRIX:**

		19031		
		19039	This context	

<b>STRATIGRAPHIC RELATIONSHIPS:</b>		<b>FILLS:</b>
CUT:	BUTTED BY:	FILLED BY:
CUT BY:	COVERS:	EQUAL TO:
ABUTS: 19025, 19028	COVERED BY: 19031	BINDS TO:

**ENVIRONMENTAL SAMPLES TAKEN:**  POLLEN  SOIL  CHARCOAL  OTHER  
(specify): \_\_\_\_\_

**SPECIAL FINDS N°s:**

**INCLUSIONS:** (check all that apply):  
 MORTAR:  F  M  R  
 BONE:  F  M  R  
 BRICK/TILE:  F  M  R  
 METAL:  F  M  R  
 SLAG:  F  M  R  
 CHARC.:  F  M  R  
 WRKD STONE:  F  M  R  
 DAUB:  F  M  R  
 GLASS:  F  M  R  
 POTTERY:  F  M  R  
 UNWRKD STONE:  F  M  R  
 OTHER:

**PHOTO N°s**

100-1023

**PHOTO MODEL N°s**

**SKETCH OF PLAN**

**INCLUDE:** 1. North arrow; 2. Dimensions; 3. Sample locations (if relevant); 4. Levels; 5. Grid pts (if relevant); 6. Rise/Drop in surface level; 7. Abutting architecture/Adjacent or relevant nearby features for reference; 8. All SU N°s

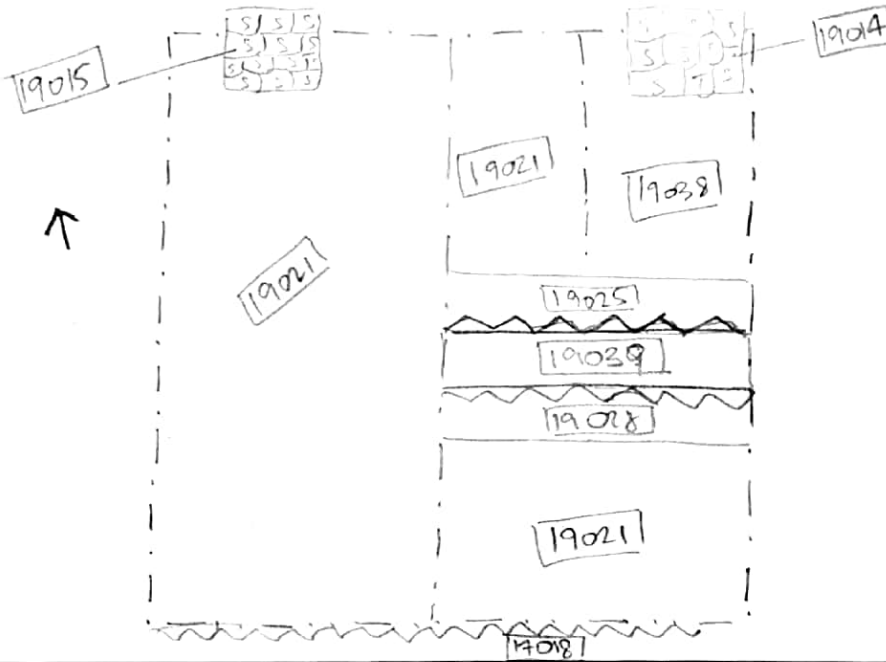

FIELD NOTEBOOK DRAWINGS - PAGE N°s						SECTION DRAWING N°s	
	HIGH				LOW	APPROX. DATE OF LAYER	
STRATIGRAPHIC RELIABILITY	(5)	4	3	2	1		
CONFIDENCE IN INTERPRETATION	(5)	4	3	2	1	DATEABLE MATERIALS	
CONTAMINATION RISK	5	4	3	2	(1)		

**INTERPRETATION:**

*Bottom of the drain*

**ENTERED INTO DATABASE**

**INITIALS:** 11A

**DATE:** 21 July 2018