



SITE CODE: MZ	DATE OPENED: 18 July	SU No: 10095	MARZUOLO ARCHAEOLOGICAL PROJECT
	DATE CLOSED: 18 July		
	INITIAL: BM	AREA No: 10000	

FORMATION PROCESS:	DEFINITION: patch of coccio-pesto under 10094
ANTHROPIC <input type="checkbox"/> NATURAL <input checked="" type="checkbox"/>	SU TYPE: <input checked="" type="checkbox"/> DEPOSIT <input type="checkbox"/> CUT <input type="checkbox"/> STRUCTURAL
	DISTINGUISHED BY: <input checked="" type="checkbox"/> COLOUR <input checked="" type="checkbox"/> COMPACTION <input checked="" type="checkbox"/> COMPOSITION

DEPOSIT:	STRUCTURAL:	DESCRIPTION:
<ol style="list-style-type: none"> Composition (sand/silt/clay) Compaction Colour Clarity of Limits (clear/not clear/exc. lim. for N/S/W/E/depth) Dimensions Method & Conditions 	<ol style="list-style-type: none"> Type (wall, cistern, etc.) Orientation Technique (pisé, ashlar, etc.) Bonding Material # of Coursings Facing/Finish (plaster, etc.) Dimensions Related architectural features 	<ol style="list-style-type: none"> Coccio-pesto medium compact white on top, flecked with red. More yellow underneath N, W, E: clear S: trench limit depth: clear 5. 50cm NS 40 cm EW Sunny, pick & shovel
CUT:		
<ol style="list-style-type: none"> Shape in Plan Top - BOS Base - BOS Sides Orientation Dimensions 		

OTHER OBSERVATIONS/COMMENTS:

White coccio-pesto flecked with red tile bits and transitions to a yellow sandy soil lower down

Very defined edges around the white material /

includes larger pieces of tile and stone

greater density of stones underneath 10095

MATRIX:

		10094		
		10095	This context	
		10100		

STRATIGRAPHIC RELATIONSHIPS:		FILLS:
CUT:	BUTTED BY:	FILLED BY:
CUT BY:	COVERS: 10100	EQUAL TO:
ABUTS:	COVERED BY: 10094	BINDS TO:

ENVIRONMENTAL SAMPLES TAKEN: POLLEN SOIL CHARCOAL OTHER
 (specify): _____

SPECIAL FINDS N ^o s:	
---------------------------------	--

INCLUSIONS: (check all that apply):	MORTAR: <input checked="" type="checkbox"/> F <input type="checkbox"/> M <input type="checkbox"/> R	BONE: <input type="checkbox"/> F <input type="checkbox"/> M <input type="checkbox"/> R	BRICK/TILE: <input type="checkbox"/> F <input type="checkbox"/> M <input type="checkbox"/> R
METAL: <input type="checkbox"/> F <input type="checkbox"/> M <input type="checkbox"/> R	SLAG: <input type="checkbox"/> F <input type="checkbox"/> M <input type="checkbox"/> R	CHARC.: <input type="checkbox"/> F <input type="checkbox"/> M <input type="checkbox"/> R	WRKD STONE: <input type="checkbox"/> F <input type="checkbox"/> M <input type="checkbox"/> R
DAUB: <input type="checkbox"/> F <input type="checkbox"/> M <input type="checkbox"/> R	GLASS: <input type="checkbox"/> F <input type="checkbox"/> M <input type="checkbox"/> R	POTTERY: <input type="checkbox"/> F <input type="checkbox"/> M <input type="checkbox"/> R	UNWRKD STONE: <input checked="" type="checkbox"/> F <input type="checkbox"/> M <input type="checkbox"/> R
OTHER:			

PHOTO N ^o s	100_8760 S 10094	PHOTO MODEL N ^o s	
------------------------	------------------	------------------------------	--

SKETCH OF PLAN	INCLUDE: 1. North arrow; 2. Dimensions; 3. Sample locations (if relevant); 4. Levels; 5. Grid pts (if relevant); 6. Rise/Drop in surface level; 7. Abutting architecture/Adjacent or relevant nearby features for reference; 8. All SU N ^o s
----------------	---

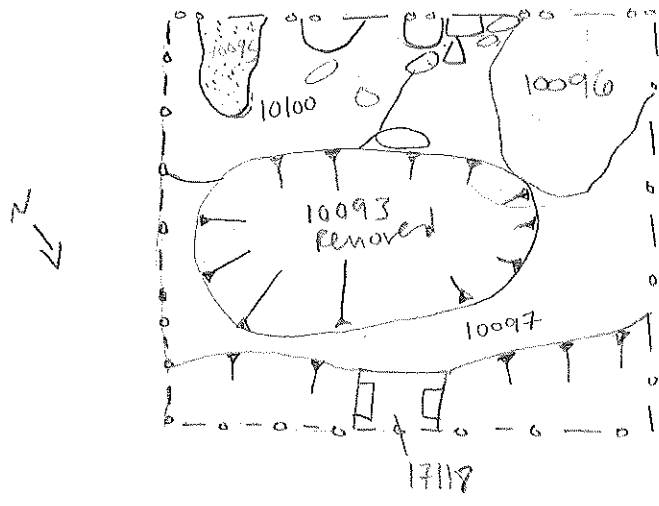

FIELD NOTEBOOK DRAWINGS - PAGE N ^o s	P. 34				SECTION DRAWING N ^o s	
STRATIGRAPHIC RELIABILITY	HIGH			LOW	APPROX. DATE OF LAYER	
CONFIDENCE IN INTERPRETATION	5	(4)	3	2	1	
CONTAMINATION RISK	5	(4)	3	2	1	

INTERPRETATION:
 Structural collapse; Coccio pesto does not appear to be in situ; like 17129, where did this come from?

ENTERED INTO DATABASE	INITIALS: RGV	DATE: June 5, 2019
-----------------------	---------------	--------------------