

SITE CODE: MZ	DATE OPENED: 6 July	SU No: 17132	MARZUOLO ARCHAEOLOGICAL PROJECT 
	DATE CLOSED:	AREA No: 17000	
	INITIAL: 00D	TRENCH 2	

FORMATION PROCESS:	DEFINITION: <i>Hard orange clay layer</i>
ANTHROPIC <input checked="" type="checkbox"/> NATURAL <input type="checkbox"/>	SU TYPE: <input checked="" type="checkbox"/> DEPOSIT <input type="checkbox"/> CUT <input type="checkbox"/> STRUCTURAL
	DISTINGUISHED BY: <input checked="" type="checkbox"/> COLOUR <input checked="" type="checkbox"/> COMPACTION <input checked="" type="checkbox"/> COMPOSITION

DEPOSIT:	STRUCTURAL:	DESCRIPTION:
<ol style="list-style-type: none"> Composition (sand/silt/clay) Compaction Colour Clarity of Limits (clear/not clear/exc. lim. for N/S/W/E/depth) Dimensions Method & Conditions 	<ol style="list-style-type: none"> Type (wall, cistern, etc.) Orientation Technique (pisé, ashlar, etc.) Bonding Material # of Coursings Facing/Finish (plaster, etc.) Dimensions Related architectural features 	<ol style="list-style-type: none"> Clay hard orange, red, mortar (white) w exc limit; N exc limit; E clear, S exc limit W 285cm x E 3m x N 1m x S .5m Junny pick & trowel
CUT:		
<ol style="list-style-type: none"> Shape in Plan Top - BOS Base - BOS Sides Orientation Dimensions 		

OTHER OBSERVATIONS/COMMENTS:
 Hard orange layer, brick and mortar covered by 17127. Area appeared larger before removal of 17127 - SW - NE diagonal orientation becomes S - N strip along western limit.
 Extended limit to the East along northern trench wall - the extension is lower than rest of 17132 and less orange - visible soil matrix where rest is pure

MATRIX:

<input type="checkbox"/>	<input type="checkbox"/>	17127	<input type="checkbox"/>	<input type="checkbox"/>	day (photo 8688)
<input type="checkbox"/>	<input type="checkbox"/>	17132	This context	17133	
<input type="checkbox"/>	<input type="checkbox"/>	17136	<input type="checkbox"/>	<input type="checkbox"/>	

STRATIGRAPHIC RELATIONSHIPS:	FILLS:
CUT:	BUTTED BY: 17133
CUT BY:	COVERS: 17136
ABUTS:	COVERED BY: 17127
	FILLED BY:
	EQUAL TO:
	BINDS TO:

ENVIRONMENTAL SAMPLES TAKEN: POLLEN SOIL CHARCOAL OTHER
 (specify): _____

SPECIAL FINDS N°s:

INCLUSIONS: (check all that apply):
 METAL: F M R
 DAUB: F M R
 OTHER:
 MORTAR: F M R
 SLAG: F M R
 GLASS: F M R
 BONE: F M R
 CHARC.: F M R
 POTTERY: F M R
 BRICK/TILE: F M R
 WRKD STONE: F M R
 UNWRKD STONE: F M R

PHOTO N°s 100-0725, 100-0726
 100-8688, 100-8691
PHOTO MODEL N°s

SKETCH OF PLAN INCLUDE: 1. North arrow; 2. Dimensions; 3. Sample locations (if relevant); 4. Levels; 5. Grid pts (if relevant); 6. Rise/Drop in surface level; 7. Abutting architecture/Adjacent or relevant nearby features for reference; 8. All SU N°s

- baked layer of daub
- mortar stripes underneath daub
- daub with plaster facing
- large blocks w/ organic material and unclear shape on top of daub in SW corner.

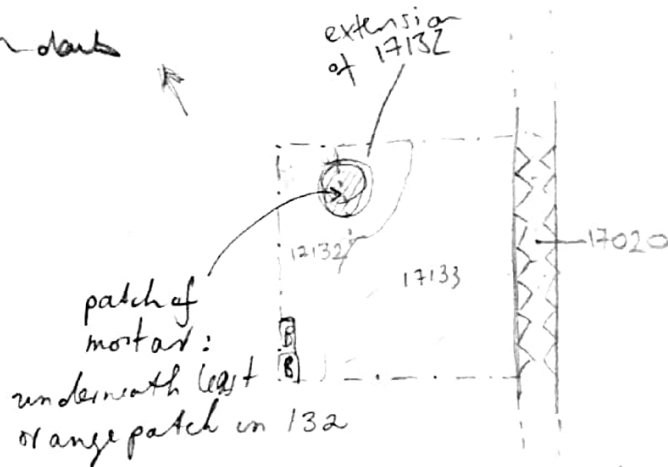

FIELD NOTEBOOK DRAWINGS - PAGE N°s						SECTION DRAWING N°s	
	HIGH				LOW	APPROX. DATE OF LAYER	DATABLE MATERIALS
STRATIGRAPHIC RELIABILITY	(5)	4	3	2	1		
CONFIDENCE IN INTERPRETATION	(5)	4	3	2	1		
CONTAMINATION RISK	5	4	3	2	(1)		

INTERPRETATION:
 Dump of collapse material made up of baked brick and daub.

ENTERED INTO DATABASE INITIALS: TCH DATE: July 19, 2018