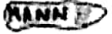

SITE CODE: MZ	DATE OPENED: 16 July	SU N°: 17145	MARZUOLO ARCHAEOLOGICAL PROJECT 
	DATE CLOSED: 19 July		
	INITIAL: OOD	AREA N°: 17000	

FORMATION PROCESS: ANTHROPIC <input type="checkbox"/> NATURAL <input checked="" type="checkbox"/>	DEFINITION: Layer underneath 17140 & 17141
	SU TYPE: <input checked="" type="checkbox"/> DEPOSIT <input type="checkbox"/> CUT <input type="checkbox"/> STRUCTURAL
	DISTINGUISHED BY: <input type="checkbox"/> COLOUR <input type="checkbox"/> COMPACTION <input checked="" type="checkbox"/> COMPOSITION

DEPOSIT: 1. Composition (sand/silt/clay) 2. Compaction 3. Colour 4. Clarity of Limits (clear/not clear/exc. lim. for N/S/W/E/depth) 5. Dimensions 6. Method & Conditions	STRUCTURAL: 1. Type (wall, cistern, etc.) 2. Orientation 3. Technique (pisé, ashlar, etc.) 4. Bonding Material 5. # of Coursings 6. Facing/Finish (plaster, etc.) 7. Dimensions 8. Related architectural features	DESCRIPTION: 1. clayey 2. medium to hard 3. Brown w/ red patches, pale green clay & charcoal. 4. E clear; S exc-limit clear; N exc-limit clear; W exc-limit clear but charcoal context? 5. W 285 cm, S 215 cm, E 215 cm, 2m 6. overcast, slightly rainy
---------------------------------------------------------------------------------------------------------------------------------------------------------------------------------------------------	--------------------------------------------------------------------------------------------------------------------------------------------------------------------------------------------------------------------------------------------------	----------------------------------------------------------------------------------------------------------------------------------------------------------------------------------------------------------------------------------------------------------------------------------

OTHER OBSERVATIONS/COMMENTS:

- tile and stone concentration on eastern end of trench
- charcoal concentration on western end of trench
- patches of brick and chunks of wattle and daub in the part of 17145 that covers 17146
- cocchio pesto patch in circular form in Northwestern corner
- when cleaning 17145 off of 17146, it was unavoidable that chunks of soil from 17145

MATRIX:

<input type="checkbox"/>	<input type="checkbox"/>	17140	17141	<input type="checkbox"/>
<input type="checkbox"/>	<input type="checkbox"/>	17145	This context	17020
<input type="checkbox"/>	<input type="checkbox"/>	17146	17149	17152

fell between + into the vacuum between stones of the 17146 collapse and onto the layer below

STRATIGRAPHIC RELATIONSHIPS:		FILLS:
CUT:	BUTTED BY:	FILLED BY:
CUT BY:	COVERS: 17146 - 17149, 17152	EQUAL TO:
ABUTS: 17020	COVERED BY: 17140, 17141	BINDS TO:

ENVIRONMENTAL SAMPLES TAKEN: POLLEN SOIL CHARCOAL OTHER (specify): _____

SPECIAL FINDS N^{os}: 47-444, 17-448

INCLUSIONS: (check all that apply):
 MORTAR: F M R
 METAL: F M R
 DAUB: F M R
 OTHER:
 BONE: F M R
 SLAG: F M R
 GLASS: F M R
 CHARG.: F M R
 POTTERY: F M R
 BRICK/TILE: F M R
 WRKD STONE: F M R
 UNWRKD STONE: F M R

PHOTO N^{os} 100-8751, 100-8752 **PHOTO MODEL N^{os}**

SKETCH OF PLAN INCLUDE: 1. North arrow; 2. Dimensions; 3. Sample locations (if relevant); 4. Levels; 5. Grid pts (if relevant); 6. Rise/Drop in surface level; 7. Abutting architecture/Adjacent or relevant nearby features for reference; 8. All SU N^{os}

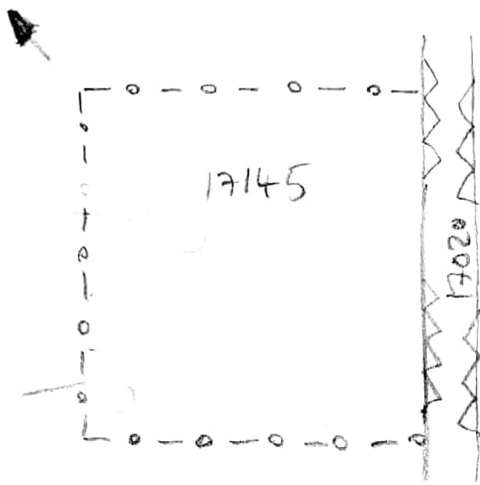

FIELD NOTEBOOK DRAWINGS - PAGE N ^{os}					SECTION DRAWING N ^{os}		
STRATIGRAPHIC RELIABILITY	HIGH			LOW	APPROX. DATE OF LAYER		
	5	4	3	2			1
	5	4	3	2			1
CONFIDENCE IN INTERPRETATION	5	4	3	2	1	DATABLE MATERIALS	
CONTAMINATION RISK	5	4	3	2	1		

INTERPRETATION:

ENTERED INTO DATABASE INITIALS: DATE: