

SITE CODE: MZ	DATE OPENED: 16 July	SU No: 17147	MARZUOLO ARCHAEOLOGICAL PROJECT 
	DATE CLOSED: 17 July	AREA No: 17000 TR-1	
	INITIAL: NL		

FORMATION PROCESS: ANTHROPIC <input checked="" type="checkbox"/> NATURAL <input type="checkbox"/>	DEFINITION: deposit of orange soil filling broken amphora
	SU TYPE: <input checked="" type="checkbox"/> DEPOSIT <input type="checkbox"/> CUT <input type="checkbox"/> STRUCTURAL
	DISTINGUISHED BY: <input checked="" type="checkbox"/> COLOUR <input type="checkbox"/> COMPACTION <input type="checkbox"/> COMPOSITION

DEPOSIT: 1. Composition (sand/silt/clay) 2. Compaction 3. Colour 4. Clarity of Limits (clear/not clear/exc. lim. for N/S/W/E/depth) 5. Dimensions 6. Method & Conditions	STRUCTURAL: 1. Type (wall, cistern, etc.) 2. Orientation 3. Technique (pisé, ashlar, etc.) 4. Bonding Material 5. # of Coursings 6. Facing/Finish (plaster, etc.) 7. Dimensions 8. Related architectural features	DESCRIPTION: 1. Silty Clay 2. Moderate compaction 3. orange brown 4. all clear 5. ca. 30 cm in dia. 6. Handpick & trowel, sunny
---	--	--

OTHER OBSERVATIONS/COMMENTS:
 - took soil sample before the flood of 2018
 - soil inside amphora, which was sitting on 17159

MATRIX:

		17144		
		17147	This context	

STRATIGRAPHIC RELATIONSHIPS:		FILLS:
CUT:	BUTTED BY:	FILLED BY:
CUT BY:	COVERS:	EQUAL TO:
ABUTS:	COVERED BY: 17144	BINDS TO:

ENVIRONMENTAL SAMPLES TAKEN: POLLEN SOIL CHARCOAL OTHER
 (specify): _____

SPECIAL FINDS N^os:

INCLUSIONS: (check all that apply):
 MORTAR: F M R BONE: F M R BRICK/TILE: F M R
 METAL: F M R SLAG: F M R CHARC.: F M R WRKD STONE: F M R
 DAUB: F M R GLASS: F M R POTTERY: F M R UNWRKD STONE: F M R
 OTHER:

PHOTO N^os 100 - 0955, 100-0980, 100-0981, 100-0982 **PHOTO MODEL N^os**

SKETCH OF PLAN **INCLUDE:** 1. North arrow; 2. Dimensions; 3. Sample locations (if relevant); 4. Levels; 5. Grid pts (if relevant); 6. Rise/Drop in surface level; 7. Abutting architecture/Adjacent or relevant nearby features for reference; 8. All SU N^os

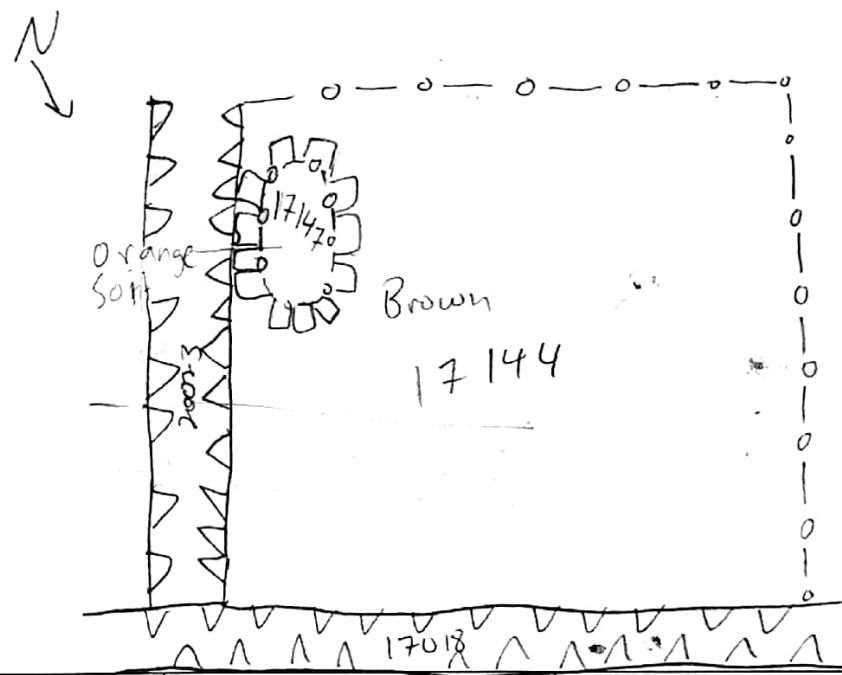

FIELD NOTEBOOK DRAWINGS - PAGE N ^o s						SECTION DRAWING N ^o s
	HIGH				LOW	APPROX. DATE OF LAYER
STRATIGRAPHIC RELIABILITY	(5)	4	3	2	1	DATABLE MATERIALS
CONFIDENCE IN INTERPRETATION	5	4	(3)	2	1	
CONTAMINATION RISK	5	4	3	2	(1)	

INTERPRETATION:

amphora inside collapse/occupation layer, soil was distinctly different inside, sampled and will be a different context; possible decay of whatever was inside the amphora.

ENTERED INTO DATABASE **INITIALS:** **DATE:**