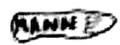

| | | | |
|--------------------------------|-----------------------------|--------------------------------|---|
| SITE CODE: MZ | DATE OPENED: 19 July | SU No: 17153 | MARZUOLO ARCHAEOLOGICAL PROJECT  |
| | DATE CLOSED: | AREA No: 1700 (TR 2) | |
| | INITIAL: ALF | | |

| | |
|--|---|
| FORMATION PROCESS: | DEFINITION: chocolate layer underneath 17152 |
| ANTHROPIC <input type="checkbox"/> NATURAL <input checked="" type="checkbox"/> | SU TYPE: <input checked="" type="checkbox"/> DEPOSIT <input type="checkbox"/> CUT <input type="checkbox"/> STRUCTURAL |
| | DISTINGUISHED BY: <input type="checkbox"/> COLOUR <input type="checkbox"/> COMPACTION <input type="checkbox"/> COMPOSITION |

| | | |
|---|--|---|
| DEPOSIT: 1. Composition (sand/silt/clay) 2. Compaction 3. Colour 4. Clarity of Limits (clear/not clear/exc. lim. for N/S/W/E/depth) 5. Dimensions 6. Method & Conditions | STRUCTURAL: 1. Type (wall, cistern, etc.) 2. Orientation 3. Technique (pisé, ashlar, etc.) 4. Bonding Material 5. # of Coursings 6. Facing/Finish (plaster, etc.) 7. Dimensions 8. Related architectural features | DESCRIPTION: ① silt clay ② strong medium ③ Dark brown ④ limit of the trench ⑤ " " " " ⑥ Pickaxing, sunny |
|---|--|---|

OTHER OBSERVATIONS/COMMENTS:

MATRIX:

| | | | | |
|------------------|-------|-------|--------------|--|
| 17146 | 17146 | 17152 | | |
| | | 17153 | This context | |
| | | | | |

| | |
|-------------------------------------|---------------------------|
| STRATIGRAPHIC RELATIONSHIPS: | FILLS: |
| CUT: | BUTTED BY: |
| CUT BY: | COVERS: |
| ABUTS: 17020 | COVERED BY: 17146 - 17152 |

ENVIRONMENTAL SAMPLES TAKEN: POLLEN SOIL CHARCOAL OTHER
 (specify): _____

SPECIAL FINDS N°s:

INCLUSIONS: (check all that apply):
 MORTAR: F M R BONE: F M R BRICK/TILE: F M R
 METAL: F M R SLAG: F M R CHARC.: F M R WRKD STONE: F M R
 DAUB: F M R GLASS: F M R POTTERY: F M R UNWRKD STONE: F M R
 OTHER:

PHOTO N°s 100-1093 **PHOTO MODEL N°s**

SKETCH OF PLAN **INCLUDE:** 1. North arrow; 2. Dimensions; 3. Sample locations (if relevant); 4. Levels; 5. Grid pts (if relevant); 6. Rise/Drop in surface level; 7. Abutting architecture/Adjacent or relevant nearby features for reference; 8. All SU N°s

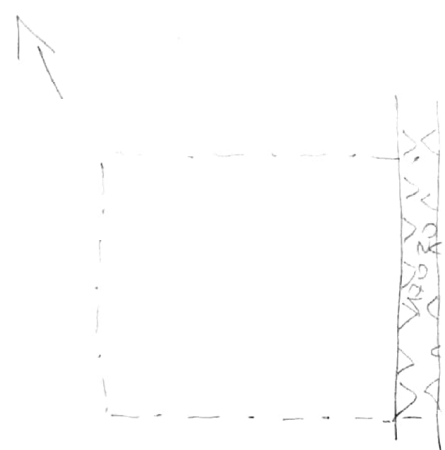

| FIELD NOTEBOOK DRAWINGS - PAGE N°s | | | | | | SECTION DRAWING N°s | |
|------------------------------------|------|---|---|---|-----|-----------------------|--|
| | HIGH | | | | LOW | APPROX. DATE OF LAYER | |
| STRATIGRAPHIC RELIABILITY | 5 | 4 | 3 | 2 | 1 | | |
| CONFIDENCE IN INTERPRETATION | 5 | 4 | 3 | 2 | 1 | DATABLE MATERIALS | |
| CONTAMINATION RISK | 5 | 4 | 3 | 2 | 1 | | |

INTERPRETATION:
 layer where the wall 17020 is built

ENTERED INTO DATABASE **INITIALS:** **DATE:**