

SITE CODE: MZ	DATE OPENED: 14 July 2018	SU No: 17155 TR4	MARZUOLO ARCHAEOLOGICAL PROJECT 
	DATE CLOSED: INITIAL: NA	AREA No: 17000	

FORMATION PROCESS: ANTHROPIC <input type="checkbox"/> NATURAL <input checked="" type="checkbox"/>	DEFINITION: orange-brown deposit in TR-4
	SU TYPE: <input checked="" type="checkbox"/> DEPOSIT <input type="checkbox"/> CUT <input type="checkbox"/> STRUCTURAL
	DISTINGUISHED BY: <input checked="" type="checkbox"/> COLOUR <input type="checkbox"/> COMPACTION <input type="checkbox"/> COMPOSITION

DEPOSIT: 1. Composition (sand/silt/clay) 2. Compaction 3. Colour 4. Clarity of Limits (clear/not clear/exc. lim. for N/S/W/E/depth) 5. Dimensions 6. Method & Conditions	STRUCTURAL: 1. Type (wall, cistern, etc.) 2. Orientation 3. Technique (pisé, ashlar, etc.) 4. Bonding Material 5. # of Coursings 6. Facing/Finish (plaster, etc.) 7. Dimensions 8. Related architectural features	DESCRIPTION: 1. clay-silt 2. unexcavated 3. orange-brown 4. clear-W; N/S/E - exc. limit 5. trench limits 6. unexcavated
---	--	--

OTHER OBSERVATIONS/COMMENTS:

UNEXCAVATED

may equal 17060 excavated to the N in 2017 and 17128 = 17148 excavated to the E

MATRIX:

<input type="checkbox"/>	<input type="checkbox"/>	17001	<input type="checkbox"/>	<input type="checkbox"/>
<input type="checkbox"/>	<input type="checkbox"/>	17155	This context	
<input type="checkbox"/>	<input type="checkbox"/>	<input type="checkbox"/>	<input type="checkbox"/>	<input type="checkbox"/>

STRATIGRAPHIC RELATIONSHIPS:		FILLS:
CUT:	BUTTED BY:	FILLED BY:
CUT BY:	COVERS:	EQUAL TO: 17060, 17128 = 17148
ABUTS: 170020	COVERED BY: 17001	BINDS TO:

ENVIRONMENTAL SAMPLES TAKEN: POLLEN SOIL CHARCOAL OTHER

(specify): _____

SPECIAL FINDS N°s:

INCLUSIONS: (check all that apply):
 MORTAR: F M R BONE: F M R BRICK/TILE: F M R
 METAL: F M R SLAG: F M R CHARG.: F M R WRKD STONE: F M R
 DAUB: F M R GLASS: F M R POTTERY: F M R UNWRKD STONE: F M R
 OTHER:

PHOTO N°s 100-8833 **PHOTO MODEL N°s**

SKETCH OF PLAN **INCLUDE:** 1. North arrow; 2. Dimensions; 3. Sample locations (if relevant); 4. Levels; 5. Grid pts (if relevant); 6. Rise/Drop in surface level; 7. Abutting architecture/Adjacent or relevant nearby features for reference; 8. All SU N°s

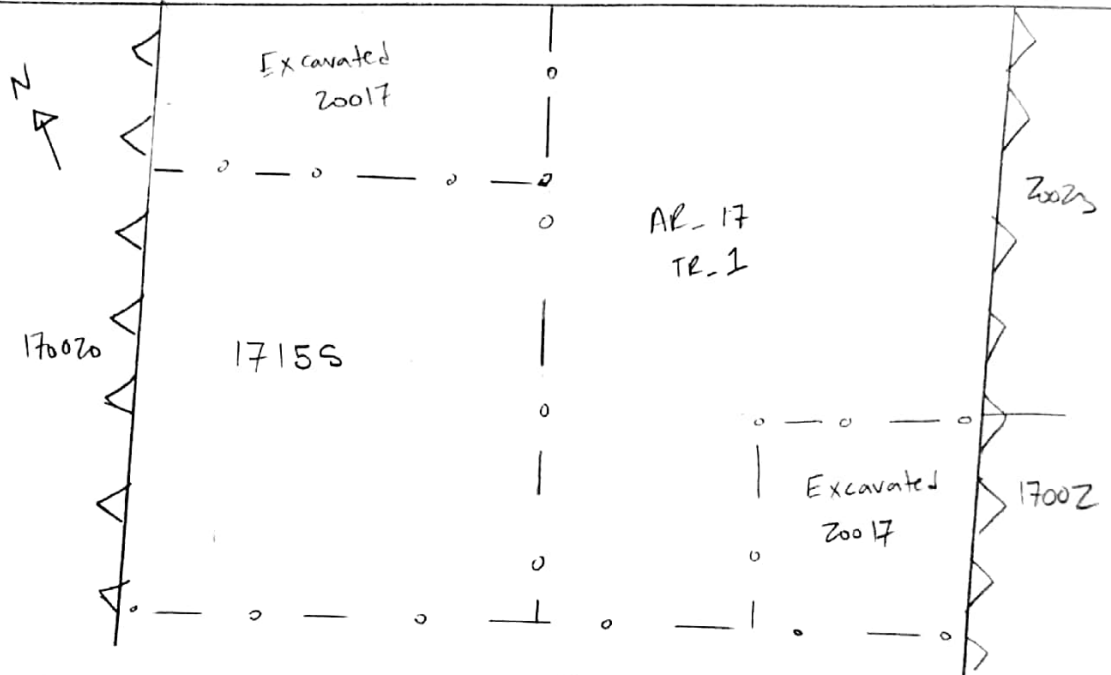

FIELD NOTEBOOK DRAWINGS - PAGE N°s	P 31				SECTION DRAWING N°s			
STRATIGRAPHIC RELIABILITY	HIGH			LOW	APPROX. DATE OF LAYER			
CONFIDENCE IN INTERPRETATION	5	(4)	3	2			DATABLE MATERIALS	
CONTAMINATION RISK	5	(4)	3	2				

INTERPRETATION:
 Appears to be a good arch layer, but under back fill; decided to wait to excavate.

ENTERED INTO DATABASE **INITIALS:** **DATE:**