

SITE CODE: MZ	DATE OPENED: 20 July 2018	SU No: 17159	MARZUOLO ARCHAEOLOGICAL PROJECT 
	DATE CLOSED: 21 July 2018	AREA No: 17000	
	INITIAL: MH		

FORMATION PROCESS: ANTHROPIC <input type="checkbox"/> NATURAL <input checked="" type="checkbox"/>	DEFINITION: layer below 17144, equalized w/ trench 3 similar materials to 17144 but slightly lighter color
	SU TYPE: <input checked="" type="checkbox"/> DEPOSIT <input type="checkbox"/> CUT <input type="checkbox"/> STRUCTURAL
	DISTINGUISHED BY: <input checked="" type="checkbox"/> COLOUR <input type="checkbox"/> COMPACTION <input checked="" type="checkbox"/> COMPOSITION

DEPOSIT: 1. Composition (sand/silt/clay) 2. Compaction 3. Colour 4. Clarity of Limits (clear/not clear/exc. lim. for N/S/W/E/depth) 5. Dimensions 6. Method & Conditions	STRUCTURAL: 1. Type (wall, cistern, etc.) 2. Orientation 3. Technique (pisé, ashlar, etc.) 4. Bonding Material 5. # of Coursings 6. Facing/Finish (plaster, etc.) 7. Dimensions 8. Related architectural features	DESCRIPTION: 1. silty clay 2. fairly loose 3. grey w/ black and brown mottling/patches 4. N/E clear, W/S exc. limit; depth clear 5. 4.95 x 1.73 m (see plan) 6. Pick, trowel, shovel. Sunny
---	--	--

OTHER OBSERVATIONS/COMMENTS:

- finding lots of bone, ceramic, tile, slag and metal
- Digging in the south corner, the 4th course and foundation of the wall was revealed. This will be the new context

MATRIX:

		17144	17157	
		17159	This context	
17161	17162	17160	17164	17163

STRATIGRAPHIC RELATIONSHIPS:		FILLS:
CUT:	BUTTED BY:	FILLED BY:
CUT BY:	COVERS: 17160, 17164, 17163	EQUAL TO:
ABUTS: 17161 17162	COVERED BY: 17144, 17157	BINDS TO:

ENVIRONMENTAL SAMPLES TAKEN: POLLEN SOIL CHARCOAL OTHER
 (specify): _____

SPECIAL FINDS N^{os}: 17507-526
533-550

INCLUSIONS: (check all that apply):
 METAL: F M R
 DAUB: F M R
 OTHER:
 MORTAR: F M R
 SLAG: F M R
 GLASS: F M R
 BONE: F M R
 CHARC.: F M R
 POTTERY: F M R
 BRICK/TILE: F M R
 WRKD STONE: F M R
 UNWRKD STONE: F M R

PHOTO N^{os}: 100-1090
100-1091
PHOTO MODEL N^{os}:

SKETCH OF PLAN INCLUDE: 1. North arrow; 2. Dimensions; 3. Sample locations (if relevant); 4. Levels; 5. Grid pts (if relevant); 6. Rise/Drop in surface level; 7. Abutting architecture/Adjacent or relevant nearby features for reference; 8. All SU N^{os}

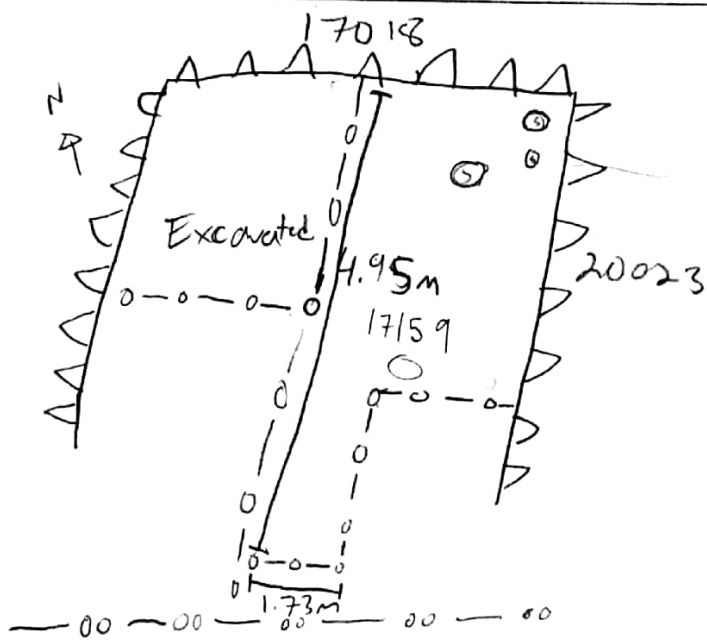

FIELD NOTEBOOK DRAWINGS - PAGE N^{os}	P 40				SECTION DRAWING N^{os}	
STRATIGRAPHIC RELIABILITY	HIGH			LOW	APPROX. DATE OF LAYER	
CONFIDENCE IN INTERPRETATION	(5)	4	3	2		
CONTAMINATION RISK	5	4	3	2	(1)	DATABLE MATERIALS

INTERPRETATION: This is a layer underneath 17144, which we believe was a destruction/occupation layer. This layer is occupation, and is right on top of the foundations of the wall (WL).
 I see this as a potential beaten earth floor on which occupation material in 17144 was found - beaten earth floor (?) (RGR)

ENTERED INTO DATABASE INITIALS: DATE: