

SITE CODE: MZ	DATE OPENED: 21 July	SU N°: 17162	MARZUOLO ARCHAEOLOGICAL PROJECT 
	DATE CLOSED: 22 July	AREA N°: 17000	
	INITIAL: WL		

FORMATION PROCESS:	DEFINITION: foundation of wall 1708
ANTHROPIC <input checked="" type="checkbox"/> NATURAL <input type="checkbox"/>	SU TYPE: <input type="checkbox"/> DEPOSIT <input type="checkbox"/> CUT <input checked="" type="checkbox"/> STRUCTURAL
	DISTINGUISHED BY: <input checked="" type="checkbox"/> COLOUR <input type="checkbox"/> COMPACTION <input checked="" type="checkbox"/> COMPOSITION

DEPOSIT: 1. Composition (sand/silt/clay) 2. Compaction 3. Colour 4. Clarity of Limits (clear/not clear/exc. lim. for N/S/W/E/depth) 5. Dimensions 6. Method & Conditions	STRUCTURAL: 1. Type (wall, cistern, etc.) 2. Orientation 3. Technique (pisé, ashlar, etc.) 4. Bonding Material 5. # of Coursings 6. Facing/Finish (plaster, etc.) 7. Dimensions 8. Related architectural features	DESCRIPTION: 1. wall foundation 2. NW-SE 3. foundation compaction 4. mortar 5. partially excavated, 1 visible 6. none 7. 3.45m length 8. 17018
---------------------------------------------------------------------------------------------------------------------------------------------------------------------------------------------------	--------------------------------------------------------------------------------------------------------------------------------------------------------------------------------------------------------------------------------------------------	-------------------------------------------------------------------------------------------------------------------------------------------------------------------------------

OTHER OBSERVATIONS/COMMENTS:

- rich in mortar and stones
- fill of cut abuts this foundation (17160) (17163) (17162)

MATRIX:

	17164	17018	17159	
		17162	This context	
		17165		

STRATIGRAPHIC RELATIONSHIPS:	FILLS:
CUT: 17165	BUTTED BY: 17164
CUT BY:	COVERS:
ABUTS:	COVERED BY: 17018, 17159
	FILLED BY:
	EQUAL TO:
	BINDS TO:

ENVIRONMENTAL SAMPLES TAKEN: POLLEN SOIL CHARCOAL OTHER
 (specify): _____

SPECIAL FINDS N^os:

INCLUSIONS: (check all that apply): MORTAR: F M R BONE: F M R BRICK/TILE: F M R
 METAL: F M R SLAG: F M R CHARC.: F M R WRKD STONE: F M R
 DAUB: F M R GLASS: F M R POTTERY: F M R UNWRKD STONE: F M R
 OTHER:

PHOTO N^os: 100-2223 PHOTO MODEL N^os:

SKETCH OF PLAN INCLUDE: 1. North arrow; 2. Dimensions; 3. Sample locations (if relevant); 4. Levels; 5. Grid pts (if relevant); 6. Rise/Drop in surface level; 7. Abutting architecture/Adjacent or relevant nearby features for reference; 8. All SU N^os

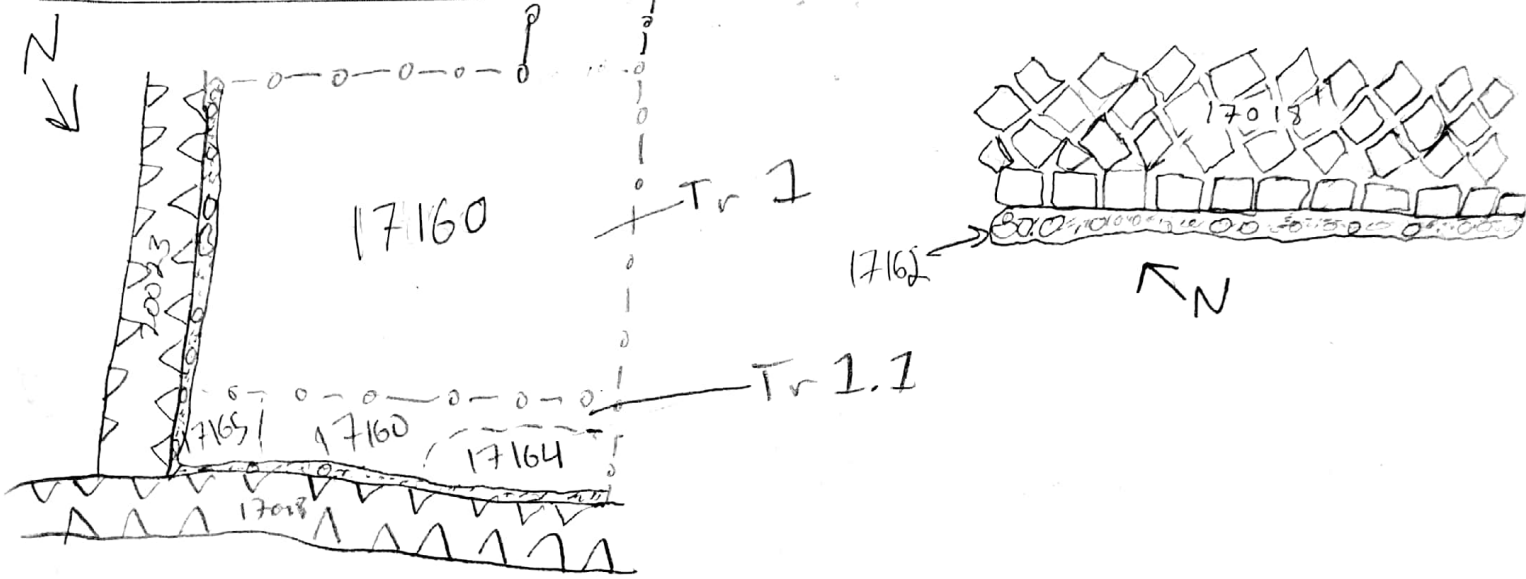

FIELD NOTEBOOK DRAWINGS - PAGE N ^o s						SECTION DRAWING N ^o s
STRATIGRAPHIC RELIABILITY	HIGH				LOW	APPROX. DATE OF LAYER
CONFIDENCE IN INTERPRETATION	5	4	3	2	1	DATABLE MATERIALS
CONTAMINATION RISK	5	4	3	2	1	

INTERPRETATION: Foundation for wall 17018, slightly protruding out from under the wall 17018.

ENTERED INTO DATABASE INITIALS: DATE: