

SITE CODE: MZ	DATE OPENED: 26 JUNE	SU No: 20002	MARZUOLO ARCHAEOLOGICAL PROJECT
	DATE CLOSED:	AREA No: 20000	
	INITIAL: JA		

FORMATION PROCESS: ANTHROPIC <input checked="" type="checkbox"/> NATURAL <input type="checkbox"/>	DEFINITION: opus reticulatum wall
	SU TYPE: <input type="checkbox"/> DEPOSIT <input type="checkbox"/> CUT <input checked="" type="checkbox"/> STRUCTURAL
	DISTINGUISHED BY: <input type="checkbox"/> COLOUR <input type="checkbox"/> COMPACTION <input type="checkbox"/> COMPOSITION

DEPOSIT: 1. Composition (sand/silt/clay) 2. Compaction 3. Colour 4. Clarity of Limits (clear/not clear/exc. lim. for N/S/W/E/depth) 5. Dimensions 6. Method & Conditions	STRUCTURAL: 1. Type (wall, cistern, etc.) 2. Orientation 3. Technique (pisé, ashlar, etc.) 4. Bonding Material 5. # of Coursings 6. Facing/Finish (plaster, etc.) 7. Dimensions 8. Related architectural features	DESCRIPTION: 1. WALL 2. NNW-SSE 3. opus quasi-reticulatum 4. white mortar 5. not excav. at this time 6. not excav. at this time 7. 118cm x 40cm; depth? 8. butted by wall 20006
CUT: 1. Shape in Plan 2. Top - BOS 3. Base - BOS 4. Sides 5. Orientation 6. Dimensions		

OTHER OBSERVATIONS/COMMENTS:
 opus reticulatum wall continues into area wall to east and may continue under pen tile filled w/ mortar and tile fragments (assoc. w/ restructuring of wall when wall 20006 was built to south). Concentration of pebbles and mortar cover wall (20012). Not clear if alignment parallels wall 20018 (= 17018)

MATRIX:

		20001		
		20002	This context	
		20006	20012	

STRATIGRAPHIC RELATIONSHIPS:

CUT:	BUTTED BY: 20006, 20007, 20008, 20014	FILLS:
CUT BY:	COVERS:	FILLED BY:
ABUTS:	COVERED BY: 20001 20012	EQUAL TO:
		BINDS TO:

ENVIRONMENTAL SAMPLES TAKEN: POLLEN SOIL CHARCOAL OTHER
 (specify): _____

SPECIAL FINDS N°s: SF 20-17

INCLUSIONS: (check all that apply):
 MORTAR: F M R BONE: F M R BRICK/TILE: F M R
 METAL: F M R SLAG: F M R CHARC.: F M R WRKD STONE: F M R
 DAUB: F M R GLASS: F M R POTTERY: F M R UNWRKD STONE: F M R
 OTHER:

PHOTO N°s 100-0641 **PHOTO MODEL N°s**

SKETCH OF PLAN INCLUDE: 1. North arrow; 2. Dimensions; 3. Sample locations (if relevant); 4. Levels; 5. Grid pts (if relevant); 6. Rise/Drop in surface level; 7. Abutting architecture/Adjacent or relevant nearby features for reference; 8. All SU N°s

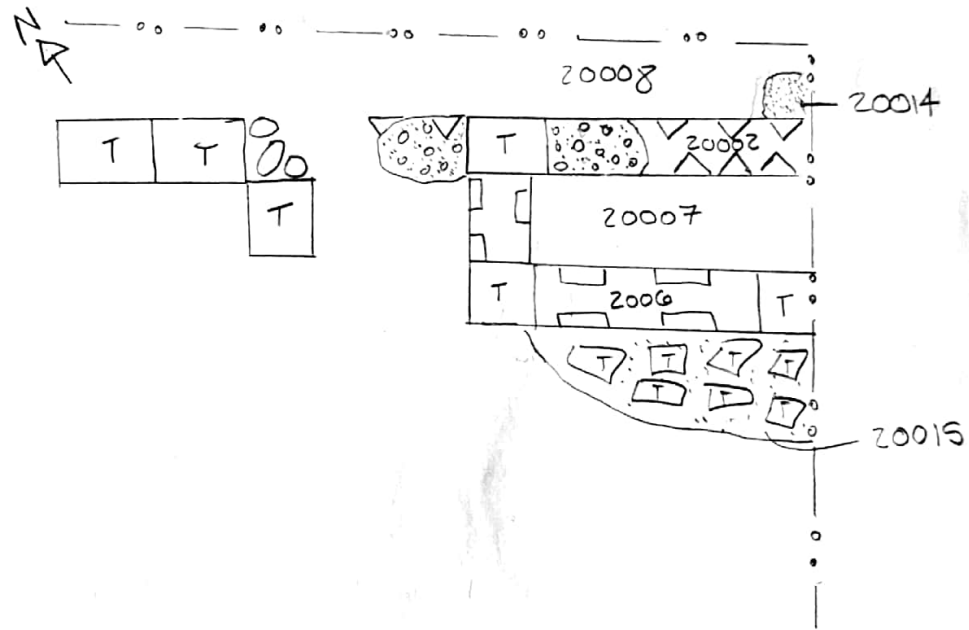

FIELD NOTEBOOK DRAWINGS - PAGE N°s	p. 3 p. 6 p. 8	SECTION DRAWING N°s	
STRATIGRAPHIC RELIABILITY	HIGH 5 (4) 3 2 1	LOW	
CONFIDENCE IN INTERPRETATION	5 (4) 3 2 1	APPROX. DATE OF LAYER	
CONTAMINATION RISK	5 (4) 3 2 1	DATABLE MATERIALS	

INTERPRETATION:
 Appears to be an opus quasi-reticulatum wall originally in phase with op. ret. complex in 17000, although alignment a little suspect. Wall incorporated into a second phase of use, covered with concentration of pebbles and mortar and levelled w/ partile filled w/ mortar and tile frag.

ENTERED INTO DATABASE **INITIALS:** TCH **DATE:** July 18, 2015