

SITE CODE: MZ	DATE OPENED: June 29	SU No: 20007	MARZUOLO ARCHAEOLOGICAL PROJECT 
	DATE CLOSED:	AREA No: 20000	
	INITIAL: WZ		

FORMATION PROCESS: ANTHROPIC <input type="checkbox"/> NATURAL <input checked="" type="checkbox"/>	DEFINITION: Brown soil deposit between 20002 and 20006
	SU TYPE: <input checked="" type="checkbox"/> DEPOSIT <input type="checkbox"/> CUT <input type="checkbox"/> STRUCTURAL
	DISTINGUISHED BY: <input checked="" type="checkbox"/> COLOUR <input checked="" type="checkbox"/> COMPACTION <input type="checkbox"/> COMPOSITION

DEPOSIT: 1. Composition (sand/silt/clay) 2. Compaction 3. Colour 4. Clarity of Limits (clear/not clear/exc. lim. for N/S/W/E/depth) 5. Dimensions 6. Method & Conditions	STRUCTURAL: 1. Type (wall, cistern, etc.) 2. Orientation 3. Technique (pisé, ashlar, etc.) 4. Bonding Material 5. # of Coursings 6. Facing/Finish (plaster, etc.) 7. Dimensions 8. Related architectural features	DESCRIPTION: 1. clay-silt 2. semi-compact 3. brown 4. N/S/W clear; E exc. limit; depth unknown 5. ca. 118' x 50 cm 6. unexcavated
CUT: 1. Shape in Plan 2. Top - BOS 3. Base - BOS 4. Sides 5. Orientation 6. Dimensions		

OTHER OBSERVATIONS/COMMENTS:
 Deposit abutting walls 20002 and 20006.

MATRIX:

		20005		
		20007	This context	
		20006	20002	

STRATIGRAPHIC RELATIONSHIPS:		FILLS:
CUT:	BUTTED BY:	FILLED BY:
CUT BY:	COVERS:	EQUAL TO:
ABUTS: 20006 20002	COVERED BY:	BINDS TO:

ENVIRONMENTAL SAMPLES TAKEN: POLLEN SOIL CHARCOAL OTHER
 (specify): _____

SPECIAL FINDS N^os:

INCLUSIONS: (check all that apply): MORTAR: F M R BONE: F M R BRICK/TILE: F M R
 METAL: F M R SLAG: F M R CHARC.: F M R WRKD STONE: F M R
 DAUB: F M R GLASS: F M R POTTERY: F M R UNWRKD STONE: F M R
 OTHER:

PHOTO N^os 100-0643 PHOTO MODEL N^os

SKETCH OF PLAN INCLUDE: 1. North arrow; 2. Dimensions; 3. Sample locations (if relevant); 4. Levels; 5. Grid pts (if relevant); 6. Rise/Drop in surface level; 7. Abutting architecture/Adjacent or relevant nearby features for reference; 8. All SU N^os

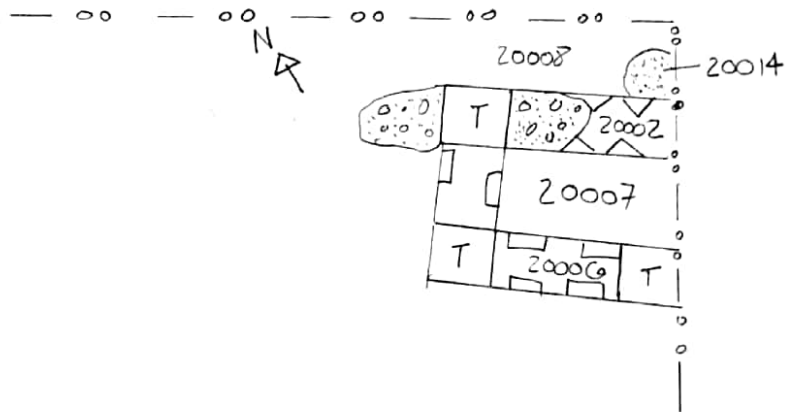

FIELD NOTEBOOK DRAWINGS - PAGE N ^o s	PG-8	SECTION DRAWING N ^o s	
STRATIGRAPHIC RELIABILITY	HIGH	LOW	APPROX. DATE OF LAYER
	5 4 3 (2) 1		
CONFIDENCE IN INTERPRETATION	5 4 3 2 (1)		DATABLE MATERIALS
CONTAMINATION RISK	5 (4) 3 2 1		

INTERPRETATION: unexcavated, and so all interpretations are very speculative. Could 20006 have been built abutting 20002 to create a tank? OR a possible small alley between two backing structures, but then why is it closed off on the west? EGV

ENTERED INTO DATABASE INITIALS: TCH DATE: JULY 15/2018