

SITE CODE: <b>MZ</b>	DATE OPENED: June 29	SU No: 20008	MARZUOLO ARCHAEOLOGICAL PROJECT <b>ANNE</b>
	DATE CLOSED:	AREA No: 20000	
	INITIAL: WZ		

FORMATION PROCESS:  ANTHROPIC <input type="checkbox"/> NATURAL <input checked="" type="checkbox"/>	DEFINITION: Med brown deposit north of wall 20002
	SU TYPE: <input checked="" type="checkbox"/> DEPOSIT <input type="checkbox"/> CUT <input type="checkbox"/> STRUCTURAL
	DISTINGUISHED BY: <input checked="" type="checkbox"/> COLOUR <input checked="" type="checkbox"/> COMPACTION <input checked="" type="checkbox"/> COMPOSITION

<b>DEPOSIT:</b>	<b>STRUCTURAL:</b>	<b>DESCRIPTION:</b>
<ol style="list-style-type: none"> <li>Composition (sand/silt/clay)</li> <li>Compaction</li> <li>Colour</li> <li>Clarity of Limits (clear/not clear/exc. lim. for N/S/W/E/depth)</li> <li>Dimensions</li> <li>Method &amp; Conditions</li> </ol>	<ol style="list-style-type: none"> <li>Type (wall, cistern, etc.)</li> <li>Orientation</li> <li>Technique (pisé, ashlar, etc.)</li> <li>Bonding Material</li> <li># of Coursings</li> <li>Facing/Finish (plaster, etc.)</li> <li>Dimensions</li> <li>Related architectural features</li> </ol>	<ol style="list-style-type: none"> <li>clay-silt</li> <li>semi compact</li> <li>med brown with reddish striations</li> <li>N/E = exc. limit W/S = clear</li> <li>ca 600 x 150 cm</li> <li>unexcavated</li> </ol>
<b>CUT:</b>		
<ol style="list-style-type: none"> <li>Shape in Plan</li> <li>Top - BOS</li> <li>Base - BOS</li> <li>Sides</li> <li>Orientation</li> <li>Dimensions</li> </ol>		

**OTHER OBSERVATIONS/COMMENTS:**  
 Fairly empty of material; more compact and lighter color near the wall where context mixes w/ mortar and wall materials.

<b>MATRIX:</b>	<input type="checkbox"/>	<input type="checkbox"/>	20005	<input type="checkbox"/>	<input type="checkbox"/>
			20008	This context	
	<input type="checkbox"/>	<input type="checkbox"/>	20002	<input type="checkbox"/>	<input type="checkbox"/>

<b>STRATIGRAPHIC RELATIONSHIPS:</b>		<b>FILLS:</b>
CUT:	BUTTED BY:	FILLED BY:
CUT BY:	COVERS:	EQUAL TO:
ABUTS: 20002	COVERED BY: 20005	BINDS TO:

**ENVIRONMENTAL SAMPLES TAKEN:**  POLLEN  SOIL  CHARCOAL  OTHER  
 (specify): \_\_\_\_\_

**SPECIAL FINDS N°s:**

**INCLUSIONS:** (check all that apply):  
 MORTAR:  F  M  R  
 METAL:  F  M  R  
 DAUB:  F  M  R  
 OTHER:  
 BONE:  F  M  R  
 SLAG:  F  M  R  
 GLASS:  F  M  R  
 POTTERY:  F  M  R  
 BRICK/TILE:  F  M  R  
 WRKD STONE:  F  M  R  
 UNWRKD STONE:  F  M  R

**PHOTO N°s** 100-0668-0669 **PHOTO MODEL N°s** N/A

**SKETCH OF PLAN** INCLUDE: 1. North arrow; 2. Dimensions; 3. Sample locations (if relevant); 4. Levels; 5. Grid pts (if relevant); 6. Rise/Drop in surface level; 7. Abutting architecture/Adjacent or relevant nearby features for reference; 8. All SU N°s

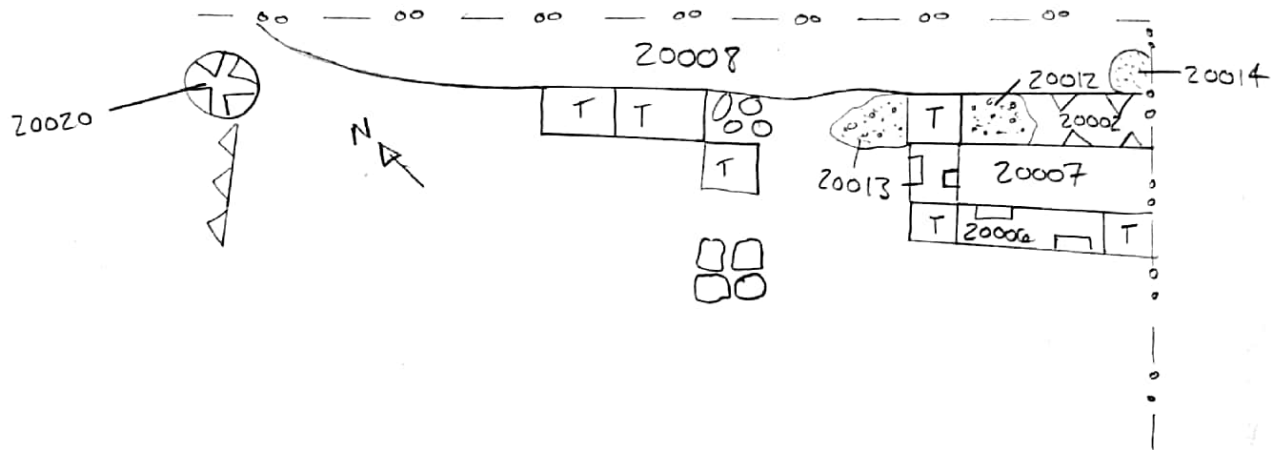

FIELD NOTEBOOK DRAWINGS - PAGE N°s	P. 8					SECTION DRAWING N°s	
	HIGH	4	3	2	LOW	APPROX. DATE OF LAYER	
STRATIGRAPHIC RELIABILITY	5	4	3	2	1		
CONFIDENCE IN INTERPRETATION	5	4	3	2	1	DATABLE MATERIALS	
CONTAMINATION RISK	5	4	3	2	1		

**INTERPRETATION:**  
 Possible accumulation in exterior space of complex.

**ENTERED INTO DATABASE** INITIALS: TCH **DATE:** July 18, 2018