

SITE CODE: MZ	DATE OPENED: June 29	SU No: 20010	MARZUOLO ARCHAEOLOGICAL PROJECT 
	DATE CLOSED: INITIAL: WZ	AREA No: 20000 TR-3	

FORMATION PROCESS: ANTHROPIC <input type="checkbox"/> NATURAL <input checked="" type="checkbox"/>	DEFINITION: soil w/ infrequent tile scattered throughout
	SU TYPE: <input checked="" type="checkbox"/> DEPOSIT <input type="checkbox"/> CUT <input type="checkbox"/> STRUCTURAL
	DISTINGUISHED BY: <input type="checkbox"/> COLOUR <input type="checkbox"/> COMPACTION <input checked="" type="checkbox"/> COMPOSITION

DEPOSIT: 1. Composition (sand/silt/clay) 2. Compaction 3. Colour 4. Clarity of Limits (clear/not clear/exc. lim. for N/S/W/E/depth) 5. Dimensions 6. Method & Conditions	STRUCTURAL: 1. Type (wall, cistern, etc.) 2. Orientation 3. Technique (pisé, ashlar, etc.) 4. Bonding Material 5. # of Coursings 6. Facing/Finish (plaster, etc.) 7. Dimensions 8. Related architectural features	DESCRIPTION: 1. clay-silt 2. compact 3. red brown 4. W clear N/S/E exc. limit; depth clear (ca. 2-3 cm) 5. ca 6 x 10 m (extends over E half of area) 6. Sunny w/ pick, trowel, shovel
CUT: 1. Shape in Plan 2. Top - BOS 3. Base - BOS 4. Sides 5. Orientation 6. Dimensions		

OTHER OBSERVATIONS/COMMENTS:
 Large pan tiles concentrated in center of context, perhaps covering wall connecting wall 20003 and 20004; context covers walls, parts removed in cleaning for photogrammetry. Darker patches w/ lots of material (amphora, bone, glass, TSI, etc.)

MATRIX:

		20005		
		20010	This context	
		20047		

STRATIGRAPHIC RELATIONSHIPS:		FILLS:
CUT:	BUTTED BY:	FILLED BY:
CUT BY:	COVERS: 20047	EQUAL TO:
ABUTS:	COVERED BY: 20005	BINDS TO:

ENVIRONMENTAL SAMPLES TAKEN: POLLEN SOIL CHARCOAL OTHER
 (specify): _____

SPECIAL FINDS N°s: 20-59, 20-60, 20-72, 20-73, 20-74

INCLUSIONS: (check all that apply):
 MORTAR: F M R BONE: F M R BRICK/TILE: F M R
 METAL: F M R SLAG: F M R CHARC.: F M R WRKD STONE: F M R
 DAUB: F M R GLASS: F M R POTTERY: F M R UNWRKD STONE: F M R
 OTHER:

PHOTO N°s 100-0701

PHOTO MODEL N°s

SKETCH OF PLAN INCLUDE: 1. North arrow; 2. Dimensions; 3. Sample locations (if relevant); 4. Levels; 5. Grid pts (if relevant); 6. Rise/Drop in surface level; 7. Abutting architecture/Adjacent or relevant nearby features for reference; 8. All SU N°s

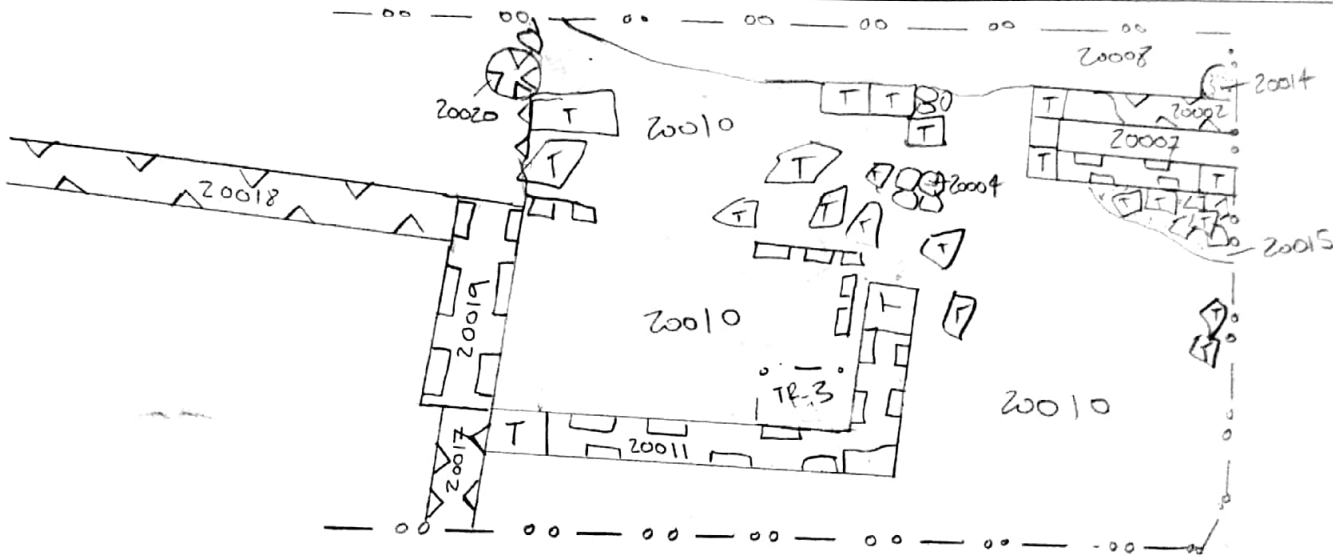

FIELD NOTEBOOK DRAWINGS - PAGE N°s	P. 39	SECTION DRAWING N°s	
STRATIGRAPHIC RELIABILITY	HIGH	LOW	APPROX. DATE OF LAYER
	5 4 (3) 2 1		
CONFIDENCE IN INTERPRETATION	5 4 (3) 2 1		DATABLE MATERIALS
CONTAMINATION RISK	5 (4) 3 2 1		

INTERPRETATION:

Top of a collapse? RGV.
 Possible occupation or abandonment layer over a floor of tile (?). RGV 11/2
 Excavating a 1x1m section AR-20 Tr-3. Extents taken w/m trench.

ENTERED INTO DATABASE

INITIALS: hn

DATE: 21 July 2018