

SITE CODE: <b>MZ</b>	DATE OPENED: 12 July 2018	SU N°: 20043	MARZUOLO ARCHAEOLOGICAL PROJECT 
	DATE CLOSED: 12 July 2018	AREA N°: 20000	
	INITIAL: MA		

FORMATION PROCESS: ANTHROPIC <input checked="" type="checkbox"/> NATURAL <input type="checkbox"/>	DEFINITION: deposit covered by 20035, <del>E of cut 20031,</del> equal to 20044
	SU TYPE: <input checked="" type="checkbox"/> DEPOSIT <input type="checkbox"/> CUT <input type="checkbox"/> STRUCTURAL
	DISTINGUISHED BY: <input type="checkbox"/> COLOUR <input type="checkbox"/> COMPACTION <input checked="" type="checkbox"/> COMPOSITION

DEPOSIT: 1. Composition (sand/silt/clay) 2. Compaction 3. Colour 4. Clarity of Limits (clear/not clear/exc. lim. for N/S/W/E/depth) 5. Dimensions 6. Method & Conditions	STRUCTURAL: 1. Type (wall, cistern, etc.) 2. Orientation 3. Technique (pisé, ashlar, etc.) 4. Bonding Material 5. # of Coursings 6. Facing/Finish (plaster, etc.) 7. Dimensions 8. Related architectural features	DESCRIPTION: 1. clay-silt 2. medium compaction 3. med-dark brown 4. clear NIS ; exc. limits E/W 5. 39 x 70cm 6. hand pick + trowel. Hot & sunny
CUT: 1. Shape in Plan 2. Top - BOS 3. Base - BOS 4. Sides 5. Orientation 6. Dimensions		

OTHER OBSERVATIONS/COMMENTS:  
- few material finds

MATRIX:

		20035		
	20041 =	20043	This context	
	20030	20044	20038	

STRATIGRAPHIC RELATIONSHIPS:	FILLS:
CUT:	BUTTED BY:
CUT BY: 20031	COVERS:
ABUTS:	COVERED BY: 20035
	FILLED BY: 20035
	EQUAL TO: 20041
	BINDS TO:

ENVIRONMENTAL SAMPLES TAKEN:  POLLEN  SOIL  CHARCOAL  OTHER  
(specify): \_\_\_\_\_

SPECIAL FINDS N<sup>os</sup>:

INCLUSIONS: (check all that apply): MORTAR:  F  M  R BONE:  F  M  R BRICK/TILE:  F  M  R  
 METAL:  F  M  R SLAG:  F  M  R CHARC.:  F  M  R WRKD STONE:  F  M  R  
 DAUB:  F  M  R GLASS:  F  M  R POTTERY:  F  M  R UNWRKD STONE:  F  M  R  
 OTHER:

PHOTO N<sup>os</sup>

100-0823

PHOTO MODEL N<sup>os</sup>

SKETCH OF PLAN

INCLUDE: 1. North arrow; 2. Dimensions; 3. Sample locations (if relevant); 4. Levels; 5. Grid pts (if relevant); 6. Rise/Drop in surface level; 7. Abutting architecture/Adjacent or relevant nearby features for reference; 8. All SU N<sup>os</sup>

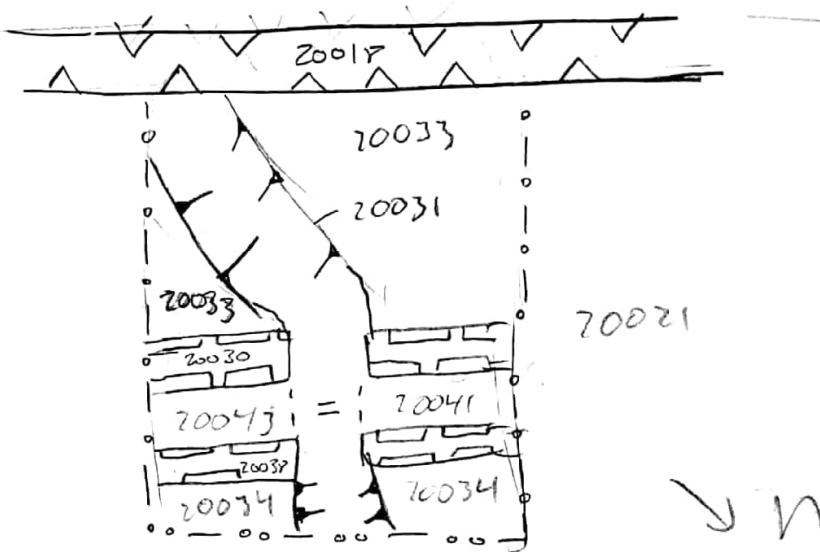

FIELD NOTEBOOK DRAWINGS - PAGE N<sup>os</sup>

SECTION DRAWING N<sup>os</sup>

STRATIGRAPHIC RELIABILITY

HIGH LOW

(5) 4 3 2 1

APPROX. DATE OF LAYER

CONFIDENCE IN INTERPRETATION

5 (4) 3 2 1

DATABLE MATERIALS

CONTAMINATION RISK

(5) 4 3 2 1

INTERPRETATION:

Very few material finds potentially another layer of fill between walls 20030 & 20038  
 upper fill of drain below disturbed corner tiles

ENTERED INTO DATABASE

INITIALS: NA

DATE: 21 July 2018