

SITE CODE: MZ	DATE OPENED: 12 July	SU No: 20039	MARZUOLO ARCHAEOLOGICAL PROJECT 
	DATE CLOSED: 13 July	AREA No: 20000	
	INITIAL: KG		

FORMATION PROCESS: ANTHROPIC <input type="checkbox"/> NATURAL <input checked="" type="checkbox"/>	DEFINITION: Collapse under 20028, 20036, 20037
	SU TYPE: <input checked="" type="checkbox"/> DEPOSIT <input type="checkbox"/> CUT <input type="checkbox"/> STRUCTURAL
	DISTINGUISHED BY: <input checked="" type="checkbox"/> COLOUR <input type="checkbox"/> COMPACTION <input checked="" type="checkbox"/> COMPOSITION

DEPOSIT: 1. Composition (sand/silt/clay) 2. Compaction 3. Colour 4. Clarity of Limits (clear/not clear/exc. lim. for N/S/W/E/depth) 5. Dimensions 6. Method & Conditions	STRUCTURAL: 1. Type (wall, cistern, etc.) 2. Orientation 3. Technique (pisé, ashlar, etc.) 4. Bonding Material 5. # of Coursings 6. Facing/Finish (plaster, etc.) 7. Dimensions 8. Related architectural features	DESCRIPTION: 1. Clayey-silty soil 2. Quite compact; sticky to pick (very compact) 3. Brown with yellow and red streaks and occasional white flecks 4. N/E clear; S/W exc. limits; depth clear 5. 4m x 2m; depth ca. 5-8cm 6. Sunny, with big pick, hand pick and trowel
---	--	--

OTHER OBSERVATIONS/COMMENTS:
 Although some patches were more brown, yellow, or charcoal-colored, we determined all belonged to the bottom of the collapse material (due to absence of big tile fragments, but continued presence of patches of charcoal). After a pass of ~5cm at the north end of trench, found edge of circular/oval feature, approx. 1m in diameter; switched to trowel & hand pick in that area.
 - Peeled off the coccio pesto surface (20048); equals 20077 N extension

MATRIX:

	20028	20037	20036	20061
		20039	This context	
20080	20079	20048	20049	20050

STRATIGRAPHIC RELATIONSHIPS:	FILLS:
CUT:	FILLED BY:
CUT BY:	COVERS: 20048, 20079, 20050, 20079, 20080
ABUTS: 20018, 20067, 20017	EQUAL TO: 20077
	COVERED BY: 20028, 20036, 20037, 20061
	BINDS TO:

ENVIRONMENTAL SAMPLES TAKEN: POLLEN SOIL CHARCOAL OTHER
 (specify): _____

SPECIAL FINDS N^os:

20-62, 20-63, 20-64, 20-67

INCLUSIONS: (check all that apply):

METAL: F M R
 DAUB: F M R

MORTAR: F M R
 SLAG: F M R
 GLASS: F M R

BONE: F M R
 CHARG.: F M R
 POTTERY: F M R

BRICK/TILE: F M R
 WRKD STONE: F M R
 UNWRKD STONE: F M R

OTHER: *cocciopesto (?)*

PHOTO N^os

100-817
100-819

PHOTO MODEL N^os

SKETCH OF PLAN

INCLUDE: 1. North arrow; 2. Dimensions; 3. Sample locations (if relevant); 4. Levels; 5. Grid pts (if relevant); 6. Rise/Drop in surface level; 7. Abutting architecture/Adjacent or relevant nearby features for reference; 8. All SU N^os

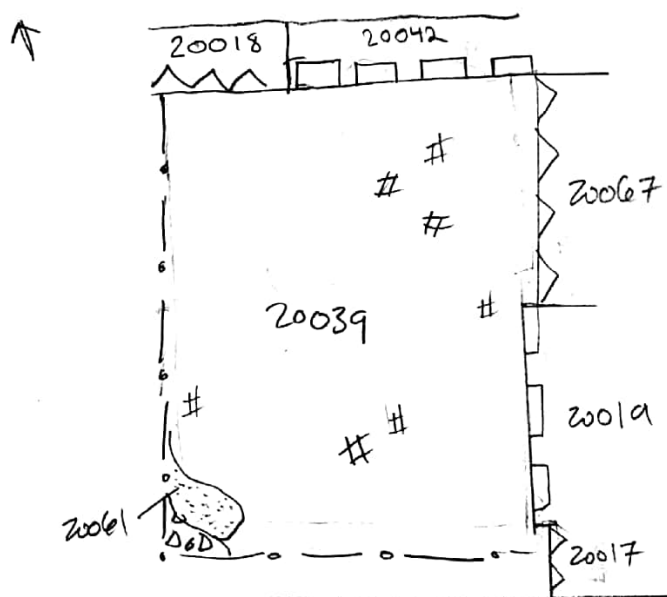

FIELD NOTEBOOK DRAWINGS - PAGE N ^o s	P. 24		SECTION DRAWING N ^o s	
STRATIGRAPHIC RELIABILITY	HIGH	LOW	APPROX. DATE OF LAYER	
CONFIDENCE IN INTERPRETATION	5	4	(3)	2
CONTAMINATION RISK	5	4	(4)	3
	5	4	3	(2)
			1	1
			1	1

INTERPRETATION:

Bottom of collapse. Accumulation of soil between the cocciopesto surface and the tile/beam collapse layer may indicate abandonment of area before destruction event. Charcoal patch in northeast corner of trench was evidence of further collapse material filling feature 20049. Cocciopesto fragment 20061 covers this context in SW corner

ENTERED INTO DATABASE	INITIALS: RGV	DATE: June 20, 2019
-----------------------	---------------	---------------------