

SITE CODE: MZ	DATE OPENED: 3 July	SU No: 20019	MARZUOLO ARCHAEOLOGICAL PROJECT 
	DATE CLOSED: 18 July		
	INITIAL: WL	AREA No: 20000	

FORMATION PROCESS:	DEFINITION: wall w/ large stones oriented NE-SW possibly built over 20017
ANTHROPIC <input checked="" type="checkbox"/> NATURAL <input type="checkbox"/>	SU TYPE: <input type="checkbox"/> DEPOSIT <input type="checkbox"/> CUT <input checked="" type="checkbox"/> STRUCTURAL
	DISTINGUISHED BY: <input checked="" type="checkbox"/> COLOUR <input checked="" type="checkbox"/> COMPACTION <input checked="" type="checkbox"/> COMPOSITION

DEPOSIT: 1. Composition (sand/silt/clay) 2. Compaction 3. Colour 4. Clarity of Limits (clear/not clear/exc. lim. for N/S/W/E/depth) 5. Dimensions 6. Method & Conditions	STRUCTURAL: 1. Type (wall, cistern, etc.) 2. Orientation 3. Technique (pisé, ashlar, etc.) 4. Bonding Material 5. # of Coursings 6. Facing/Finish (plaster, etc.) 7. Dimensions 8. Related architectural features	DESCRIPTION: 1. wall 2. NE-SW 3. river stone 4. mortar 5. one? 6. none 7. 60-65 cm x 385 cm; 12-15 cm depth 8. 20018 and 20067, 20017
CUT: 1. Shape in Plan 2. Top - BOS 3. Base - BOS 4. Sides 5. Orientation 6. Dimensions		

OTHER OBSERVATIONS/COMMENTS:
 July 10: only one course? Seems to be wider than 20017, destruction debris below.
 July 17: covering opus ret. 20067 and 20017, abutting 20042
 July 18: using large river stones and built over collapse material

MATRIX:

	20024	20005	20016	20022
		20019	This context	
		20017	20067	

STRATIGRAPHIC RELATIONSHIPS:	FILLS:
CUT:	FILLED BY:
CUT BY:	EQUAL TO:
ABUTS:	BINDS TO:

ENVIRONMENTAL SAMPLES TAKEN: POLLEN SOIL CHARCOAL OTHER
 (specify): _____

SPECIAL FINDS N°s:

INCLUSIONS: (check all that apply):
 MORTAR: F M R
 METAL: F M R
 DAUB: F M R
 OTHER:
 BONE: F M R
 SLAG: F M R
 GLASS: F M R
 POTTERY: F M R
 BRICK/TILE: F M R
 WRKD STONE: F M R
 UNWRKD STONE: F M R

PHOTO N°s 100-0779 (in progress)
 100-0926
 100-0881
PHOTO MODEL N°s

SKETCH OF PLAN **INCLUDE:** 1. North arrow; 2. Dimensions; 3. Sample locations (if relevant); 4. Levels; 5. Grid pts (if relevant); 6. Rise/Drop in surface level; 7. Abutting architecture/Adjacent or relevant nearby features for reference; 8. All SU N°s

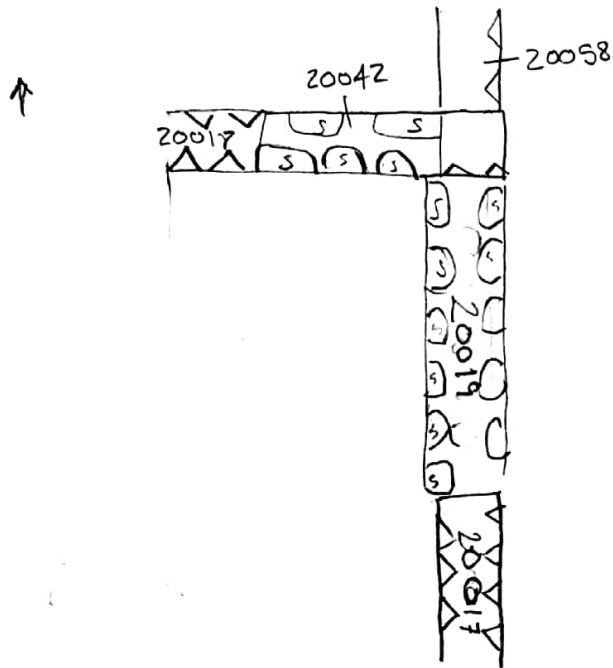

FIELD NOTEBOOK DRAWINGS - PAGE N°s	P.39 P.8					SECTION DRAWING N°s					
STRATIGRAPHIC RELIABILITY	HIGH	5	4	3	2	1	LOW	APPROX. DATE OF LAYER			
CONFIDENCE IN INTERPRETATION	5	4	3	2	1	5	4	3	2	1	DATA TABLE MATERIALS
CONTAMINATION RISK	5	4	3	2	1	5	4	3	2	1	

INTERPRETATION:
 Built on top of opus ret. wall 20017, using it as foundation and resting on collapse (which was either cut into, or leveled for wall construction. Part of restructuring of site after fire? Seems to be associated w/ room to the east, west side of wall showed no signs of post-destruction occupation

ENTERED INTO DATABASE **INITIALS:** NA **DATE:** 21 July 2018