

SITE CODE: <b>MZ</b>	DATE OPENED: 5 July	SU No: 20023	MARZUOLO ARCHAEOLOGICAL PROJECT 
	DATE CLOSED: INITIAL: RGV	AREA No: 20000	

FORMATION PROCESS:  ANTHROPIC <input checked="" type="checkbox"/> NATURAL <input type="checkbox"/>	DEFINITION: opus reticulatum wall
	SU TYPE: <input type="checkbox"/> DEPOSIT <input type="checkbox"/> CUT <input checked="" type="checkbox"/> STRUCTURAL
	DISTINGUISHED BY: <input type="checkbox"/> COLOUR <input type="checkbox"/> COMPACTION <input type="checkbox"/> COMPOSITION

<b>DEPOSIT:</b> 1. Composition (sand/silt/clay) 2. Compaction 3. Colour 4. Clarity of Limits (clear/not clear/exc. lim. for N/S/W/E/depth) 5. Dimensions 6. Method & Conditions	<b>STRUCTURAL:</b> 1. Type (wall, cistern, etc.) 2. Orientation 3. Technique (pisé, ashlar, etc.) 4. Bonding Material 5. # of Coursings 6. Facing/Finish (plaster, etc.) 7. Dimensions 8. Related architectural features	<b>DESCRIPTION:</b> 1. wall 2. NE-SW 3. Opus quasi-reticulatum 4. Mortar 5. 4 courses 6. none 7. 47-50cm width; ca 350cm length; 49 cm height 8. abuts 20018 (=17018) and equals 17002
		<b>CUT:</b> 1. Shape in Plan 2. Top - BOS 3. Base - BOS 4. Sides 5. Orientation 6. Dimensions

**OTHER OBSERVATIONS/COMMENTS:**  
 Continuation of opus reticulatum wall 17002 into Area 20000. Blacksmith's Workshop to the west.

**MATRIX:**

	17131	20005	17128	17130
		20023	This context	
		20018		

<b>STRATIGRAPHIC RELATIONSHIPS:</b>		<b>FILLS:</b>
CUT:	BUTTED BY: 17131, 17128, 17130, 17124, 17135, 17130, 17137, 17143, 17142,	FILLED BY:
CUT BY:	COVERS: 17144	EQUAL TO: 17002
ABUTS: 20018	COVERED BY: 20005	BINDS TO:

**ENVIRONMENTAL SAMPLES TAKEN:**  POLLEN  SOIL  CHARCOAL  OTHER  
 (specify): \_\_\_\_\_

**SPECIAL FINDS N°s:**

**INCLUSIONS:** (check all that apply):  
 MORTAR:  F  M  R    BONE:  F  M  R    BRICK/TILE:  F  M  R  
 METAL:  F  M  R    SLAG:  F  M  R    CHARC.:  F  M  R    WRKD STONE:  F  M  R  
 DAUB:  F  M  R    GLASS:  F  M  R    POTTERY:  F  M  R    UNWRKD STONE:  F  M  R  
 OTHER:

**PHOTO N°s** 100-1083-1085      **PHOTO MODEL N°s**

**SKETCH OF PLAN** **INCLUDE:** 1. North arrow; 2. Dimensions; 3. Sample locations (if relevant); 4. Levels; 5. Grid pts (if relevant); 6. Rise/Drop in surface level; 7. Abutting architecture/Adjacent or relevant nearby features for reference; 8. All SU N°s

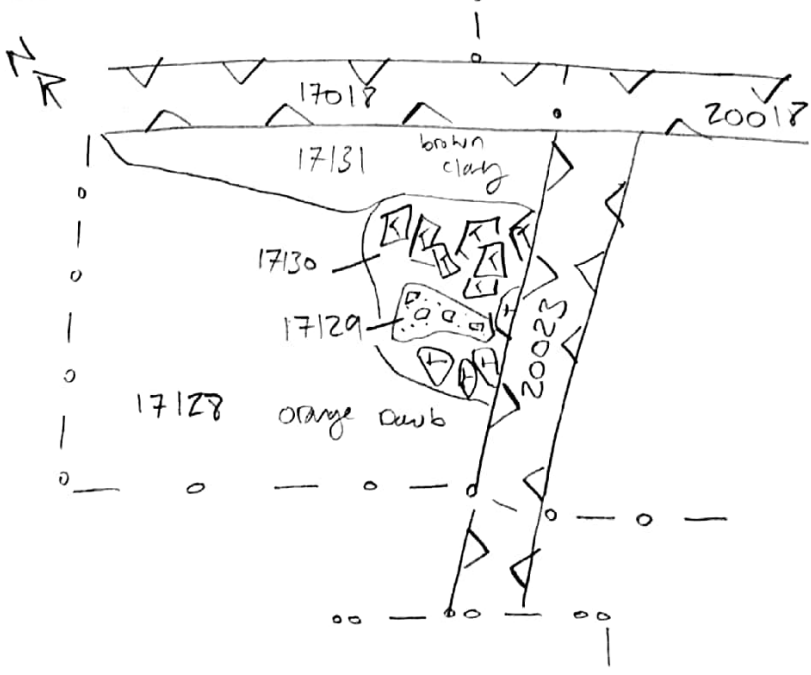

<b>FIELD NOTEBOOK DRAWINGS - PAGE N°s</b>	P.30 (and various)				<b>SECTION DRAWING N°s</b>	
<b>STRATIGRAPHIC RELIABILITY</b>	HIGH		LOW		<b>APPROX. DATE OF LAYER</b>	
<b>CONFIDENCE IN INTERPRETATION</b>	5	(4)	3	2	1	<b>DATABLE MATERIALS</b>
<b>CONTAMINATION RISK</b>	5	(4)	3	2	1	

**INTERPRETATION:**  
 opus quasi-reticulatum in phase with workshop complex, which was destroyed in the mid 1<sup>st</sup> c. CE.

**ENTERED INTO DATABASE**      **INITIALS:** N/A      **DATE:** 21 July 2018