

SITE CODE: MZ	DATE OPENED: 13 July	SU No: 20049	MARZUOLO ARCHAEOLOGICAL PROJECT 
	DATE CLOSED:	AREA No: 20000	
	INITIAL: KG		

FORMATION PROCESS: ANTHROPIC <input checked="" type="checkbox"/> NATURAL <input type="checkbox"/>	DEFINITION: Circular feature
	SU TYPE: <input type="checkbox"/> DEPOSIT <input type="checkbox"/> CUT <input checked="" type="checkbox"/> STRUCTURAL
	DISTINGUISHED BY: <input type="checkbox"/> COLOUR <input type="checkbox"/> COMPACTION <input checked="" type="checkbox"/> COMPOSITION

DEPOSIT: 1. Composition (sand/silt/clay) 2. Compaction 3. Colour 4. Clarity of Limits (clear/not clear/exc. lim. for N/S/W/E/depth) 5. Dimensions 6. Method & Conditions	STRUCTURAL: 1. Type (wall, cistern, etc.) 2. Orientation 3. Technique (pisé, ashlar, etc.) 4. Bonding Material 5. # of Coursings 6. Facing/Finish (plaster, etc.) 7. Dimensions 8. Related architectural features	DESCRIPTION: 1. Tank/container 2. N/A (round) 3. Coccio pesto lining 4. mortar 5. N/A 6. none 7. Top diameter: 120 cm; bottom diameter: 60 cm. Hgt: 97 cm Diameter ≈ 125 cm; depth = 8. Coccio pesto surface 20048; 20079 tank to W
---	--	---

OTHER OBSERVATIONS/COMMENTS:

Flooring appears to have been pasted on up the sides of 20049.
Matching feature (20079) found to West.
will take sample for future residue analysis

MATRIX:

	20082	20039	20080	
	20047	20049	This context	

STRATIGRAPHIC RELATIONSHIPS:		FILLS:
CUT:	BUTTED BY:	FILLED BY: 20049, 20063, 20070, 20075
CUT BY:	COVERS:	EQUAL TO:
ABUTS:	COVERED BY: 20039	BINDS TO: 20082, 20047

ENVIRONMENTAL SAMPLES TAKEN: POLLEN SOIL CHARCOAL OTHER
(specify): _____

SPECIAL FINDS Nos:

INCLUSIONS: (check all that apply): MORTAR: F M R BONE: F M R BRICK/TILE: F M R
 METAL: F M R SLAG: F M R CHARC.: F M R WRKD STONE: F M R
 DAUB: F M R GLASS: F M R POTTERY: F M R UNWRKD STONE: F M R
 OTHER:

PHOTO Nos: 100-0871 (SU photo)
100-1162 & 1170 (details) PHOTO MODEL Nos:

SKETCH OF PLAN INCLUDE: 1. North arrow; 2. Dimensions; 3. Sample locations (if relevant); 4. Levels; 5. Grid pts (if relevant); 6. Rise/Drop in surface level; 7. Abutting architecture/Adjacent or relevant nearby features for reference; 8. All SU Nos

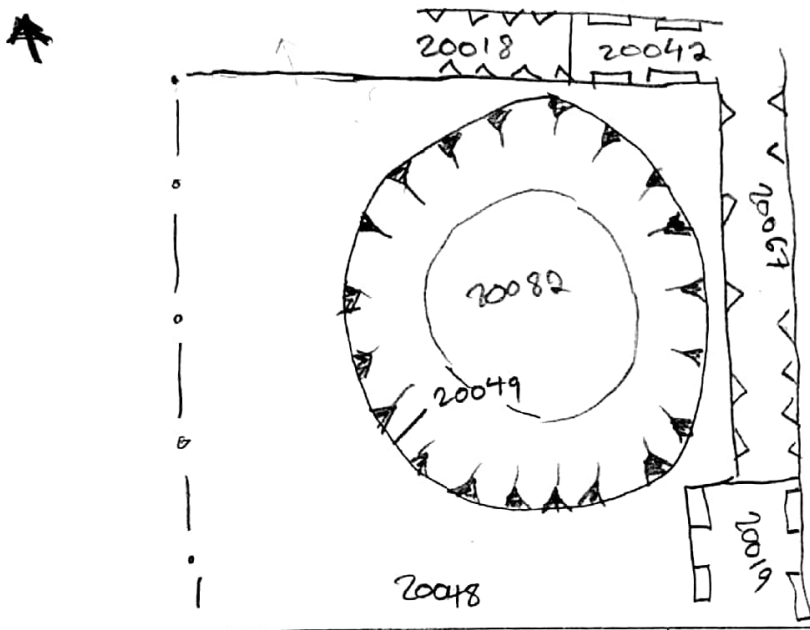

FIELD NOTEBOOK DRAWINGS - PAGE Nos	32, 35, 38, 39	SECTION DRAWING Nos	
STRATIGRAPHIC RELIABILITY	HIGH	LOW	APPROX. DATE OF LAYER
	(5) 4 3 2 1		
	(5) 4 3 2 1		DATABLE MATERIALS
CONTAMINATION RISK	5 4 3 2 (1)		

INTERPRETATION:
Tank for storage/production of liquid.

ENTERED INTO DATABASE INITIALS: DATE: