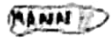

SITE CODE: MZ	DATE OPENED: 13 July	SU N°:	MARZUOLO ARCHAEOLOGICAL PROJECT 
	DATE CLOSED: 16 July	70050	
	INITIAL: KG	AREA N°: 70000	

FORMATION PROCESS: ANTHROPIC <input type="checkbox"/> NATURAL <input checked="" type="checkbox"/>	DEFINITION: <i>Collapse material filling 20049</i>
	SU TYPE: <input checked="" type="checkbox"/> DEPOSIT <input type="checkbox"/> CUT <input type="checkbox"/> STRUCTURAL
	DISTINGUISHED BY: <input type="checkbox"/> COLOUR <input type="checkbox"/> COMPACTION <input checked="" type="checkbox"/> COMPOSITION

DEPOSIT: 1. Composition (sand/silt/clay) 2. Compaction 3. Colour 4. Clarity of Limits (clear/not clear/exc. lim. for N/S/W/E/depth) 5. Dimensions 6. Method & Conditions	STRUCTURAL: 1. Type (wall, cistern, etc.) 2. Orientation 3. Technique (pisé, ashlar, etc.) 4. Bonding Material 5. # of Coursings 6. Facing/Finish (plaster, etc.) 7. Dimensions 8. Related architectural features	DESCRIPTION: 1. Clayey soil w/ freq. charcoal & tile inclusions 2. Soft & friable - easy to pick, but sticky 3. Black w/ reddish and yellow patches 4. Crystal clear (w/in 20049) 5. Approx. 125 cm diameter 6. Cloudy day, a few drops of rain Handpick, trowel & big pick
---	--	---

OTHER OBSERVATIONS/COMMENTS:
current hypothesis: charcoal fill caused by collapse material gathering in feature 20049
also found, pumice stone, red ochre(?), charcoal beams, tiles

MATRIX:

		20039		
		20050	This context	
		20049	20063	

STRATIGRAPHIC RELATIONSHIPS:		FILLS: 20049
CUT:	BUTTED BY:	FILLED BY:
CUT BY:	COVERS: 20063	EQUAL TO:
ABUTS:	COVERED BY: 20039	BINDS TO:

ENVIRONMENTAL SAMPLES TAKEN: POLLEN SOIL CHARCOAL OTHER
 (specify): *worked stone*

SPECIAL FINDS N^os:

20-70

INCLUSIONS: (check all that apply):
 MORTAR: F M R BONE: F M R
 METAL: F M R SLAG: F M R CHARC.: F M R BRICK/TILE: F M R
 DAUB: F M R GLASS: F M R POTTERY: F M R WRKD STONE: F M R
 OTHER: UNWRKD STONE: F M R

PHOTO N ^o s	100-0924 100-0927	100-0876 100-0879	PHOTO MODEL N ^o s
SKETCH OF PLAN	INCLUDE: 1. North arrow; 2. Dimensions; 3. Sample locations (if relevant); 4. Levels; 5. Grid pts (if relevant); 6. Rise/Drop in surface level; 7. Abutting architecture/Adjacent or relevant nearby features for reference; 8. All SU N ^o s		

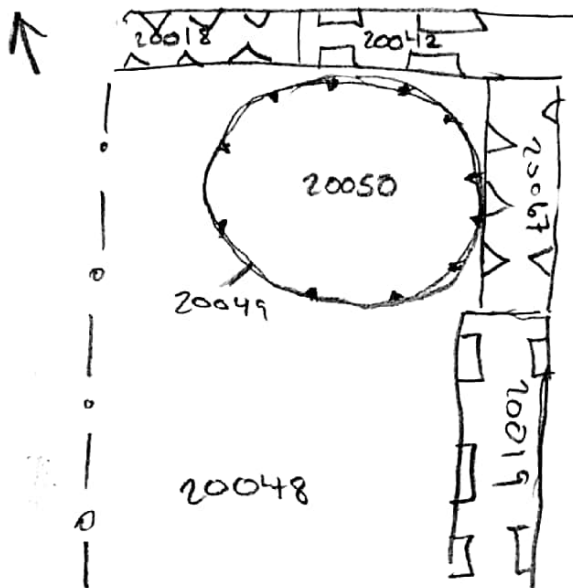

FIELD NOTEBOOK DRAWINGS - PAGE N ^o s	P. 32	SECTION DRAWING N ^o s
STRATIGRAPHIC RELIABILITY	HIGH ⑤ 4 3 2 1	APPROX. DATE OF LAYER
CONFIDENCE IN INTERPRETATION	⑤ 4 3 2 1	DATEABLE MATERIALS
CONTAMINATION RISK	5 4 3 2 ①	1 coin

INTERPRETATION:

Collapse material from destruction event that fell into the container sunken in the floor (SU 20049), which was only partially filled at the time of the collapse. Therefore should be equalized w/ collapse layers above (SU 20039, etc.). (KG)
 I would keep 20050 separate from 20039, as it was clearly w/m the boundary of the container, although agree that it is part of same collapse event (RGV)

ENTERED INTO DATABASE	INITIALS: RGV	DATE: June 21, 2019
-----------------------	---------------	---------------------