

SITE CODE: MZ	DATE OPENED: 13 July 2018	SU N°: 20051	MARZUOLO ARCHAEOLOGICAL PROJECT 
	DATE CLOSED: INITIAL: RGV	AREA N°: 20000	

FORMATION PROCESS:	DEFINITION: end pier, corner between 20052 tiles
ANTHROPIC <input checked="" type="checkbox"/> NATURAL <input type="checkbox"/>	SU TYPE: <input type="checkbox"/> DEPOSIT <input type="checkbox"/> CUT <input checked="" type="checkbox"/> STRUCTURAL
	DISTINGUISHED BY: <input type="checkbox"/> COLOUR <input type="checkbox"/> COMPACTION <input type="checkbox"/> COMPOSITION

DEPOSIT:	STRUCTURAL:	DESCRIPTION:
1. Composition (sand/silt/clay)	1. Type (wall, cistern, etc.)	1. end pier
2. Compaction	2. Orientation	2. N/A
3. Colour	3. Technique (pisé, ashlar, etc.)	3. Stone and mortar
4. Clarity of Limits (clear/not clear/exc. lim. for N/S/W/E/depth)	4. Bonding Material	4. mortar
5. Dimensions	5. # of Coursings	5. one visible
6. Method & Conditions	6. Facing/Finish (plaster, etc.)	6. none
CUT:	7. Dimensions	7. see GIS
1. Shape in Plan	8. Related architectural features	8. 20052
2. Top - BOS		
3. Base - BOS		
4. Sides		
5. Orientation		
6. Dimensions		

OTHER OBSERVATIONS/COMMENTS:
 3 large river stones set in mortar to make an end pier, although no clear wall associated w/ this feature.
 In alignment w/ 20052 tiles; which may be a wall?
 Similar to 20004

MATRIX:

		20001		
		20051	This context	

STRATIGRAPHIC RELATIONSHIPS:	FILLS:
CUT:	BUTTED BY: 20008 20010 20052
CUT BY:	FILLED BY:
ABUTS:	COVERS:
	EQUAL TO:
	COVERED BY: 20001
	BINDS TO:

ENVIRONMENTAL SAMPLES TAKEN: POLLEN SOIL CHARCOAL OTHER
 (specify): _____

SPECIAL FINDS N^os:

INCLUSIONS: (check all that apply):
 METAL: F M R
 DAUB: F M R
 OTHER:
 MORTAR: F M R
 SLAG: F M R
 GLASS: F M R
 BONE: F M R
 CHARC.: F M R
 POTTERY: F M R
 BRICK/TILE: F M R
 WRKD STONE: F M R
 UNWRKD STONE: F M R

PHOTO N^os: 100-0913 → 14
 100-0918
 PHOTO MODEL N^os

SKETCH OF PLAN
 INCLUDE: 1. North arrow; 2. Dimensions; 3. Sample locations (if relevant); 4. Levels; 5. Grid pts (if relevant); 6. Rise/Drop in surface level; 7. Abutting architecture/Adjacent or relevant nearby features for reference; 8. All SU N^os

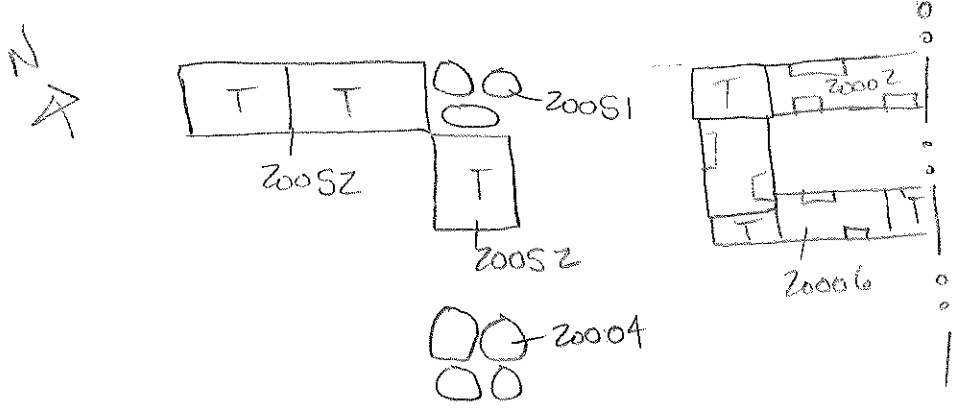

FIELD NOTEBOOK DRAWINGS - PAGE N ^o s	P 39				SECTION DRAWING N ^o s	
STRATIGRAPHIC RELIABILITY	HIGH			LOW	APPROX. DATE OF LAYER	
CONFIDENCE IN INTERPRETATION	5	4	3	2 (2)	1	
CONTAMINATION RISK	5 (5)	4	3	2	1	

INTERPRETATION:
 End store for a wall or pier?

ENTERED INTO DATABASE INITIALS: DATE: