

SITE CODE: MZ	DATE OPENED: 18 July 2018	SU N°: 20071	MARZUOLO ARCHAEOLOGICAL PROJECT 
	DATE CLOSED: 19 July	AREA N°: 20000	
	INITIAL: RM		

FORMATION PROCESS: ANTHROPIC <input type="checkbox"/> NATURAL <input checked="" type="checkbox"/>	DEFINITION: Dark red-brown deposit next to 20018 in Tk 1
	SU TYPE: <input checked="" type="checkbox"/> DEPOSIT <input type="checkbox"/> CUT <input type="checkbox"/> STRUCTURAL
	DISTINGUISHED BY: <input checked="" type="checkbox"/> COLOUR <input checked="" type="checkbox"/> COMPACTION <input type="checkbox"/> COMPOSITION

DEPOSIT: 1. Composition (sand/silt/clay) 2. Compaction 3. Colour 4. Clarity of Limits (clear/not clear/exc. lim. for N/S/W/E/depth) 5. Dimensions 6. Method & Conditions	STRUCTURAL: 1. Type (wall, cistern, etc.) 2. Orientation 3. Technique (pisé, ashlar, etc.) 4. Bonding Material 5. # of Coursings 6. Facing/Finish (plaster, etc.) 7. Dimensions 8. Related architectural features	DESCRIPTION: 1. Dense clay 2. Compact with small patches of less compact material 3. Dark red-brown, almost maroon 4. N: 20018, S: trench wall, W: trench wall, E: fairly clear 5. 55 cm N/S, 1.45 m W/E 6. Pick-axe, trowel; sunny, hot
---	--	---

OTHER OBSERVATIONS/COMMENTS:
 - a portion was removed during excavation of 20026 before extension of trench
 - denser clay near wall 20018

MATRIX:

		20068		
		20071	This context	
		20074		

STRATIGRAPHIC RELATIONSHIPS:	FILLS:
CUT:	BUTTED BY:
CUT BY:	FILLED BY:
ABUTS: 20018	COVERS: 20074
	EQUAL TO: 20026
	COVERED BY: 20068
	BINDS TO:

ENVIRONMENTAL SAMPLES TAKEN: POLLEN SOIL CHARCOAL OTHER
 (specify): _____

SPECIAL FINDS N^{os}:

INCLUSIONS: (check all that apply): MORTAR: F M R BONE: F M R BRICK/TILE: F M R
 METAL: F M R SLAG: F M R CHARC.: F M R WRKD STONE: F M R
 DAUB: F M R GLASS: F M R POTTERY: F M R UNWRKD STONE: F M R
 OTHER:

PHOTO N^{os} 100-8785 PHOTO MODEL N^{os}

SKETCH OF PLAN INCLUDE: 1. North arrow; 2. Dimensions; 3. Sample locations (if relevant); 4. Levels; 5. Grid pts (if relevant); 6. Rise/Drop in surface level; 7. Abutting architecture/Adjacent or relevant nearby features for reference; 8. All SU N^{os}

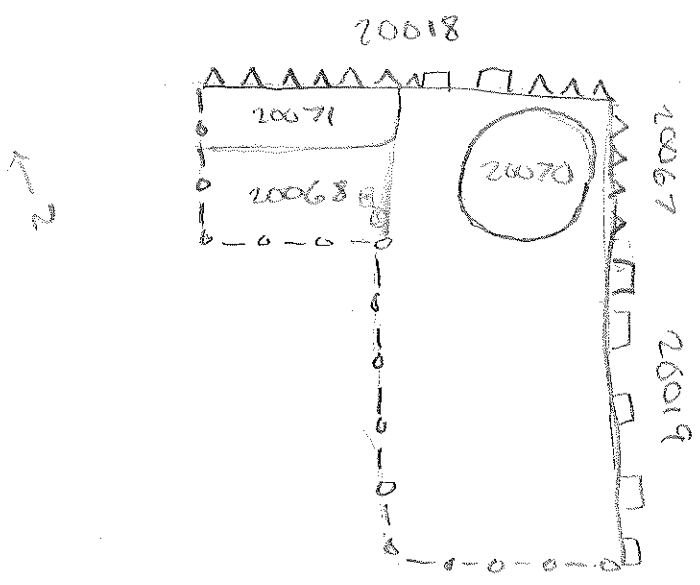

FIELD NOTEBOOK DRAWINGS - PAGE N ^{os}	p. 35 p. 37					SECTION DRAWING N ^{os}
STRATIGRAPHIC RELIABILITY	HIGH				LOW	APPROX. DATE OF LAYER
CONFIDENCE IN INTERPRETATION	5	(4)	3	2	1	DATABLE MATERIALS
CONTAMINATION RISK	5	4	(3)	2	1	

INTERPRETATION:
 Layer of collapse material with possible pisé causing change in color and compaction

ENTERED INTO DATABASE INITIALS: **RGV** DATE: **June 4, 2019**