

SITE CODE:

MZ

SU N°:

17215 Plan 3

MARZUOLO

ARCHAEOLOGICAL  
PROJECT

AREA N°:

17000

MARZUOLO

Date:

20th July 2022

Initials:

LN

Definition:

Surface inside &amp; outside the room, NE of cut 17217

**Sketch of Plan:** Include: 1. north arrow; 2. dimensions; 3. location of samples (if taken); 4. trench pts (if visible in plan); 5. slope (if relevant); 6. abutting architecture/adjacent or relevant features for reference; 7. numbers of all SUs visible in plan

Scale: 1sq =

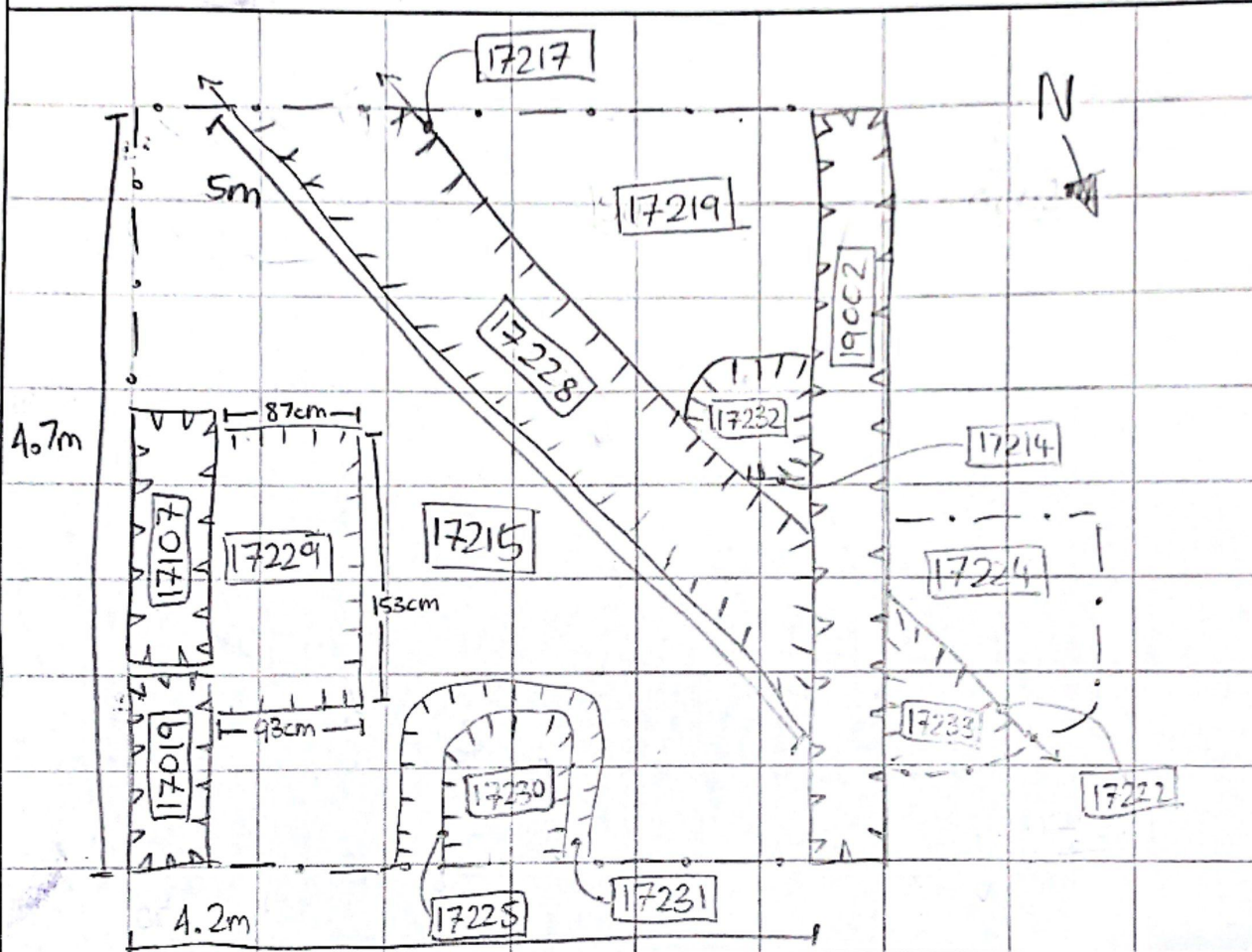

**Notes:** 17215 = 17219 = 17224 an early surface in area 17000  
Stratigraphic relationships suggest that 17215 is a pre building surface because it is cut by 17217, which is cut by the wall, 19002.  
The forge first presented as 17216, which was covered by 17215, but underneath that the forge depression (17225) is cut into a surface below 17215, 17231.

Date Uploaded to Database:

Initial:



Cornell University

UNIVERSITY OF  
ARKANSASTHE UNIVERSITY OF  
MELBOURNE

We only excavated 17215 in a section (87cm x 153cm x 93cm) and it was dug to the natural base silty clay ('chocolate') (SU 17229), at a depth of around 12-13cm.