

SITE CODE:

MZ

SU N°:

10153

MARZUOLO  
ARCHAEOLOGICAL  
PROJECT



AREA N°:

10000

Date: 15 July, 2024

Initials: Jm, mN, mV

Definition: pebbled floor in TR 3

**Sketch of Plan:** Include: 1. north arrow; 2. dimensions; 3. location of samples (if taken); 4. trench pts (if visible in plan); 5. slope (if relevant); 6. abutting architecture/adjacent or relevant features for reference; 7. numbers of all SUs visible in plan

Scale: 1sq =

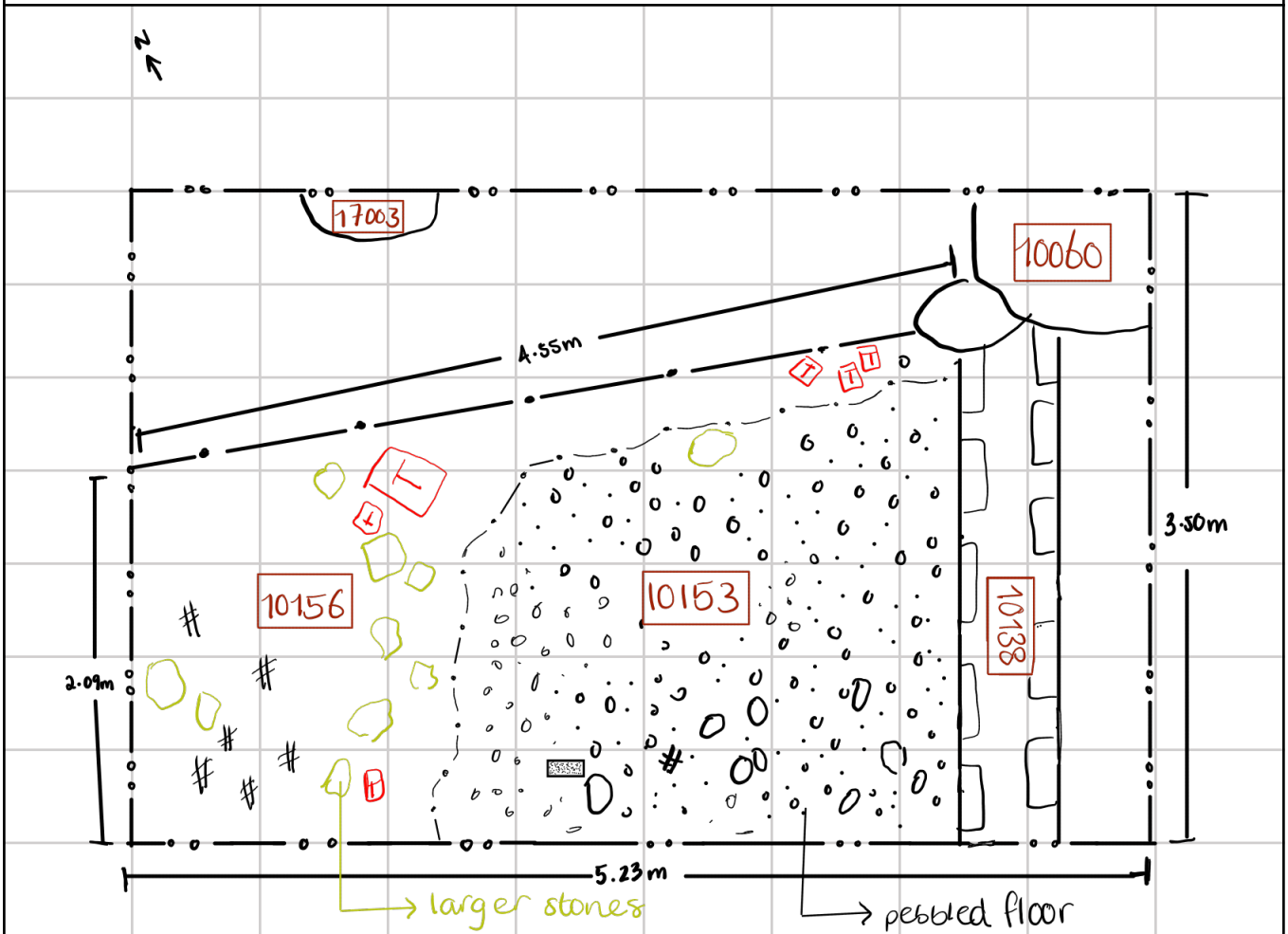

**Notes:**  
10153 = surface consisting of small & medium river pebbles, with layer stones placed in some locations. The surface covers a clayey compact layer with lots of tiles, ceramics, & charcoal.

Plan checked by staff/director:  (initials)

Plan uploaded to database:  (initials)



Cornell University

Radboud University



UNIVERSITY OF  
ARKANSAS



THE UNIVERSITY OF  
MELBOURNE