

SITE CODE:

MZ

SU N°:

SU 23033

MARZUOLO  
ARCHAEOLOGICAL  
PROJECT



AREA N°:

23000

Date: 24 JULY 2024

Initials: JP

Definition: Sondage section NE of trench 3 as trench 3A.

**Sketch of Plan:** Include: 1. north arrow; 2. dimensions; 3. location of samples (if taken); 4. trench pts (if visible in plan); 5. slope (if relevant); 6. abutting architecture/adjacent or relevant features for reference; 7. numbers of all SUs visible in plan

Scale: 1sq = 4 m

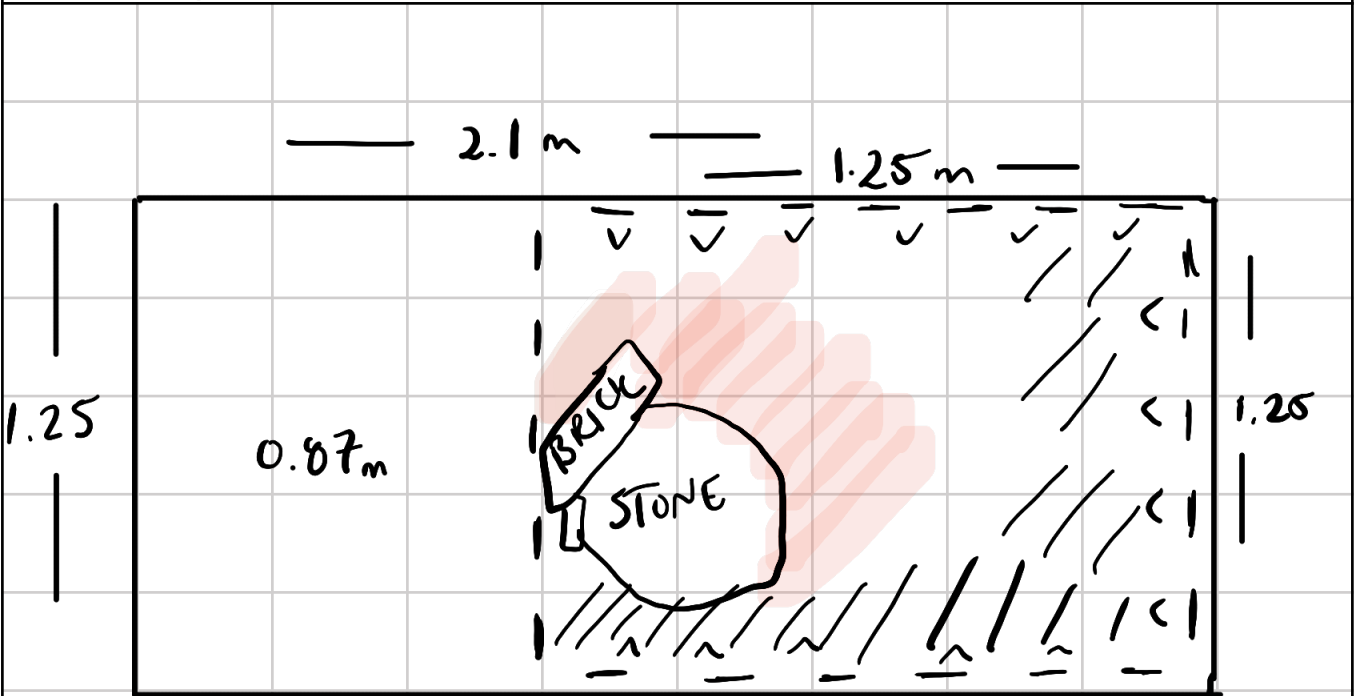

= mudbrickly soil

= emptier soil



Notes:  
• brickly terracotta soil concentrated around large fragmental materials; remaining soil consist  $\bar{v}$  terracotta & charcoal  
• stone dimensions  $\sim 42 \times 25$  cm  
fuchs / frequentation

Plan checked by staff/director: JP (initials)

Plan uploaded to database: (initials)