

SITE CODE: MZ	DATE OPENED: 30 June	SU No: NW 17023	MARZUOLO ARCHAEOLOGICAL PROJECT NAME
DATE CLOSED:	INITIAL: CY, OA	AREA No: 17001	
CANCELED			

FORMATION PROCESS: ANTHROPIC <input type="checkbox"/> NATURAL <input checked="" type="checkbox"/>	DEFINITION: Rectangular cut of clay material - Western end of NW.
	SU TYPE: <input type="checkbox"/> DEPOSIT <input type="checkbox"/> <input checked="" type="checkbox"/> CUT <input type="checkbox"/> STRUCTURAL
	DISTINGUISHED BY: <input checked="" type="checkbox"/> COLOR <input type="checkbox"/> COMPACTION <input type="checkbox"/> COMPOSITION

- | | |
|---|--|
| DEPOSIT:
1. Colour
2. Compaction
3. Composition
4. Inclusions (freq/med/rare)
5. Dimensions/Shape
6. Clarity of Limits (clear/not clear)
7. Fill of
8. Method & Conditions | STRUCTURAL:
1. Type (wall, cistern, etc.)
2. Technique (pisé, ashlar, etc.)
3. # of Coursings
4. Bonding Material
5. Facing/Finish (plaster, etc.)
6. Orientation
7. Dimensions
8. Abuts/butted by
9. Related architectural features |
| CUT:
1. Shape in Plan
2. Top - BOS
3. Base - BOS
4. Sides
5. Orientation
6. Dimensions
7. Fill Nos | |

DESCRIPTION:

1. rectangle
- 2
- 3
- 4
- 5
- 6
- 7
8. SU 17015

INTERPRETATION/DISCUSSION:

CANCELED

MATRIX:

		17021		
		17023	This context	

STRATIGRAPHIC RELATIONSHIPS:	FILLS:
CUT:	BUTTED BY:
CUT BY:	FILLED BY:
ABUTS:	COVERS:
	EQUAL TO:
	COVERED BY:
	BINDS TO:

CANCELED

ENVIRONMENTAL SAMPLES: POLLEN SOIL CHARCOAL OTHER
 (specify): _____

SPECIAL FINDS N°s:		FINDS TYPE: NONE <input type="checkbox"/> POTTERY <input type="checkbox"/> BRICK/TILE <input type="checkbox"/> METAL <input type="checkbox"/>		SLAG <input type="checkbox"/> GLASS <input type="checkbox"/> BONE <input type="checkbox"/> LEATHER <input type="checkbox"/> MORTAR <input type="checkbox"/>		DAUB <input type="checkbox"/> WRKD WOOD <input type="checkbox"/> WRKD STONE <input type="checkbox"/> OTHER (specify):	
PHOTO N°s	101-5778 101-5779	PHOTO MODEL N°s					
SKETCH OF PLAN	INCLUDE: 1. North Arrow; 2. Dimensions; 3. Sample Locations (if relevant); 4. Levels; 5. Grid Pts (if relevant); 6. Rise/Drop in Surface Level; 7. Abutting Architecture/Adjacent or Relevant Nearby Features for Reference; 8. All SU N°s						

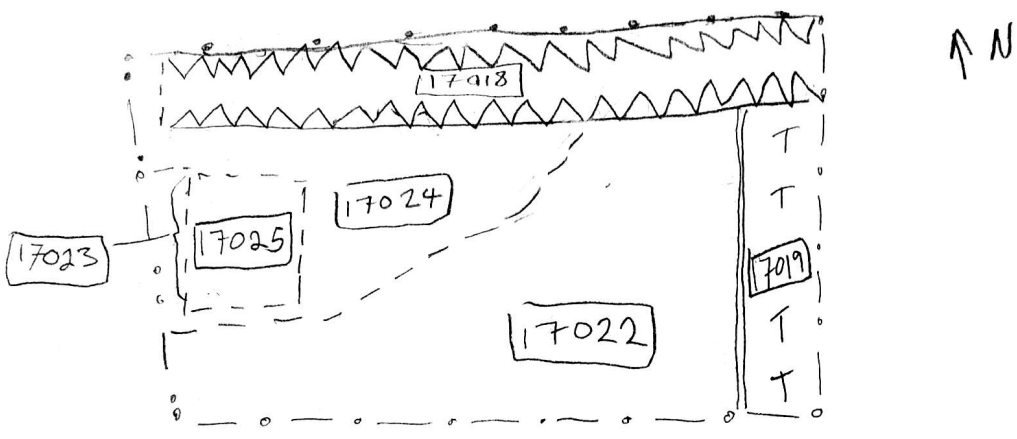

CANCELED

FIELD NOTEBOOK DRAWINGS - PAGE N°s	ps. 6	PROFILE DRAWING N°s	
STRATIGRAPHIC RELIABILITY	LOW	HIGH	APROX. DATE OF LAYER
	1 2 3 4 5	1 2 3 4 5	
CONFIDENCE IN INTERPRETATION	1 2 3 4 5		DATABLE MATERIALS
CONTAMINATION RISK	1 2 3 4 5		

COMMENTS/OBSERVATIONS:

CANCELED

ENTERED INTO DATABASE	INITIALS: CC	DATE: 12-7-17
------------------------------	---------------------	----------------------