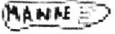

Excavation; INTERP

CANCELLED RESURRECTED ✓

SITE CODE: MZ	DATE OPENED: 3 July	SU N°: 17028	MARZUOLO ARCHAEOLOGICAL PROJECT 
	DATE CLOSED:	AREA N°: 17000	
	INITIAL: AK		

FORMATION PROCESS: ANTHROPIC <input checked="" type="checkbox"/> NATURAL <input type="checkbox"/>	DEFINITION: cut of 17008 fill - charcoal
	SU TYPE: <input type="checkbox"/> DEPOSIT <input type="checkbox"/> <input checked="" type="checkbox"/> CUT <input type="checkbox"/> STRUCTURAL
	DISTINGUISHED BY: <input checked="" type="checkbox"/> COLOR <input type="checkbox"/> COMPACTION <input type="checkbox"/> COMPOSITION

DEPOSIT: 1. Colour 2. Compaction 3. Composition 4. Inclusions (freq/med/rare) 5. Dimensions/Shape 6. Clarity of Limits (clear/not clear) 7. Fill of 8. Method & Conditions	STRUCTURAL: 1. Type (wall, cistern, etc.) 2. Technique (pisé, ashlar, etc.) 3. # of Coursings 4. Bonding Material 5. Facing/Finish (plaster, etc.) 6. Orientation 7. Dimensions 8. Abuts/butted by 9. Related architectural features	DESCRIPTION: 1. oval 2. vertical 3. slight slope 4. 90°, except to east where there is a shallow slope into pit. 5. E-W 6. approx. 1 x 1 m 7. 17008 = 17029 17034
CUT: 1. Shape in Plan 2. Top - BOS 3. Base - BOS 4. Sides 5. Orientation 6. Dimensions 7. Fill N°s		

INTERPRETATION/DISCUSSION:
 Once 17008 and 17034 removed, revealed clay bottom, but stratigraphy showed layers not present during excavation (including a pebbled surface on the northern and southern extents of the cut.) This cut appeared to be filled with charcoal^{ash} and vessels, not all with evidence of burning.
 CUT belongs to post collapse, use phase; opening probably to the East.

MATRIX:

<input type="checkbox"/>	17008	17034	<input type="checkbox"/>	<input type="checkbox"/>
		17028	This context	
<input type="checkbox"/>	17042	17096	17011	<input type="checkbox"/>

STRATIGRAPHIC RELATIONSHIPS:		FILLS:
CUT: 17096 17011 17042	BUTTED BY:	FILLED BY: 17008, 17034
CUT BY:	COVERS: 17050	EQUAL TO:
ABUTS:	COVERED BY: 17008	BINDS TO:

ENVIRONMENTAL SAMPLES: POLLEN SOIL CHARCOAL OTHER
 (specify): _____

SPECIAL FINDS N^os:

FINDS TYPE:

- NONE
- POTTERY
- BRICK/TILE
- METAL

- SLAG
- GLASS
- BONE
- LEATHER
- MORTAR

- DAUB
- WRKD WOOD
- WRKD STONE
- OTHER (specify):

PHOTO N^os

101-5352 101-5353
 101-5354 101-5355-6001
 101-5355

PHOTO MODEL N^os

SKETCH OF PLAN

INCLUDE: 1. North Arrow; 2. Dimensions; 3. Sample Locations (if relevant); 4. Levels; 5. Grid Pts (if relevant); 6. Rise/Drop in Surface Level; 7. Abutting Architecture/Adjacent or Relevant Nearby Features for Reference; 8. All SU N^os

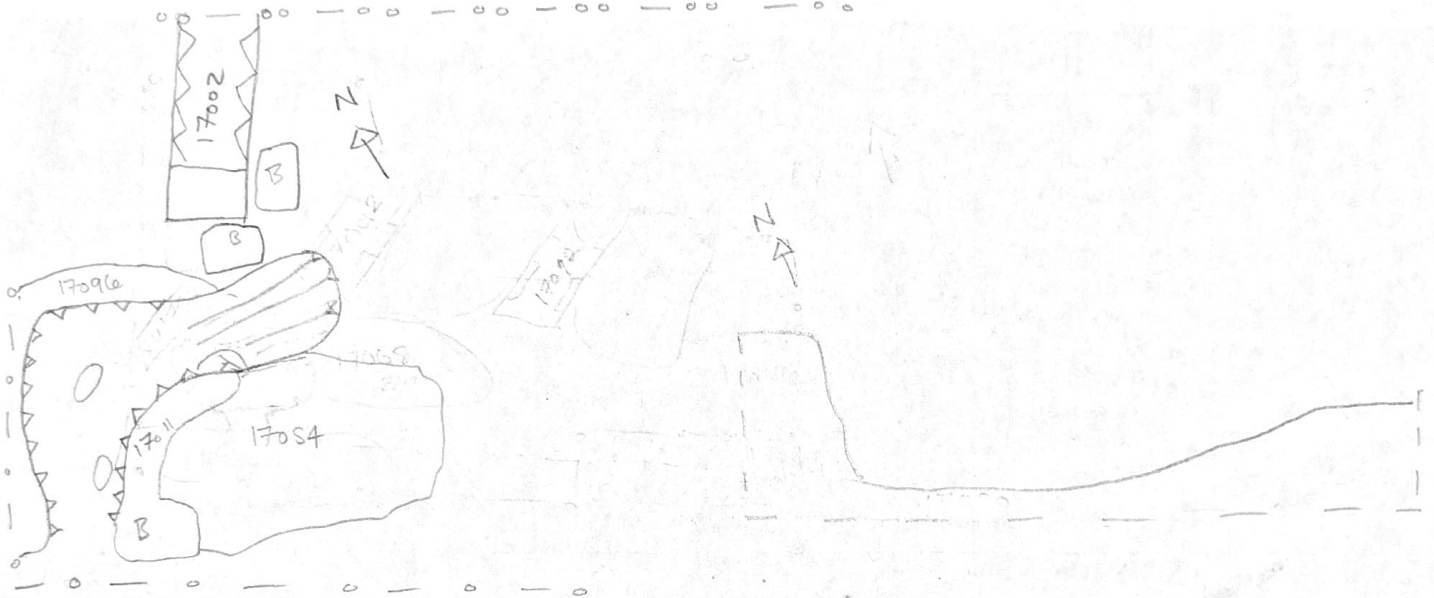

FIELD NOTEBOOK DRAWINGS - PAGE N^os

28

PROFILE DRAWING N^os

STRATIGRAPHIC RELIABILITY

LOW		HIGH		
1	2	3	4	5

APROX. DATE OF LAYER

CONFIDENCE IN INTERPRETATION

1	2	3	4	5
---	---	---	---	---

DATABLE MATERIALS

CONTAMINATION RISK

1	2	3	4	5
---	---	---	---	---

COMMENTS/OBSERVATIONS:

110
 orangy brown (brick?)
 grey
 dark grey/brown
 brown
 charcoal
 orange pebbles
 chalk/kaolin?
 (North profile)

Small holes in profile - channels? Same as channel found excavating 17091?

ENTERED INTO DATABASE

INITIALS: DV

DATE: 18 July 17