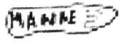

Def/Relation/Interp/OSCEV

SITE CODE: MZ	DATE OPENED: 4 July	SU No: 17031 SE	MARZUOLO ARCHAEOLOGICAL PROJECT 
	DATE CLOSED: 5 July	AREA No: 17000	
	INITIAL: AK		

FORMATION PROCESS: ANTHROPIC <input type="checkbox"/> NATURAL <input checked="" type="checkbox"/>	DEFINITION: orangy brown deposit beneath 17014 abutting inside of 17013
	SU TYPE: <input checked="" type="checkbox"/> DEPOSIT <input type="checkbox"/> <input type="checkbox"/> CUT <input type="checkbox"/> STRUCTURAL
	DISTINGUISHED BY: <input checked="" type="checkbox"/> COLOR <input type="checkbox"/> COMPACTION <input type="checkbox"/> COMPOSITION

DEPOSIT:	STRUCTURAL:	DESCRIPTION:
<ol style="list-style-type: none"> Colour Compaction Composition Inclusions (freq/med/rare) Dimensions/Shape Clarity of Limits (clear/not clear) Fill of Method & Conditions 	<ol style="list-style-type: none"> Type (wall, cistern, etc.) Technique (pisé, ashlar, etc.) # of Coursings Bonding Material Facing/Finish (plaster, etc.) Orientation Dimensions Abuts/butted by Related architectural features 	<ol style="list-style-type: none"> Orange-brown soft/loose in middle, more compact on edges clay-silt stone-frequent, med. small tile, but little else NS 1.2m EW 1m S/E/W - clear; N = trench limit / pickaxe, small pickaxe, trowel, sunny
CUT:		
<ol style="list-style-type: none"> Shape in Plan Top - BOS Base - BOS Sides Orientation Dimensions Fill Nos 		

INTERPRETATION/DISCUSSION:
 mixed in with stone, bits of broken tile
 orangey-brown deposit inside BACINO (17013) covers a deposit of charcoal and carbonized wood at N end of trench.
 removal revealed a well preserved back wall of a bacino
 no material however similar to...

MATRIX:

<input type="checkbox"/>	<input type="checkbox"/>	17014	<input type="checkbox"/>	<input type="checkbox"/>
		17031	This context	
<input type="checkbox"/>	<input type="checkbox"/>	17033	17013	<input type="checkbox"/>

STRATIGRAPHIC RELATIONSHIPS:		FILLS: 17015
CUT:	BUTTED BY:	FILLED BY:
CUT BY:	COVERS: 17033	EQUAL TO:
ABUTS: 17013	COVERED BY: 17014	BINDS TO:

ENVIRONMENTAL SAMPLES: POLLEN SOIL CHARCOAL OTHER
 (specify): _____

SPECIAL FINDS N°s:	FINDS TYPE:	SLAG <input type="checkbox"/>	DAUB <input type="checkbox"/>
	NONE <input type="checkbox"/>	GLASS <input type="checkbox"/>	WRKD WOOD <input type="checkbox"/>
	POTTERY <input type="checkbox"/>	BONE <input type="checkbox"/>	WRKD STONE <input type="checkbox"/>
	BRICK/TILE <input checked="" type="checkbox"/>	LEATHER <input type="checkbox"/>	OTHER (specify):
	METAL <input type="checkbox"/>	MORTAR <input type="checkbox"/>	

PHOTO N°s	101-5484 101-5485	PHOTO MODEL N°s	104
------------------	----------------------	------------------------	-----

SKETCH OF PLAN INCLUDE: 1. North Arrow; 2. Dimensions; 3. Sample Locations (if relevant); 4. Levels; 5. Grid Pts (if relevant); 6. Rise/Drop in Surface Level; 7. Abutting Architecture/Adjacent or Relevant Nearby Features for Reference; 8. All SU N°s

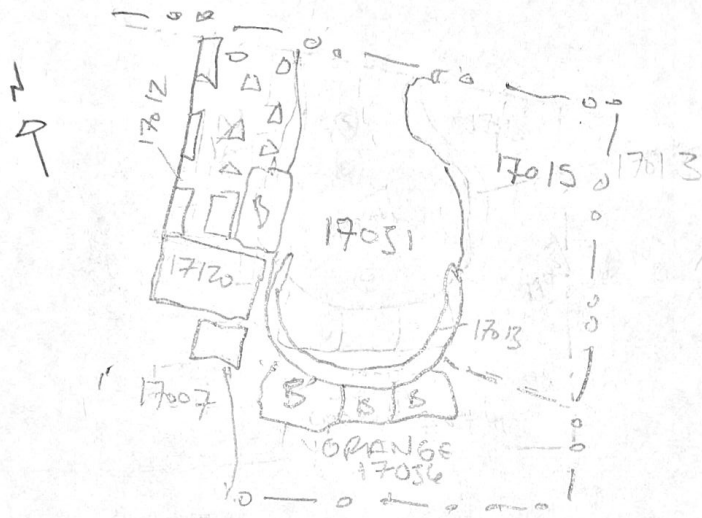

FIELD NOTEBOOK DRAWINGS - PAGE N°s		PROFILE DRAWING N°s	
STRATIGRAPHIC RELIABILITY	LOW	HIGH	APROX. DATE OF LAYER
	1 2 3 4 5	1 2 3 4 5	
CONFIDENCE IN INTERPRETATION	1 2 3 4 5	DATEABLE MATERIALS	
CONTAMINATION RISK	1 2 3 4 5		

COMMENTS/OBSERVATIONS:

- closed when we found dense charcoal deposit in N section which this SU covers.
- originally interpreted as fill of a kiln
- most likely assoc. w/ collapse or post collapse use phase of Bacio (RGV - 24 July)

ENTERED INTO DATABASE	INITIALS: AK	DATE: 9 July 2017
------------------------------	---------------------	--------------------------