

Def / Deposit / ...

SITE CODE: <b>MZ</b>	DATE OPENED: 6 July	SU No: 17036	MARZUOLO ARCHAEOLOGICAL PROJECT
	DATE CLOSED:	SE	
	INITIAL: AK	AREA No: 17000	

FORMATION PROCESS: ANTHROPIC <input type="checkbox"/> NATURAL <input checked="" type="checkbox"/>	DEFINITION: orange south of 17013 abutting bricks 17069
	SU TYPE: <input checked="" type="checkbox"/> DEPOSIT <input type="checkbox"/> <input type="checkbox"/> CUT <input type="checkbox"/> STRUCTURAL ?
	DISTINGUISHED BY: <input checked="" type="checkbox"/> COLOR <input type="checkbox"/> COMPACTION <input checked="" type="checkbox"/> COMPOSITION

DEPOSIT:	STRUCTURAL:	DESCRIPTION: 1. Red-Brown 2. very compact 3. Clay (baked) 4. N/A 5. 2.07m length 6. All clear 7. N/A 8. pickaxe travel, brush. Sunny & Dry
1. Colour 2. Compaction 3. Composition 4. Inclusions (freq/med/rare) 5. Dimensions/Shape 6. Clarity of Limits (clear/not clear) 7. Fill of 8. Method & Conditions	1. Type (wall, cistern, etc.) 2. Technique (pisé, ashlar, etc.) 3. # of Coursings 4. Bonding Material 5. Facing/Finish (plaster, etc.) 6. Orientation 7. Dimensions 8. Abuts/butted by 9. Related architectural features	
CUT:		
1. Shape in Plan 2. Top - BOS 3. Base - BOS 4. Sides 5. Orientation 6. Dimensions 7. Fill Nos		

**INTERPRETATION/DISCUSSION:**

- Highly compact soil possibly coloured by kiln activity (No kiln)
- Part of the goal of this layer was to define the wall of 17013
- Concotto orange soil abutting bricks 17069 and Baahs (17013)
- Part of Post-collapse use phase.

**MATRIX:**

		17001		
		17036	This context	
		17035		

<b>STRATIGRAPHIC RELATIONSHIPS:</b>		<b>FILLS:</b>
CUT:	BUTTED BY:	FILLED BY:
CUT BY:	COVERS: 17035	EQUAL TO:
ABUTS: 17013 17069	COVERED BY: 17001	BINDS TO:

**ENVIRONMENTAL SAMPLES:**  POLLEN  SOIL  CHARCOAL  OTHER  
(specify): \_\_\_\_\_

# MARZUOLO ARCHAEOLOGICAL PROJECT

CIT No: 14037

SITE CODE:  
A 17

DATE OPENED:

DATE CLOSED:

SPECIAL FINDS N <sup>o</sup> s:	FINDS TYPE:	SLAG <input type="checkbox"/>	DAUB <input type="checkbox"/>
	NONE <input type="checkbox"/>	GLASS <input type="checkbox"/>	WRKD WOOD <input type="checkbox"/>
	POTTERY <input type="checkbox"/>	BONE <input type="checkbox"/>	WRKD STONE <input type="checkbox"/>
	BRICK/TILE <input type="checkbox"/>	LEATHER <input type="checkbox"/>	OTHER (specify):
	METAL <input type="checkbox"/>	MORTAR <input type="checkbox"/>	

PHOTO N <sup>o</sup> s	101-5662 → 5604 101-5659 → 5681	PHOTO MODEL N <sup>o</sup> s	
------------------------	------------------------------------	------------------------------	--

**SKETCH OF PLAN** INCLUDE: 1. North Arrow; 2. Dimensions; 3. Sample Locations (if relevant); 4. Levels; 5. Grid Pts (if relevant); 6. Rise/Drop in Surface Level; 7. Abutting Architecture/Adjacent or Relevant Nearby Features for Reference; 8. All SU N<sup>o</sup>s

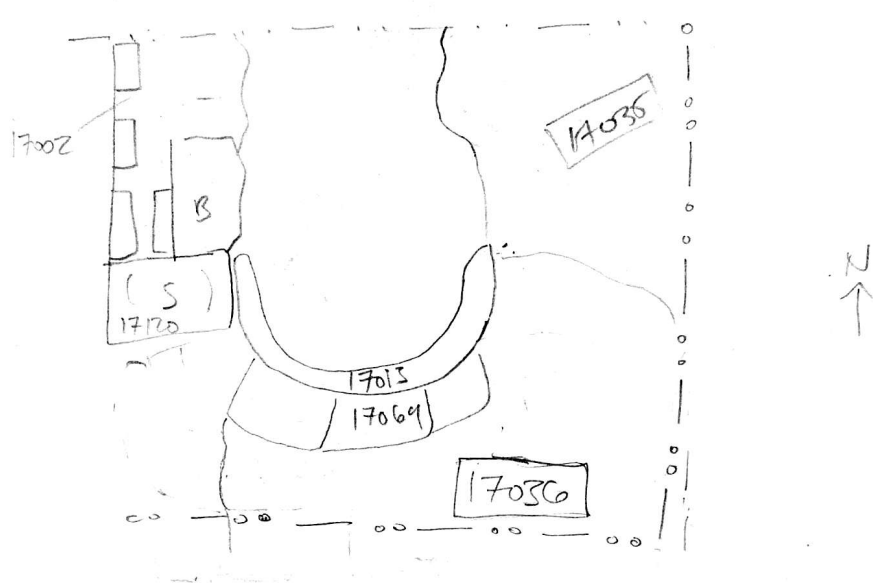

FIELD NOTEBOOK DRAWINGS - PAGE N <sup>o</sup> s		PROFILE DRAWING N <sup>o</sup> s	
STRATIGRAPHIC RELIABILITY	LOW	HIGH	APROX. DATE OF LAYER
	1 2 3 (4) 5		
CONFIDENCE IN INTERPRETATION	1 2 3 (4) 5	DATABLE MATERIALS	
CONTAMINATION RISK	1 2 (3) 4 5 under 17001		

**COMMENTS/OBSERVATIONS:**  
Southern edge of unit = RPP excavation line

ENTERED INTO DATABASE	INITIALS: KG	DATE: 9 July 2017
-----------------------	--------------	-------------------