

SITE CODE: MZ	DATE OPENED: <i>6 July</i>	SU No: <i>17037</i> <i>E</i>	MARZUOLO ARCHAEOLOGICAL PROJECT
	DATE CLOSED: INITIAL: <i>AK</i>	AREA No: <i>17017</i>	

FORMATION PROCESS: ANTHROPIC <input type="checkbox"/> NATURAL <input checked="" type="checkbox"/>	DEFINITION: <i>Silty deposit in 17013 basin beneath 17014 & 17033</i>
	SU TYPE: <input type="checkbox"/> DEPOSIT <input type="checkbox"/> <input type="checkbox"/> CUT <input type="checkbox"/> STRUCTURAL
	DISTINGUISHED BY: <input checked="" type="checkbox"/> COLOR <input checked="" type="checkbox"/> COMPACTION <input type="checkbox"/> COMPOSITION

DEPOSIT: 1. Colour 2. Compaction 3. Composition 4. Inclusions (freq/med/rare) 5. Dimensions/Shape 6. Clarity of Limits (clear/not clear) 7. Fill of 8. Method & Conditions	STRUCTURAL: 1. Type (wall, cistern, etc.) 2. Technique (pisé, ashlar, etc.) 3. # of Coursings 4. Bonding Material 5. Facing/Finish (plaster, etc.) 6. Orientation 7. Dimensions 8. Abuts/butted by 9. Related architectural features	DESCRIPTION: <i>1. lighter brown in S area near ceramic edges of 17013, darker towards the north where it was beneath 17033 charred area.</i> <i>2. concave</i> <i>3. silt</i> <i>4. none clear (??)</i> <i>5. 1m x 1m</i> <i>6. All clear</i> <i>7. ...</i> <i>8. Pickaxe, hand axe, brush, dry, sunny</i>
---	--	--

INTERPRETATION/DISCUSSION:
Covers the floor of the Basin and collapsed pieces Assoc. with post-collapse use phase(?)

MATRIX:

		<i>17014</i>	<i>17033</i>	
		<i>17037</i>	This context	
		<i>17013</i>	<i>17061</i>	

STRATIGRAPHIC RELATIONSHIPS:		FILLS:
CUT:	BUTTED BY:	FILLED BY:
CUT BY:	COVERS: <i>17013 17061</i>	EQUAL TO:
ABUTS: <i>17120</i>	COVERED BY: <i>17014 17033</i>	BINDS TO:

ENVIRONMENTAL SAMPLES: POLLEN SOIL CHARCOAL OTHER
 (specify): _____

SPECIAL FINDS N°s:	FINDS TYPE: NONE <input type="checkbox"/> POTTERY <input type="checkbox"/> BRICK/TILE <input type="checkbox"/> METAL <input type="checkbox"/>	SLAG <input type="checkbox"/> GLASS <input type="checkbox"/> BONE <input type="checkbox"/> LEATHER <input type="checkbox"/> MORTAR <input type="checkbox"/>	DAUB <input type="checkbox"/> WRKD WOOD <input type="checkbox"/> WRKD STONE <input type="checkbox"/> OTHER (specify):
---------------------------	--	---	--

PHOTO N°s	(115922-5925)	PHOTO MODEL N°s	111
------------------	---------------	------------------------	-----

SKETCH OF PLAN INCLUDE: 1. North Arrow; 2. Dimensions; 3. Sample Locations (if relevant); 4. Levels; 5. Grid Pts (if relevant); 6. Rise/Drop in Surface Level; 7. Abutting Architecture/Adjacent or Relevant Nearby Features for Reference; 8. All SU N°s

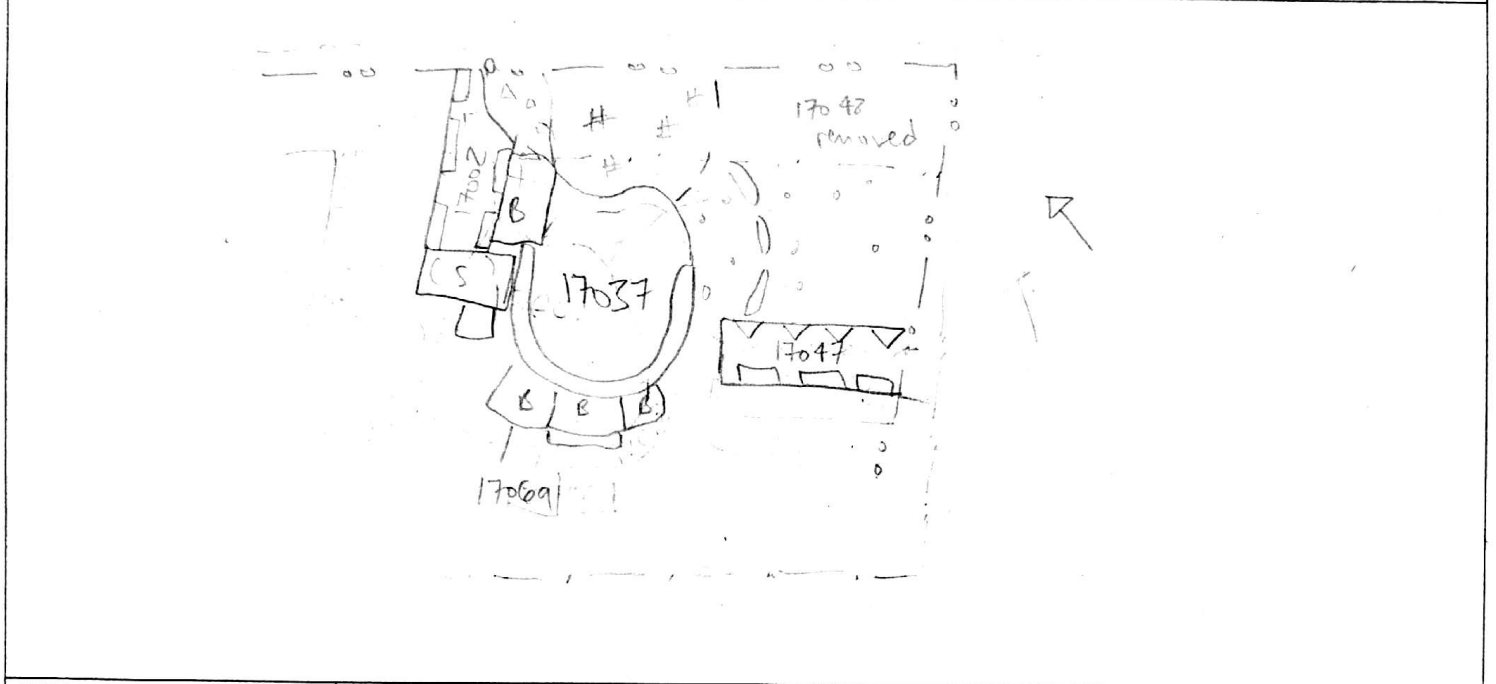

FIELD NOTEBOOK DRAWINGS - PAGE N°s		PROFILE DRAWING N°s	
STRATIGRAPHIC RELIABILITY	LOW	HIGH	APROX. DATE OF LAYER
	1 2 3 4 5	1 2 3 4 5	
CONFIDENCE IN INTERPRETATION	1 2 3 4 5		DATABLE MATERIALS
CONTAMINATION RISK	1 2 3 4 5		

COMMENTS/OBSERVATIONS:
 There is a higher concentration of darker, probable organic material near the base the soil sample is from the end.

ENTERED INTO DATABASE	INITIALS: CC	DATE: 21-7-17
------------------------------	---------------------	----------------------