

strat rel

✓

SITE CODE: MZ	DATE OPENED: 6 July	SU No: SE 17038	MARZUOLO ARCHAEOLOGICAL PROJECT
	DATE CLOSED:	AREA No: 17000	
	INITIAL: KG		

FORMATION PROCESS: ANTHROPIC <input checked="" type="checkbox"/> NATURAL <input type="checkbox"/>	DEFINITION:
	SU TYPE: <input checked="" type="checkbox"/> DEPOSIT <input type="checkbox"/> <input type="checkbox"/> CUT <input type="checkbox"/> STRUCTURAL
	DISTINGUISHED BY: <input type="checkbox"/> COLOR <input type="checkbox"/> COMPACTION <input checked="" type="checkbox"/> COMPOSITION

DEPOSIT: 1. Colour 2. Compaction 3. Composition 4. Inclusions (freq/med/rare) 5. Dimensions/Shape 6. Clarity of Limits (clear/not clear) 7. Fill of 8. Method & Conditions	STRUCTURAL: 1. Type (wall, cistern, etc.) 2. Technique (pisé, ashlar, etc.) 3. # of Coursings 4. Bonding Material 5. Facing/Finish (plaster, etc.) 6. Orientation 7. Dimensions 8. Abuts/butted by 9. Related architectural features	DESCRIPTION: 1. Orange 2. Loose - mod 3. Silt, 4. Frequent pottery, rare glass, snails near bottom of context 5. Irregular 6. N clear; S, W. excavation extent; E unclear 7. N/A 8. Sunny, pick & trowel
CUT: 1. Shape in Plan 2. Top - BOS 3. Base - BOS 4. Sides 5. Orientation 6. Dimensions 7. Fill Nos		

INTERPRETATION/DISCUSSION:
 Dumped amphora and window glass at mouth of kiln. Orange soil and pottery deposit extended to south and east of mouth of "kiln". Pottery found in 17038 also often extended into 17041 (deposited at the same time).

MATRIX:

<input type="checkbox"/>	<input type="checkbox"/>	<input type="checkbox"/>	<input type="checkbox"/>	<input type="checkbox"/>	<input type="checkbox"/>
	17096	17034	17011		
		17038	This context		
<input type="checkbox"/>	<input type="checkbox"/>	17091	<input type="checkbox"/>	<input type="checkbox"/>	<input type="checkbox"/>

STRATIGRAPHIC RELATIONSHIPS:		FILLS:
CUT:	BUTTED BY:	FILLED BY:
CUT BY: 17028	COVERS: 17041	EQUAL TO:
ABUTS:	COVERED BY: 17096 17011 17034	BINDS TO:

ENVIRONMENTAL SAMPLES: POLLEN SOIL CHARCOAL OTHER (specify): _____

SPECIAL FINDS N°s:	FINDS TYPE: NONE <input type="checkbox"/> POTTERY <input checked="" type="checkbox"/> BRICK/TILE <input type="checkbox"/> METAL <input type="checkbox"/>	SLAG <input type="checkbox"/> GLASS <input type="checkbox"/> BONE <input checked="" type="checkbox"/> LEATHER <input type="checkbox"/> MORTAR <input type="checkbox"/>	DAUB <input type="checkbox"/> WRKD WOOD <input type="checkbox"/> WRKD STONE <input type="checkbox"/> OTHER (specify): <i>Snail shells</i>
---------------------------	---	--	---

PHOTO N°s 101-5725 → 5728 (snails) + channel 101-5679	PHOTO MODEL N°s 108
---	-------------------------------

SKETCH OF PLAN INCLUDE: 1. North Arrow; 2. Dimensions; 3. Sample Locations (if relevant); 4. Levels; 5. Grid Pts (if relevant); 6. Rise/Drop in Surface Level; 7. Abutting Architecture/Adjacent or Relevant Nearby Features for Reference; 8. All SU N°s

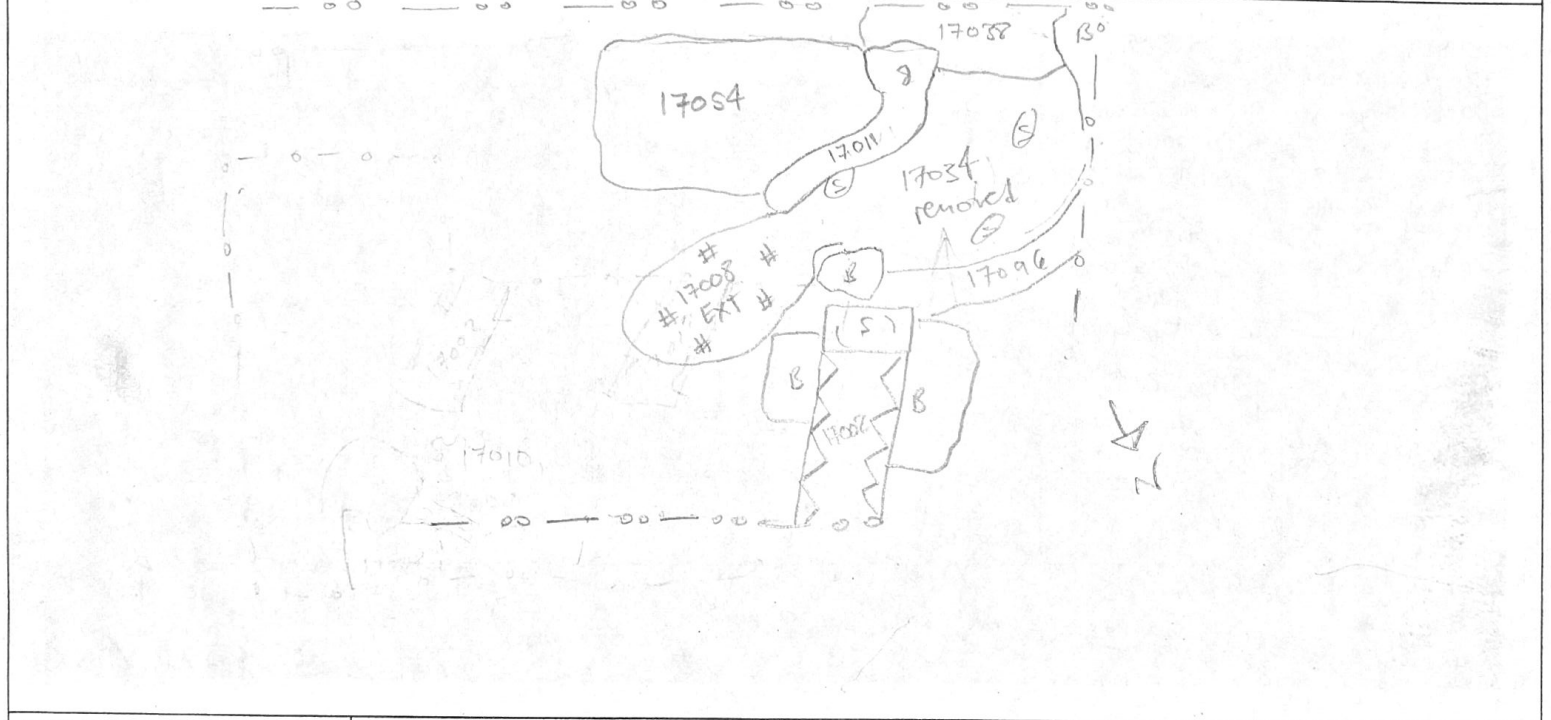

FIELD NOTEBOOK DRAWINGS - PAGE N°s		PROFILE DRAWING N°s	
STRATIGRAPHIC RELIABILITY	LOW	HIGH	APROX. DATE OF LAYER
	1 2 3 4 5	1 2 3 4 5	
CONFIDENCE IN INTERPRETATION	1 2 3 4 5	DATEABLE MATERIALS	
CONTAMINATION RISK	1 2 3 4 5		

COMMENTS/OBSERVATIONS:
occupation material in collapse

ENTERED INTO DATABASE	INITIALS: <i>JV</i>	DATE: <i>21 July 17</i>
------------------------------	----------------------------	--------------------------------