

Def. observ.

SITE CODE: <b>MZ</b>	DATE OPENED: 6 July	SU No: SE 17039	MARZUOLO ARCHAEOLOGICAL PROJECT
	DATE CLOSED: 14 July	AREA No: 17000	
	INITIAL: MB/FEF		

FORMATION PROCESS:  ANTHROPIC <input type="checkbox"/> NATURAL <input checked="" type="checkbox"/>	DEFINITION: brown-orange soil east of 17002
	SU TYPE: <input checked="" type="checkbox"/> DEPOSIT <input type="checkbox"/> <input type="checkbox"/> CUT <input type="checkbox"/> STRUCTURAL
	DISTINGUISHED BY: <input checked="" type="checkbox"/> COLOR <input checked="" type="checkbox"/> COMPACTION <input type="checkbox"/> COMPOSITION

DEPOSIT:	STRUCTURAL:	DESCRIPTION: 1. Orange/brown 2. Semi-compact 3. Silty clay 4. Med. small tile and stone 5. Rectangular, c. 2 x 2m. 6. Probably the same as 17040, but it had been excavated already. All other extents were clear <del>not</del> clear everywhere except N-exc. limit. 7. ✓ 8. Pick, trowel + broom. Sunny heat
1. Colour 2. Compaction 3. Composition 4. Inclusions (freq/med/rare) 5. Dimensions/Shape 6. Clarity of Limits (clear/not clear) 7. Fill of 8. Method & Conditions	1. Type (wall, cistern, etc.) 2. Technique (pisé, ashlar, etc.) 3. # of Coursings 4. Bonding Material 5. Facing/Finish (plaster, etc.) 6. Orientation 7. Dimensions 8. Abuts/butted by 9. Related architectural features	
CUT:		
1. Shape in Plan 2. Top - BOS 3. Base - BOS 4. Sides 5. Orientation 6. Dimensions 7. Fill Nos		

**INTERPRETATION/DISCUSSION:**  
Probably the same context as 17040. I (FEF) was not present for delineation of 39 + 40, but 40's context sheet seems to describe 39 well. It is possible that the concentration of tiles in 39 were less frequent at its surface, but aside from that I don't know what the difference would've been.  
- AK: having checked the original photo of 17039, there was a definite difference

<b>MATRIX:</b>	<input type="checkbox"/>	<input type="checkbox"/>	17007	<input type="checkbox"/>	<input type="checkbox"/>	between 17039 & 17040. 17039 was a thin soil matrix on top of 17040 - Agreed (RGV)
			17039	This context		
			17040			

<b>STRATIGRAPHIC RELATIONSHIPS:</b>		<b>FILLS:</b>
CUT:	BUTTED BY:	FILLED BY:
CUT BY:	COVERS:	EQUAL TO:
ABUTS: 17002 1708	COVERED BY: 17007	BINDS TO:

**ENVIRONMENTAL SAMPLES:**  POLLEN  SOIL  CHARCOAL  OTHER  
(specify): \_\_\_\_\_

<b>SPECIAL FINDS N°s:</b>	<b>FINDS TYPE:</b>	SLAG <input type="checkbox"/>	DAUB <input type="checkbox"/>
	NONE <input type="checkbox"/>	GLASS <input type="checkbox"/>	WRKD WOOD <input type="checkbox"/>
	POTTERY <input type="checkbox"/>	BONE <input type="checkbox"/>	WRKD STONE <input type="checkbox"/>
	BRICK/TILE <input checked="" type="checkbox"/>	LEATHER <input type="checkbox"/>	OTHER (specify):
	METAL <input type="checkbox"/>	MORTAR <input type="checkbox"/>	

<b>PHOTO N°s</b>	101-6531 6532	<b>PHOTO MODEL N°s</b>	
------------------	------------------	------------------------	--

**SKETCH OF PLAN** INCLUDE: 1. North Arrow; 2. Dimensions; 3. Sample Locations (if relevant); 4. Levels; 5. Grid Pts (if relevant); 6. Rise/Drop in Surface Level; 7. Abutting Architecture/Adjacent or Relevant Nearby Features for Reference; 8. All SU N°s

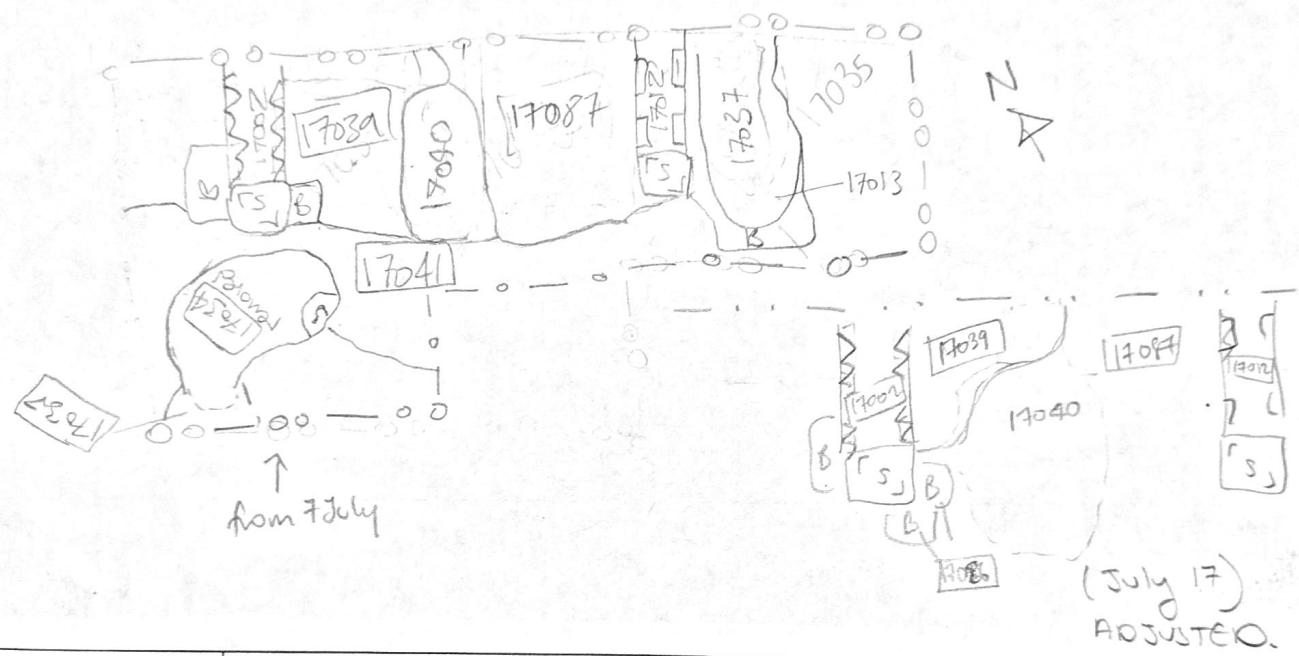

<b>FIELD NOTEBOOK DRAWINGS - PAGE N°s</b>	27, 29, 30, 35, 38, 44, 48, 55	<b>PROFILE DRAWING N°s</b>	
<b>STRATIGRAPHIC RELIABILITY</b>	LOW	HIGH	<b>APROX. DATE OF LAYER</b>
	1 2 3 4 5	1 2 3 4 5	
<b>CONFIDENCE IN INTERPRETATION</b>	1 2 3 4 5	<b>DATABLE MATERIALS</b>	
<b>CONTAMINATION RISK</b>	1 2 3 4 5		

**COMMENTS/OBSERVATIONS:**  
 The limits of this context were redefined on 17 July → it originally extended from 17002 to 17006 but now instead it is only the western portion.  
 → top extents need to be changed on the computer  
 As of 17 July, FEF believes 39 + 40 are the same (layer), but having not been present for above deliberations  
 17039 had much fewer stone and tiles than 40, probably an interface under 17007 and over collapsed 17040 (RGV)

<b>ENTERED INTO DATABASE</b>	<b>INITIALS:</b> AK	<b>DATE:</b> 23 July
------------------------------	---------------------	----------------------