

SITE CODE: MZ	DATE OPENED: 10-7-17	SU N°: 17045 NW	MARZUOLO ARCHAEOLOGICAL PROJECT MANNE
	DATE CLOSED: 12-7-17 INITIAL: CY, OA	AREA N°: 17000	

FORMATION PROCESS: ANTHROPIC <input checked="" type="checkbox"/> NATURAL <input type="checkbox"/>	DEFINITION: Dump of small-med stones in brown soil matrix
	SU TYPE: <input checked="" type="checkbox"/> DEPOSIT <input type="checkbox"/> <input type="checkbox"/> CUT <input type="checkbox"/> STRUCTURAL
	DISTINGUISHED BY: <input type="checkbox"/> COLOR <input type="checkbox"/> COMPACTION <input checked="" type="checkbox"/> COMPOSITION

DEPOSIT: 1. Colour 2. Compaction 3. Composition 4. Inclusions (freq/med/rare) 5. Dimensions/Shape 6. Clarity of Limits (clear/not clear) 7. Fill of 8. Method & Conditions	STRUCTURAL: 1. Type (wall, cistern, etc.) 2. Technique (pisé, ashlar, etc.) 3. # of Coursings 4. Bonding Material 5. Facing/Finish (plaster, etc.) 6. Orientation 7. Dimensions 8. Abuts/butted by 9. Related architectural features	DESCRIPTION: 1 Light brown 2 Not compact, easily broken up between stones 3 silty soil 4. Freq small-med cobbles 5 1 m x 0.5 m 6 E, N, S - clear; N - trench limit 7 N/A 8 cloudy; pick & trowel
CUT: 1. Shape in Plan 2. Top - BOS 3. Base - BOS 4. Sides 5. Orientation 6. Dimensions 7. Fill N°s		

INTERPRETATION/DISCUSSION:
 Deposit with concentration of small-med cobbles abutting wall 17018 below 17030 (similar accumulation of stones) and covering 17056. Dumping activity in tank during abandonment or in preparation of a re-use of the area after the collapse

MATRIX:

		17030	17032	
		17045	This context	
	17049	17056	17046	17019

STRATIGRAPHIC RELATIONSHIPS:		FILLS:
CUT:	BUTTED BY:	FILLED BY:
CUT BY:	COVERS: 17056 17046	EQUAL TO:
ABUTS: 17018 17049	COVERED BY: 17030 17032	BINDS TO:

ENVIRONMENTAL SAMPLES: POLLEN SOIL CHARCOAL OTHER
 (specify): _____

SPECIAL FINDS N^os: SF17-114 SF17-117
SF17-121

FINDS TYPE:
NONE

SLAG
GLASS

DAUB
WRKD WOOD

SPECIAL FINDS N^os:
SF17-136
SF17-139

FINDS TYPE:
NONE
POTTERY
BRICK/TILE
METAL

SLAG
GLASS
BONE
LEATHER
MORTAR

DAUB
WRKD WOOD
WRKD STONE
OTHER (specify):

PHOTO N^os

101-5872

PHOTO
MODEL
N^os

SKETCH OF
PLAN

INCLUDE: 1. North Arrow; 2. Dimensions; 3. Sample Locations (if relevant); 4. Levels; 5. Grid Pts (if relevant); 6. Rise/Drop in Surface Level; 7. Abutting Architecture/Adjacent or Relevant Nearby Features for Reference; 8. All SU N^os

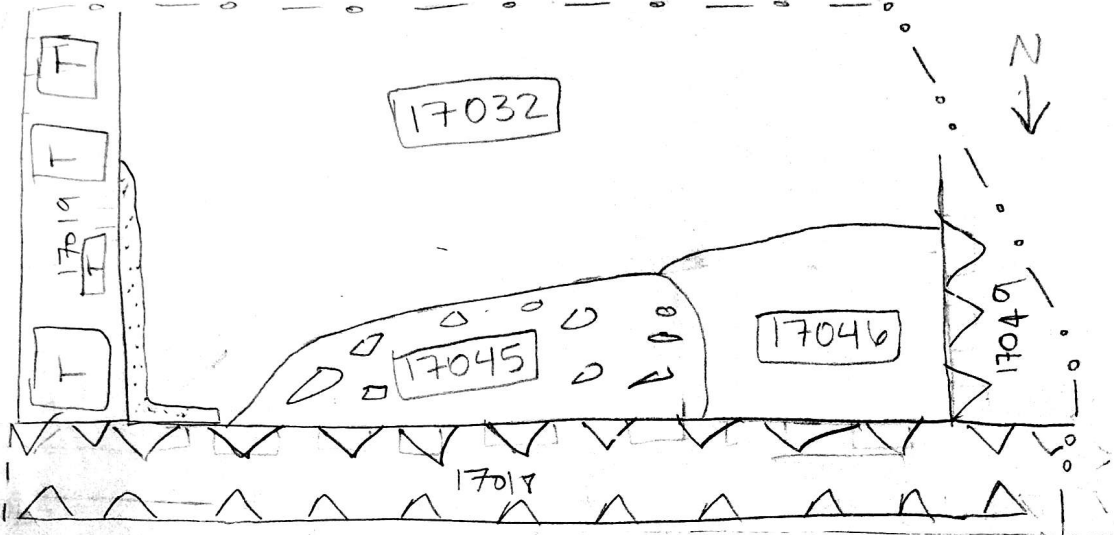

FIELD NOTEBOOK
DRAWINGS - PAGE N^os

33, 39, 41

PROFILE
DRAWING N^os

STRATIGRAPHIC
RELIABILITY

LOW HIGH
1 2 3 4 5

APROX.
DATE OF
LAYER

CONFIDENCE IN
INTERPRETATION

1 2 3 4 5

DATEABLE
MATERIALS

CONTAMINATION RISK

1 2 3 4 5

COMMENTS/OBSERVATIONS:

Stopped picking when a clay deposit was reached and the large stone accumulation stopped.

ENTERED INTO DATABASE

INITIALS: DV

DATE: 18 July 17

21-7-17