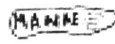

close date

SITE CODE: <b>MZ</b>	DATE OPENED: July 12	SU No: 17063	MARZUOLO ARCHAEOLOGICAL PROJECT 
	DATE CLOSED: July 12	AREA No: 17000	
	INITIAL: JS		

FORMATION PROCESS:  ANTHROPIC <input checked="" type="checkbox"/> NATURAL <input type="checkbox"/>	DEFINITION: LOW FIRED BRICK
	SU TYPE: <input type="checkbox"/> DEPOSIT <input type="checkbox"/> <input type="checkbox"/> CUT <input checked="" type="checkbox"/> STRUCTURAL
	DISTINGUISHED BY: <input type="checkbox"/> COLOR <input type="checkbox"/> COMPACTION <input type="checkbox"/> COMPOSITION

DEPOSIT:	STRUCTURAL:	DESCRIPTION: 1. BRICK 2. N/A 3. 1 course 4. N/A 5. N/A 6. N-S 7. 47cm x 25cm 8. abuts 17012 9. Wall, 17012 Bacina 17013 and 17061
1. Colour 2. Compaction 3. Composition 4. Inclusions (freq/med/rare) 5. Dimensions/Shape 6. Clarity of Limits (clear/not clear) 7. Fill of 8. Method & Conditions	1. Type (wall, cistern, etc.) 2. Technique (pisé, ashlar, etc.) 3. # of Coursings 4. Bonding Material 5. Facing/Finish (plaster, etc.) 6. Orientation 7. Dimensions 8. Abuts/butted by 9. Related architectural features	
CUT:		
1. Shape in Plan 2. Top - BOS 3. Base - BOS 4. Sides 5. Orientation 6. Dimensions 7. Fill Nos		

INTERPRETATION/DISCUSSION:  
Brick placed on top of Bacina fragment (17061), clearly associating it with post-collapse use phase of the site

MATRIX:

<input type="checkbox"/>	<input type="checkbox"/>	17014	<input type="checkbox"/>	<input type="checkbox"/>
		17063	This context	
<input type="checkbox"/>	<input type="checkbox"/>	17061	<input type="checkbox"/>	<input type="checkbox"/>

STRATIGRAPHIC RELATIONSHIPS:		FILLS:
CUT:	BUTTED BY:	FILLED BY:
CUT BY:	COVERS: 17061	EQUAL TO:
ABUTS: 17012	COVERED BY: 17014	BINDS TO:

ENVIRONMENTAL SAMPLES:  POLLEN  SOIL  CHARCOAL  OTHER  
(specify): N/A

SPECIAL FINDS N°s:	FINDS TYPE:		SLAG <input type="checkbox"/>	DAUB <input type="checkbox"/>
	NONE <input type="checkbox"/>	GLASS <input type="checkbox"/>	WRKD WOOD <input type="checkbox"/>	
	POTTERY <input type="checkbox"/>	BONE <input type="checkbox"/>	WRKD STONE <input type="checkbox"/>	
	BRICK/TILE <input type="checkbox"/>	LEATHER <input type="checkbox"/>	OTHER (specify):	
	METAL <input type="checkbox"/>	MORTAR <input type="checkbox"/>		

PHOTO N°s	101-6442 → 6448	PHOTO MODEL N°s	122 128
-----------	-----------------	-----------------	------------

SKETCH OF PLAN INCLUDE: 1. North Arrow; 2. Dimensions; 3. Sample Locations (if relevant); 4. Levels; 5. Grid Pts (if relevant); 6. Rise/Drop in Surface Level; 7. Abutting Architecture/Adjacent or Relevant Nearby Features for Reference; 8. All SU N°s

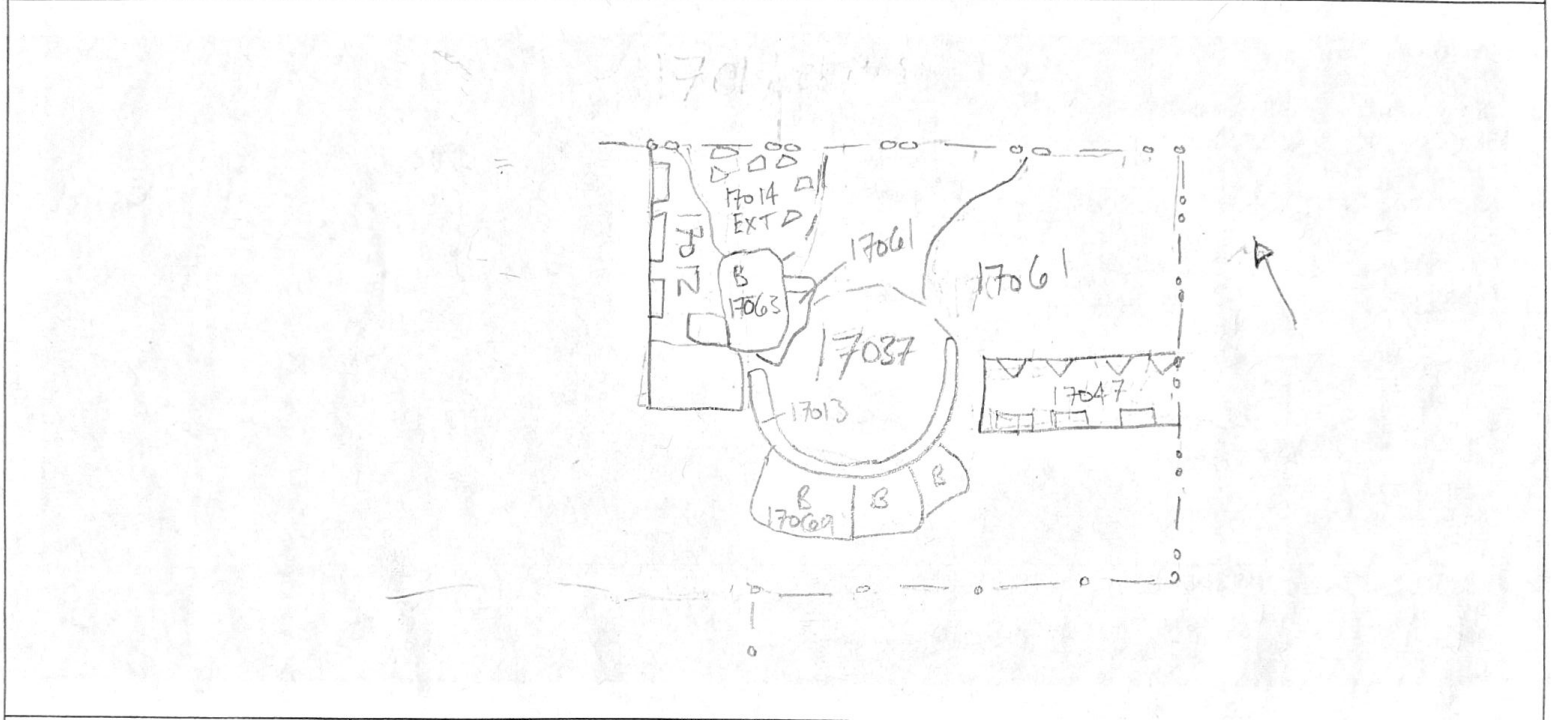

FIELD NOTEBOOK DRAWINGS - PAGE N°s	none				PROFILE DRAWING N°s	
STRATIGRAPHIC RELIABILITY	LOW	HIGH			APROX. DATE OF LAYER	
	1 2 3 4 5	1 2 3 4 5				
CONFIDENCE IN INTERPRETATION	1 2 3 4 5	1 2 3 4 5	DATEABLE MATERIALS			
CONTAMINATION RISK	1 2 3 4 5					

COMMENTS/OBSERVATIONS:  
 Discussion of whether brick placed purposely next to wall in later re-use of area or whether part of collapse of structure. Fact that it covers turned over frag of baccho and other collapse material suggests later placement.

ENTERED INTO DATABASE	INITIALS: AK	DATE: 23 July
-----------------------	--------------	---------------