

INTERP STRAT REL ✓

SITE CODE: MZ	DATE OPENED: 13 July	SU No: SE 17075	MARZUOLO ARCHAEOLOGICAL PROJECT <small>NAME</small>
	DATE CLOSED: 13 July INITIAL: AK	AREA No: 17000	

FORMATION PROCESS: ANTHROPIC NATURAL

DEFINITION: accumulation of stone + mortar
south of 17012

SU TYPE: DEPOSIT CUT STRUCTURAL

DISTINGUISHED BY: COLOR COMPACTION COMPOSITION

DEPOSIT:

- Colour
- Compaction
- Composition
- Inclusions (freq/med/rare)
- Dimensions/Shape
- Clarity of Limits (clear/not clear)
- Fill of
- Method & Conditions

CUT:

- Shape in Plan
- Top - BOS
- Base - BOS
- Sides
- Orientation
- Dimensions
- Fill Nos

STRUCTURAL:

- Type (wall, cistern, etc.)
- Technique (pisé, ashlar, etc.)
- # of Coursings
- Bonding Material
- Facing/Finish (plaster, etc.)
- Orientation
- Dimensions
- Abuts/butted by
- Related architectural features

DESCRIPTION:

- yellowish brown
- loose
- silty sand
- Freq. stone + tile, many nails, freq. mortar
- approx. 1m x 0.75m
- near - N, W, S, trench min. E
-
- pickaxe, trowel, sunny

INTERPRETATION/DISCUSSION:
 Layer of stone, tile & mortar beneath 17010. Many nails found, small amount of *T. sigillata* including a base with a stamped design of a cupid and dolphin.
 Part of collapse, but distinguished by high concentration of mortar creating a clearly defined patch.

MATRIX:

		17010		
		17075	This context	
		17042		

STRATIGRAPHIC RELATIONSHIPS:

CUT:	BUTTED BY:	FILLS:
CUT BY:	COVERS: 17642	FILLED BY:
ABUTS:	COVERED BY: 17010	EQUAL TO:
		BINDS TO:

ENVIRONMENTAL SAMPLES: POLLEN SOIL CHARCOAL OTHER (specify): _____

SPECIAL FINDS Nos: 17-167, 17-168, 17-169, 17-170, 17-171, 17-172, 17-173, 17-174, 17-175, 17-176, 17-177, 17-178

FINDS TYPE:
 NONE
 POTTERY
 BRICK/TILE
 METAL
 SLAG
 GLASS
 BONE
 LEATHER
 MORTAR

DAUB R
 WRKD WOOD
 WRKD STONE
 OTHER (specify):

PHOTO Nos 101-6529, 101-6530

PHOTO MODEL Nos

SKETCH OF PLAN INCLUDE: 1. North Arrow; 2. Dimensions; 3. Sample Locations (if relevant); 4. Levels; 5. Grid Pts (if relevant); 6. Rise/Drop in Surface Level; 7. Abutting Architecture/Adjacent or Relevant Nearby Features for Reference; 8. All SU Nos

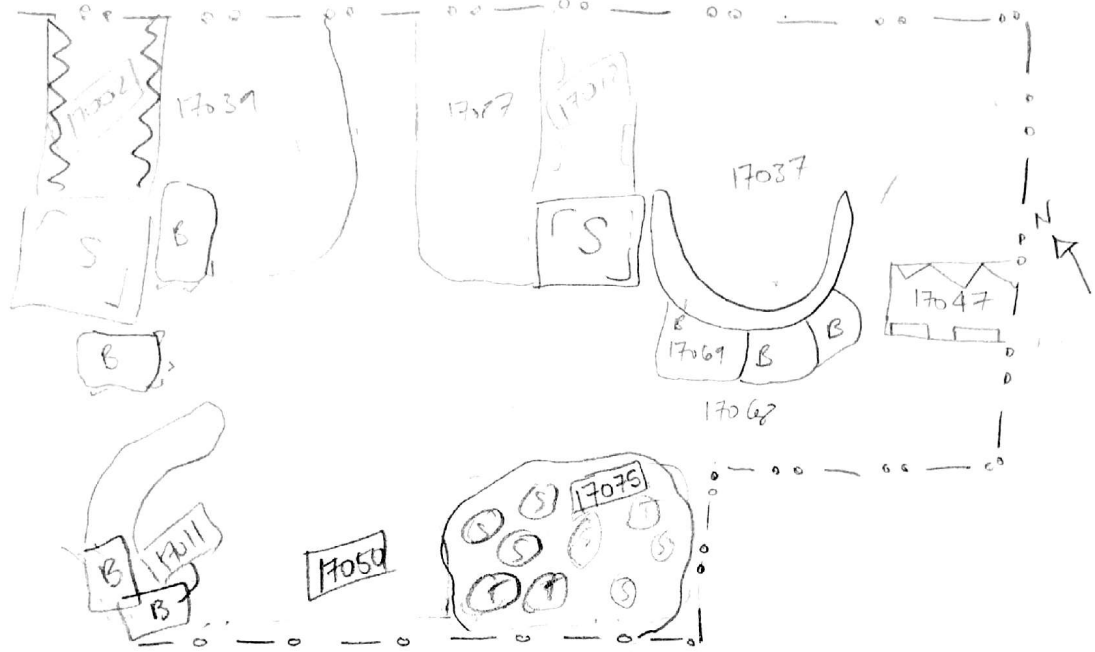

DE
 1.
 2.
 3.
 4.
 5. D.
 Sh
 6. Cl
 (ck
 7. Fill
 8. Met
 Conc

CUT:
 1. Shape
 2. Top-
 Base-
 Sides
 Orienta
 Dimens.
 Fill Nos

TERPRE:
 ow f
 nd G

PHIC

7002
NTAL:

FIELD NOTEBOOK DRAWINGS - PAGE Nos		PROFILE DRAWING Nos	
STRATIGRAPHIC RELIABILITY	LOW	HIGH	APROX. DATE OF LAYER
	1 2 3 4 5	1 2 3 4 5	
CONFIDENCE IN INTERPRETATION	1 2 3 4 5		DATABLE MATERIALS
CONTAMINATION RISK	1 2 3 4 5		

COMMENTS/OBSERVATIONS:

ENTERED INTO DATABASE INITIALS: AK DATE: 22 July