

EQUALIZED w/ 17085 ✓

SITE CODE: <b>MZ</b>	DATE OPENED: 17 July	SU No: 17083	MARZUOLO ARCHAEOLOGICAL PROJECT
	DATE CLOSED: INITIAL: O.A, M.B, C.Y	AREA No: 17000	

FORMATION PROCESS: ANTHROPIC <input checked="" type="checkbox"/> NATURAL <input type="checkbox"/>	DEFINITION: Fill of Foundation cut (17097)
	SU TYPE: <input checked="" type="checkbox"/> DEPOSIT <input type="checkbox"/> <input type="checkbox"/> CUT <input type="checkbox"/> STRUCTURAL
	DISTINGUISHED BY: <input type="checkbox"/> COLOR <input checked="" type="checkbox"/> COMPACTION <input checked="" type="checkbox"/> COMPOSITION

DEPOSIT: 1. Colour 2. Compaction 3. Composition 4. Inclusions (freq/med/rare) 5. Dimensions/Shape 6. Clarity of Limits (clear/not clear) 7. Fill of 8. Method & Conditions	STRUCTURAL: 1. Type (wall, cistern, etc.) 2. Technique (pisé, ashlar, etc.) 3. # of Coursings 4. Bonding Material 5. Facing/Finish (plaster, etc.) 6. Orientation 7. Dimensions 8. Abuts/butted by 9. Related architectural features	DESCRIPTION: 1. Medium brown 2. Semi-compact 3. Soil 4. pottery (rare), tile (rare), pebbles (rare) 5. 2m x 1m 6. clear to N and E; trench limit to S and W 7. not applicable 8. sunny, dry, hand trowel/pick axe
CUT: 1. Shape in Plan 2. Top - BOS 3. Base - BOS 4. Sides 5. Orientation 6. Dimensions 7. Fill Nos		

INTERPRETATION/DISCUSSION:  
- Fill of foundation cut (17097) to build wall 17019 and lay floor of tank (?)

MATRIX:

<input type="checkbox"/>	<input type="checkbox"/>	17070	<input type="checkbox"/>	<input type="checkbox"/>
	17085 =	17083	This context	
<input type="checkbox"/>	<input type="checkbox"/>	17100	<input type="checkbox"/>	<input type="checkbox"/>

STRATIGRAPHIC RELATIONSHIPS:		FILLS: 17097
CUT:	BUTTED BY:	FILLED BY:
CUT BY:	COVERS: 17100	EQUAL TO: 17085
ABUTS: 17019	COVERED BY: 17070	BINDS TO:

ENVIRONMENTAL SAMPLES:  POLLEN  SOIL  CHARCOAL  OTHER  
(specify): \_\_\_\_\_

SPECIAL FINDS N <sup>o</sup> s:	FINDS TYPE:	SLAG <input type="checkbox"/>	DAUB <input type="checkbox"/>
	NONE <input type="checkbox"/>	GLASS <input type="checkbox"/>	WRKD WOOD <input type="checkbox"/>
	POTTERY <input checked="" type="checkbox"/>	BONE <input type="checkbox"/>	WRKD STONE <input type="checkbox"/>
	BRICK/TILE <input checked="" type="checkbox"/>	LEATHER <input type="checkbox"/>	OTHER (specify):
	METAL <input type="checkbox"/>	MORTAR <input type="checkbox"/>	

PHOTO N <sup>o</sup> s	101-6874	PHOTO MODEL N <sup>o</sup> s	
------------------------	----------	------------------------------	--

SKETCH OF PLAN INCLUDE: 1. North Arrow; 2. Dimensions; 3. Sample Locations (if relevant); 4. Levels; 5. Grid Pts (if relevant); 6. Rise/Drop in Surface Level; 7. Abutting Architecture/Adjacent or Relevant Nearby Features for Reference; 8. All SU N<sup>o</sup>s

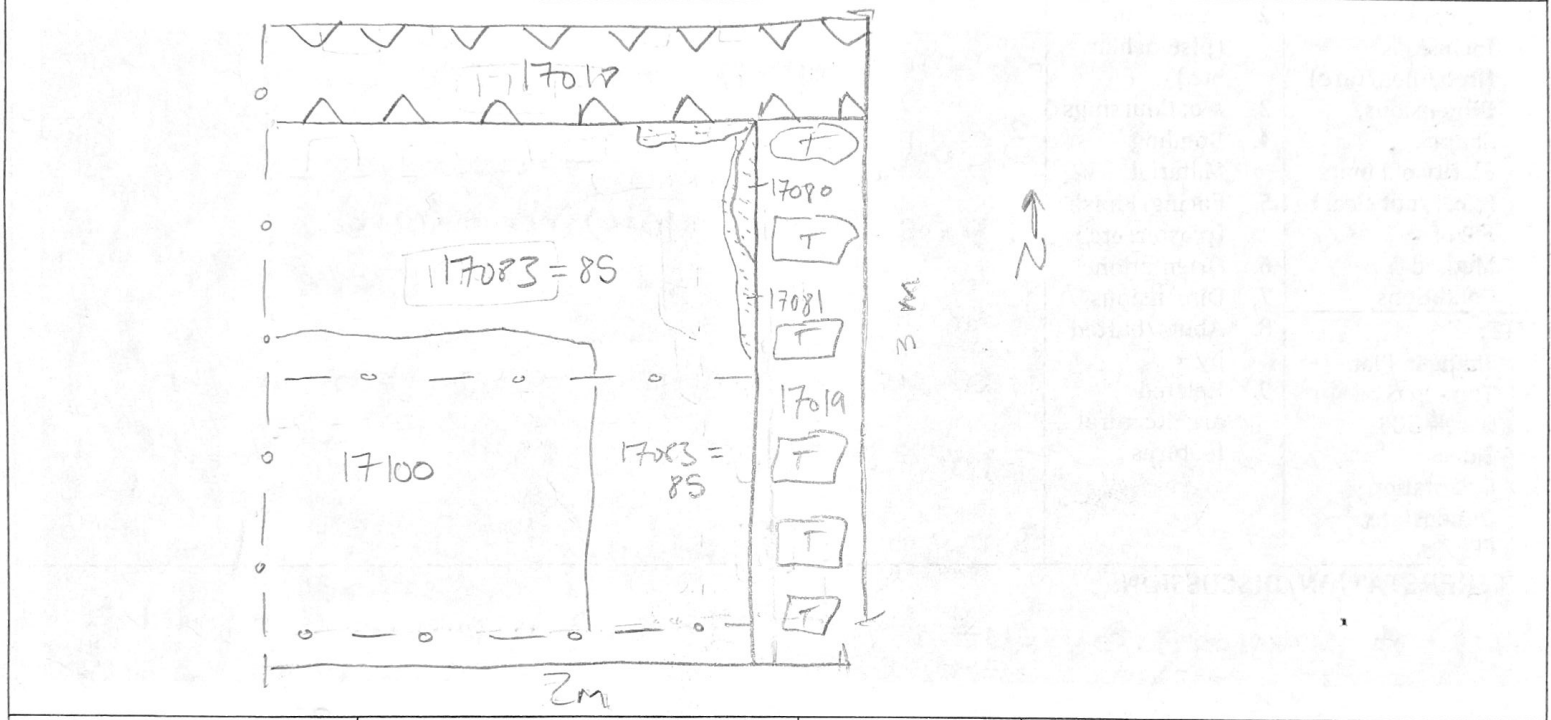

FIELD NOTEBOOK DRAWINGS - PAGE N <sup>o</sup> s	6A	PROFILE DRAWING N <sup>o</sup> s	
STRATIGRAPHIC RELIABILITY	LOW	HIGH	APROX. DATE OF LAYER
	1 2 3 4 5	1 2 3 4 5	
CONFIDENCE IN INTERPRETATION	1 2 3 4 5	DATABLE MATERIALS	
CONTAMINATION RISK	1 2 3 4 5		

COMMENTS/OBSERVATIONS:  
 more inclusions than 17070, especially with tile + ceramic  
 Why such a big foundation trench for a pipe wall? maybe prep for tank?

ENTERED INTO DATABASE	INITIALS: CC	DATE: 2-7-17
-----------------------	--------------	--------------