

SITE CODE:

MZ

DATE OPENED: 18-1-17

DATE CLOSED: 19-7-17

INITIAL:

CT, DA, MB

SU N°:

NW 17097

AREA N°:

11000

MARZUOLO  
ARCHAEOLOGICAL  
PROJECT

NAME

FORMATION PROCESS:

ANTHROPIC

NATURAL

DEFINITION: FOUNDATION TRENCH

SU TYPE:  DEPOSIT  CUT  STRUCTURAL

DISTINGUISHED BY:  COLOR  COMPACTION  COMPOSITION

DEPOSIT:

1. Colour
2. Compaction
3. Composition
4. Inclusions (freq/med/rare)
5. Dimensions/Shape
6. Clarity of Limits (clear/not clear)
7. Fill of
8. Method & Conditions

STRUCTURAL:

1. Type (wall, cistern, etc.)
2. Technique (pisé, ashlar, etc.)
3. # of Coursings
4. Bonding Material
5. Facing/Finish (plaster, etc.)
6. Orientation
7. Dimensions
8. Abuts/butted by
9. Related architectural features

DESCRIPTION:

1. L-shaped
2. Vertical - foundation trench
3. vertical
4. 90°
5. Facing N + E
6. 1.5m x 1m<sup>2</sup>
7. 17083 + 17085

CUT:

1. Shape in Plan
2. Top - BOS
3. Base - BOS
4. Sides
5. Orientation
6. Dimensions
7. Fill Nos

INTERPRETATION/DISCUSSION:

This is likely a foundation trench for the tile wall 17019 with a trench along 17018 to add in coccopesto? or some type of plaster floor when the wall was being reused.

MATRIX:

		17083 = 85		
		17097	This context	
		17100		

STRATIGRAPHIC RELATIONSHIPS:

FILLS:

CUT: 17100

BUTTED BY:

FILLED BY: 17083 = 85

CUT BY:

COVERS:

EQUAL TO:

ABUTS:

COVERED BY:

BINDS TO:

ENVIRONMENTAL SAMPLES:  POLLEN  SOIL  CHARCOAL

OTHER (specify)

NA

SPECIAL FINDS N°s:

N/A

FINDS TYPE:

- NONE
- POTTERY
- BRICK/TILE
- METAL

SLAG

GLASS

BONE

LEATHER

MORTAR

DAUB

WRKD WOOD

WRKD STONE

OTHER (specify):

PHOTO N°s

N/A

PHOTO MODEL N°s

N/A

SKETCH OF PLAN

INCLUDE: 1. North Arrow; 2. Dimensions; 3. Sample Locations (if relevant); 4. Levels; 5. Grid Pts (if relevant); 6. Rise/Drop in Surface Level; 7. Abutting Architecture/Adjacent or Relevant Nearby Features for Reference; 8. All SU N°s

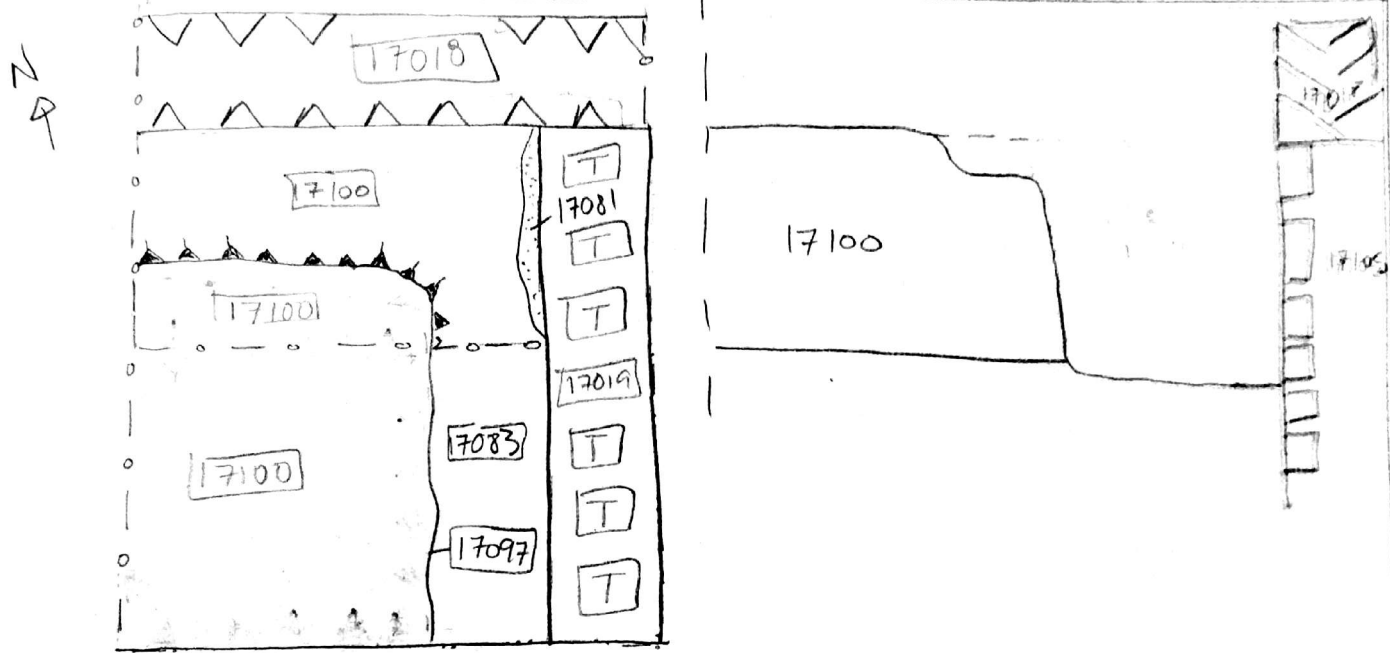

FIELD NOTEBOOK DRAWINGS - PAGE N°s

64

PROFILE DRAWING N°s

STRATIGRAPHIC RELIABILITY

LOW					HIGH
1	2	3	4	5	

APROX. DATE OF LAYER

CONFIDENCE IN INTERPRETATION

1	2	3	4	5
---	---	---	---	---

DATABLE MATERIALS

CONTAMINATION RISK

1	2	3	4	5
---	---	---	---	---

COMMENTS/OBSERVATIONS:

ENTERED INTO DATABASE

INITIALS: CC

DATE: 21-7-17