

SITE CODE: <b>MZ</b>	DATE OPENED: 19 JULY 2017	SU No: 17103 NE	MARZUOLO ARCHAEOLOGICAL PROJECT <b>MANN</b>
	DATE CLOSED: 20 JULY 2017 INITIAL: WL	AREA No: 17000	

FORMATION PROCESS: ANTHROPIC <input checked="" type="checkbox"/> NATURAL <input type="checkbox"/>	DEFINITION: INTERFACE OVER CHOCOLATE
	SU TYPE: <input checked="" type="checkbox"/> DEPOSIT <input type="checkbox"/> CUT <input type="checkbox"/> STRUCTURAL
DISTINGUISHED BY: <input checked="" type="checkbox"/> COLOR <input checked="" type="checkbox"/> COMPACTION <input checked="" type="checkbox"/> COMPOSITION	

I DEPOSIT: 1. Colour 2. Compaction 3. Composition 4. Inclusions (freq/med/rare) 5. Dimensions/Shape 6. Clarity of Limits (clear/not clear) 7. Fill of 8. Method & Conditions	STRUCTURAL: 1. Type (wall, cistern, etc.) 2. Technique (pisé, ashlar, etc.) 3. # of Coursings 4. Bonding Material 5. Facing/Finish (plaster, etc.) 6. Orientation 7. Dimensions 8. Abuts/butted by 9. Related architectural features	DESCRIPTION: 1. BROWN + GREY 2. MODERATELY DENSE 3. SILTY CLAY 4. RARE STONE, CERAMICS 5. EXTENT OF EXC LIMIT 0.5M x 2M 6. N & W clear; E & S trench limit 7. N/A 8. SUNNY, PICK TROWEL

II INTERPRETATION/DISCUSSION:  
 THIS SOIL IS VERY SIMILAR TO THE SOIL IN 17099, BUT WITH LESS INCLUSIONS AND IT NO LONGER ABUTS THE WALL 17020 BUT ITS FOUNDATION, 17106. THIS LEVEL ALSO REVEALED THE FOUNDATION OF 17016 (17110) BENEATH THIS IS THE CHOCOLATE LAYER, SO PERHAPS THIS WAS A TYPE OF INTERFACE LAYER BETWEEN THE OCCUPATION AND THE CHOCOLATE

M MATRIX:	<input type="checkbox"/>	<input type="checkbox"/>	17099	<input type="checkbox"/>	<input type="checkbox"/>
			17103	This context	
	17106	17104	17110		

ST STRATIGRAPHIC RELATIONSHIPS:	FILLS:
CUT:	BUTTED BY:
CUT BY:	FILLED BY:
ABUTS: 17106, 17110	COVERS: 17104
	EQUAL TO:
	COVERED BY: 17099
	BINDS TO:

E ENVIRONMENTAL SAMPLES: <input type="checkbox"/> POLLEN <input type="checkbox"/> SOIL <input type="checkbox"/> CHARCOAL <input type="checkbox"/> OTHER (specify):
N/A

SPECIAL FINDS N <sup>o</sup> s:		FINDS TYPE: NONE <input type="checkbox"/> POTTERY <input checked="" type="checkbox"/> BRICK/TILE <input checked="" type="checkbox"/> METAL <input type="checkbox"/>		SLAG <input type="checkbox"/> GLASS <input type="checkbox"/> BONE <input type="checkbox"/> LEATHER <input type="checkbox"/> MORTAR <input type="checkbox"/>	DAUB <input type="checkbox"/> WRKD WOOD <input type="checkbox"/> WRKD STONE <input type="checkbox"/> OTHER (specify):
---------------------------------	--	---	--	---	--

PHOTO N <sup>o</sup> s	101-727	PHOTO MODEL N <sup>o</sup> s	
------------------------	---------	------------------------------	--

SKETCH OF PLAN **INCLUDE:** 1. North Arrow; 2. Dimensions; 3. Sample Locations (if relevant); 4. Levels; 5. Grid Pts (if relevant); 6. Rise/Drop in Surface Level; 7. Abutting Architecture/Adjacent or Relevant Nearby Features for Reference; 8. All SU N<sup>o</sup>s

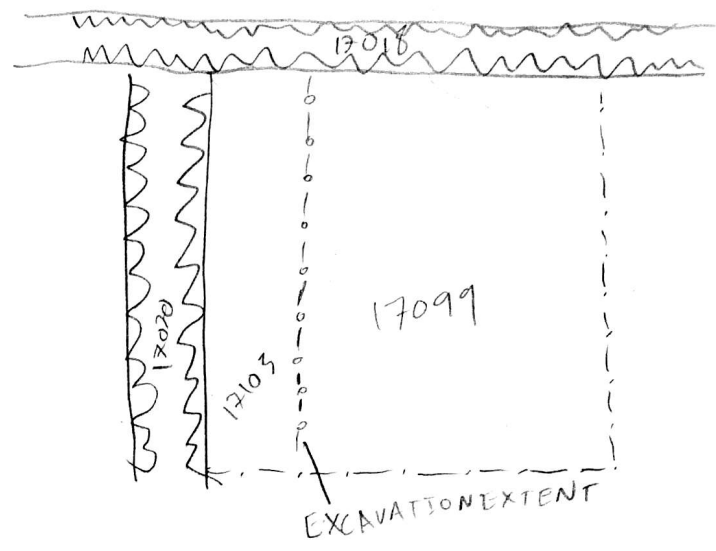

FIELD NOTEBOOK DRAWINGS - PAGE N <sup>o</sup> s		PROFILE DRAWING N <sup>o</sup> s	
STRATIGRAPHIC RELIABILITY	LOW	HIGH	APPROX. DATE OF LAYER
	1 2 3 4 5	1 2 3 4 5	
CONFIDENCE IN INTERPRETATION	1 2 3 4 5		DATABLE MATERIALS
CONTAMINATION RISK	1 2 3 4 5		

COMMENTS/OBSERVATIONS:  
 SIMILAR TO ABOVE LAYER IN COLOR & COMPACTION. FEWER MATERIALS THAN 17099 ABUTS FOUNDATIONS OF BOTH 17020 + 17018

ENTERED INTO DATABASE	INITIALS: JK	DATE: 27 July
-----------------------	--------------	---------------