



**MARZUOLO
ARCHAEOLOGICAL
PROJECT** MANNE

SITE CODE:
MZ

DATE OPENED: 20 July
DATE CLOSED: 20 July
INITIAL: TK

SU N°: 17109
AREA N°: 17000

FORMATION PROCESS:
ANTHROPIC NATURAL

DEFINITION: cut with fill 17087
SU TYPE: DEPOSIT CUT STRUCTURAL
DISTINGUISHED BY: COLOR COMPACTION COMPOSITION

DEPOSIT:
1. Colour
2. Compaction
3. Composition
4. Inclusions (freq/med/rare)
5. Dimensions/Shape
6. Clarity of Limits (clear/not clear)
7. Fill of
8. Method & Conditions

STRUCTURAL:
1. Type (wall, cistern, etc.)
2. Technique (pisé, ashlar, etc.)
3. # of Coursings
4. Bonding Material
5. Facing/Finish (plaster, etc.)
6. Orientation
7. Dimensions
8. Abuts/butted by
9. Related architectural features

DESCRIPTION:
1. Roughly rectangular
2. } consistent with 4, no change
3. }
4. Straight against wall 17012 and on its western edge, 45° angle at south edge. North continues to limit of trench.
5. N-S
6. Roughly 130 x 85cm
7. 17087

INTERPRETATION/DISCUSSION:
Cut for fill of orange clayish soil 17087 roughly lined with stones and tile, particular at lowest level and western edge.
- cut into collapse associated w/ FIRE EVENT; part of re-use phase of area

MATRIX:
17087
17109 This context
17040

STRATIGRAPHIC RELATIONSHIPS:

CUT: 17040	BUTTED BY:	FILLS:
CUT BY:	COVERS:	FILLED BY: 17087
ABUTS:	COVERED BY:	EQUAL TO:
		BINDS TO:

ENVIRONMENTAL SAMPLES: POLLEN SOIL CHARCOAL OTHER (specify):
N/A

SPECIAL FINDS N^{os}:

FINDS TYPE:
 NONE
 POTTERY
 BRICK/TILE
 METAL

SLAG
 GLASS
 BONE
 LEATHER
 MORTAR

DAUB
 WRKD WOOD
 WRKD STONE
 OTHER (specify):

PHOTO N^{os} 17 101-7255 - 7260
 101-7256
 -7259

PHOTO MODEL N^{os}

SKETCH OF PLAN INCLUDE: 1. North Arrow; 2. Dimensions; 3. Sample Locations (if relevant); 4. Levels; 5. Grid Pts (if relevant); 6. Rise/Drop in Surface Level; 7. Abutting Architecture/Adjacent or Relevant Nearby Features for Reference; 8. All SU N^{os}

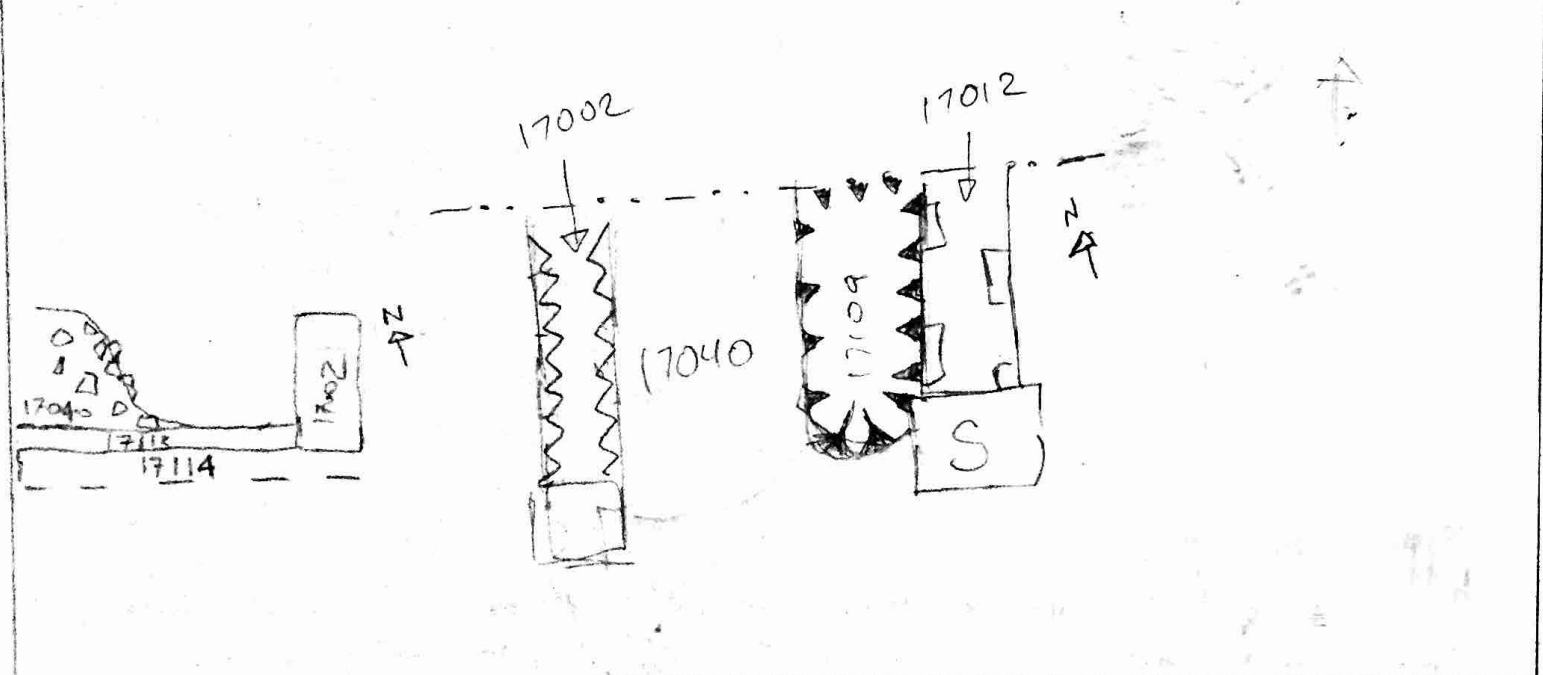

FIELD NOTEBOOK DRAWINGS - PAGE N^{os}	p. 73	PROFILE DRAWING N^{os}	
STRATIGRAPHIC RELIABILITY	LOW 1 2 3 4 5	APROX. DATE OF LAYER	
CONFIDENCE IN INTERPRETATION	1 2 3 4 5	DATABLE MATERIALS	
CONTAMINATION RISK	1 2 3 4 5		

COMMENTS/OBSERVATIONS:
 Base a mix of charcoal/greenish clay under stones/tiles, some heavy charcoal patches extending out from western face.

ENTERED INTO DATABASE INITIALS: CJ
 AR

DATE: 21-7-17
 22 July